



161 Alden Road, Units 7 & 8, Markham, Ontario Canada L3R 3W7
 Tel: +1 416 754-3322 Fax: +1 416-754-3299
 Email: info@edac.net http://www.edac.net
ENGINEERING CHANGE NOTICE

Originator:	Yu Zhang	Date:	May 17, 2018	Document Number:	ECN20180503-00
Phone No.:	(416) 754-3322 ext.234	Revision Number:	2	SHEET:	1 of 5
Email Address:	yzhang@edac.net				
Department:	ENGINEERING				

CHANGE TYPE

- CLASS I Customer notification and approval required prior to implementation
- CLASS II Customer notification only, no approval required
- CLASS III No customer notification required

REASON OF CHANGE

Discontinuance / End of Life of 690-024-260-900, 690-024-360-900, 690-024-660-900, 690-024-294-031, 690-024-394-031, 690-024-694-031.

DESCRIPTION OF CHANGE:

1

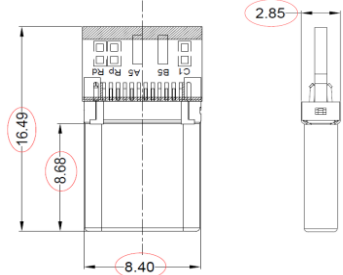
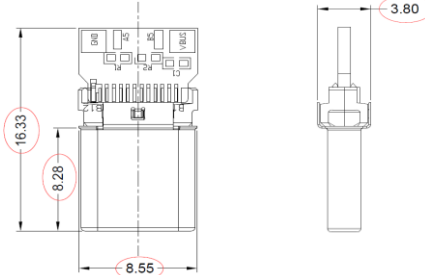
<p>Part No. 690-024-260-900 (Obsolete) 690-024-360-900 (Obsolete) 690-024-660-900 (Obsolete)</p> 	Replaced by	<p>Part No. 690-024-260-432 690-024-360-432 690-024-660-432</p> 
---	-------------	---

2

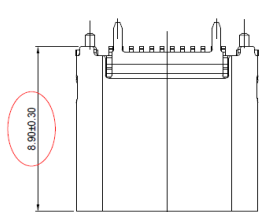
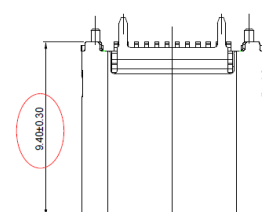
<p>Part No. 690-024-294-031 (Obsolete) 690-024-394-031 (Obsolete) 690-024-694-031 (Obsolete)</p> 	Replaced by	<p>Part No. 690-024-294T331 690-024-394T331 690-024-694T331</p> 
--	-------------	--

3. Effective implementation to distribution is on **May 17th, 2018**

PARTIES AFFECTED

- | | | |
|--|---|---|
| <input checked="" type="checkbox"/> Customer | <input type="checkbox"/> NORCOMP | <input checked="" type="checkbox"/> ECA |
| <input checked="" type="checkbox"/> Distributors | <input type="checkbox"/> MH | <input checked="" type="checkbox"/> EDG |
| <input type="checkbox"/> Suppliers | <input checked="" type="checkbox"/> ETW | <input checked="" type="checkbox"/> EDAC UK |

KEY TARGET DUE DATES IF CHANGE IS APPROVED TO PROCEED (check if applicable and show target dates as known)

- | | |
|--|--|
| <input type="checkbox"/> Submit Quote _____ | <input type="checkbox"/> PPAP from Supplier _____ |
| <input type="checkbox"/> Prod. Trial Run _____ | <input type="checkbox"/> MRD of Production Parts _____ |
| <input type="checkbox"/> Run at Rate _____ | |

ACKNOWLEDGEMENT FOR ECN INITIATION: (OPTIONALS)		STATUS
<input type="checkbox"/> Tooling Rep _____ <input type="checkbox"/> Mfg Eng Rep _____ <input type="checkbox"/> Production Rep _____ <input type="checkbox"/> Materials Rep _____ <input type="checkbox"/> Quality Rep _____	<input type="checkbox"/> Process Eng Rep _____ <input type="checkbox"/> Facilities Rep _____ <input type="checkbox"/> Sales Rep. _____ <input type="checkbox"/> Product Eng. Rep. _____ <input type="checkbox"/> Purchasing Rep _____	APPROVED <input type="checkbox"/> CCS CHANGE REQUEST #
APPROVALS FOR ECN INITIATION (REQUIRED)		REJECTED
<input type="checkbox"/> President _____ <input type="checkbox"/> Vice President Bob Sakitkovski	<input checked="" type="checkbox"/> Engineering Manager Ronnie Sta. Monica <input checked="" type="checkbox"/> Mechanical Engineer Yu Zhang	<input type="checkbox"/> Change REJECTED by: Rejected Date:
MINIMUM OF TWO SIGNATURES REQUIRED		

THIS IS A C.A.D. GENERATED DRAWING
DO NOT MAKE MANUAL REVISIONS TO MASTER.

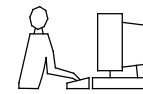

TOLERANCE UNLESS OTHERWISE SPECIFIED	
.X	±0.50
.X	±0.30
.XX	±0.20
.XXX	±0.10

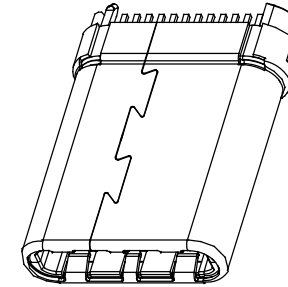
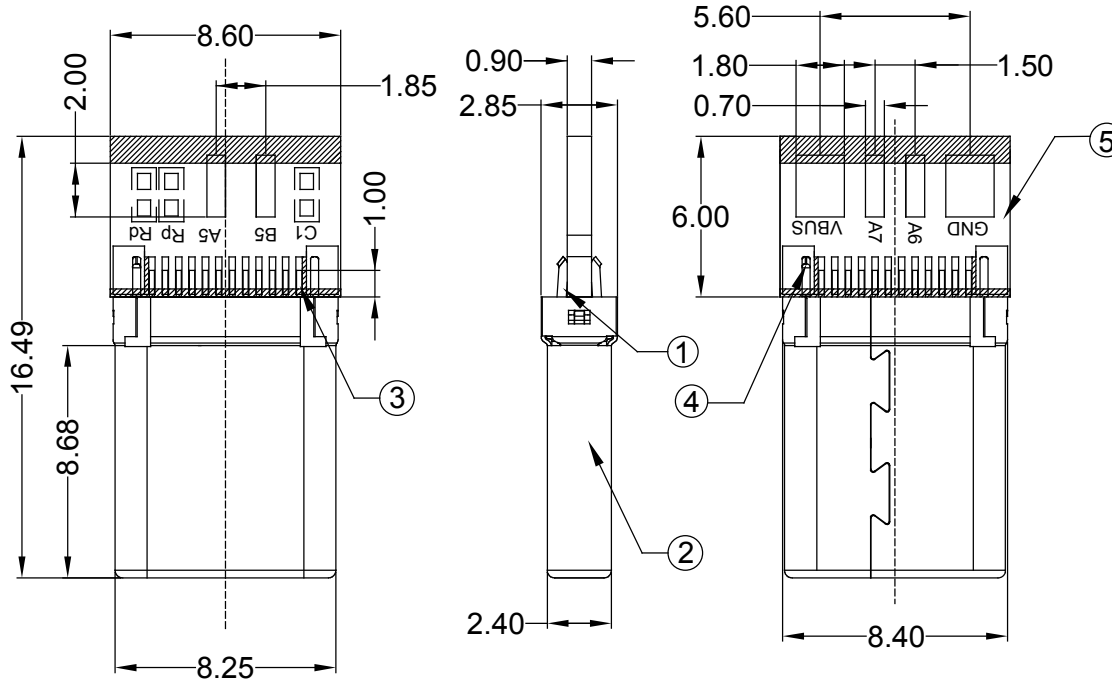
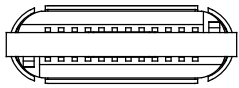

NOTES:

- CURRENT RATING: 3A
- CONTACT RESISTANCE: 40mΩ MAX.
- INSULATOR RESISTANCE: 100MΩ min. AT 100V DC
- SOLDERABILITY: 250±5°C, 5±0.5s
- TOTAL MATING FORCE: 2.04kgf (20N) MAX.
- TOTAL UNMATING FORCE: 0.81kgf (8N), 2.04kgf(20N) MAX.
- MATING CYCLE: 10000 CYCLES min.

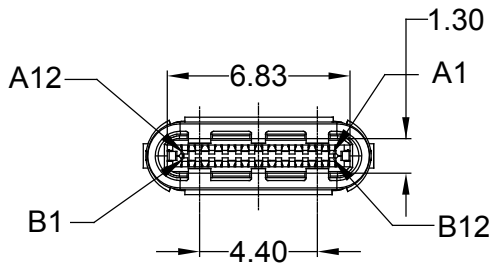

PART NUMBER	CONTACT PLATING
690-024-260-432	GOLD FLASH PLATING
690-024-360-432	15u" GOLD PLATING
690-024-660-432	30u" GOLD PLATING

USB 3.1, TYPE C, VERTICAL, MALE

ACAD REFERENCE NO.: 690-024-X60-432

DRAWN: Y.Z DATE: MAY.07/2018

CHECKED: DATE:

SCALE: (IN C.A.D. 1:1) SHEET 1 OF 2

DRAWING NUMBER: 690-024-X60-432

ISSUE

PART NUMBER: SEE TABLE

1



THIS SERIES FULLY CONFORMS TO
THE EUROPEAN UNION DIRECTIVES
2011/65/EU FOR RoHS COMPLIANCY.



EDAC INC
TORONTO, ONTARIO
CANADA
YOUR CONNECTION TO QUALITY & SERVICE

THESE DRAWINGS AND SPECIFICATIONS
ARE THE PROPERTY OF EDAC INC., AND
SHALL NOT BE REPRODUCED, OR COPIED
OR USED AS THE BASIS FOR THE
MANUFACTURE OR SALE OF APPARATUS
WITHOUT WRITTEN PERMISSION.

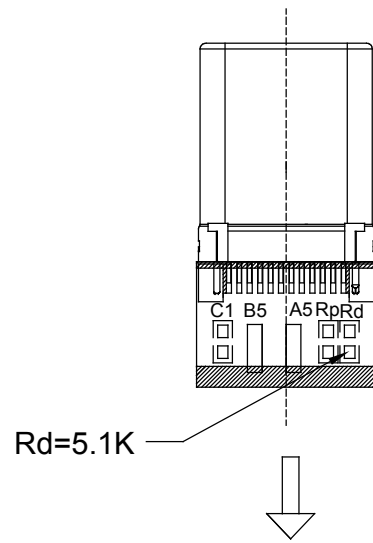
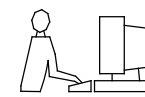

PIN ASSIGNMENT

5	PCB	1	----
4	GND LATCH	1	STAINLESS STEEL, NICKEL PLATING OVERALL, TABE WITH LEAD FREE TIN ALLOY
3	CONTACT	24	COPPER ALLOY NICKEL UNDERPLATING OVERALL, GOLD PLATING AT CONTACT AREA. LEAD FREE TIN ALLOY AT TERMINATION.
2	SHELL	1	STAINLESS STEEL
1	HOUSING	2	LCP, BLACK, UL 94V-0
No.	DESCRIPTION	QTY	MATERIAL & PLATING

CONN 1

CONN 2

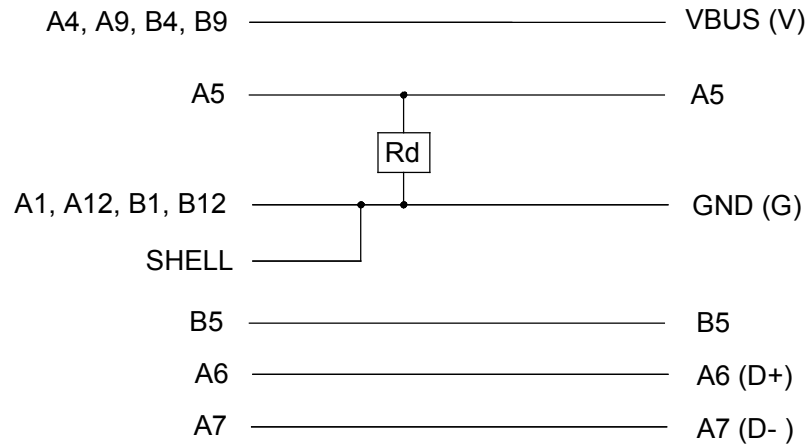

A12	A11	A10	A9	A8	A7	A6	A5	A4	A3	A2	A1
GND	RX2+	RX2-	Vbus	SBU1	D-	D+	CC	Vbus	TX1-	TX1+	GND
GND	TX2+	TX2-	Vbus	Vconn			SBU2	Vbus	RX1-	RX1+	GND
B1	B2	B3	B4	B5	B6	B7	B8	B9	B10	B11	B12

USB 3.1 TYPE C, VERTICAL, MALE

ACAD REFERENCE NO.: 690-024-X60-432

DRAWN: Y.Z

DATE: MAY.07/2018

CHECKED:

DATE:

SCALE: (IN C.A.D. 1:1)

SHEET 2 OF 2

DRAWING NUMBER: 690-024-X60-432

ISSUE

PART NUMBER: SEE TABLE

1



THIS SERIES FULLY CONFORMS TO THE EUROPEAN UNION DIRECTIVES 2011/65/EU FOR RoHS COMPLIANCY.



EDAC INC
TORONTO, ONTARIO
CANADA
YOUR CONNECTION TO QUALITY & SERVICE

THESE DRAWINGS AND SPECIFICATIONS ARE THE PROPERTY OF EDAC INC., AND SHALL NOT BE REPRODUCED, OR COPIED OR USED AS THE BASIS FOR THE MANUFACTURE OR SALE OF APPARATUS WITHOUT WRITTEN PERMISSION.

THIS IS A C.A.D. GENERATED DRAWING
DO NOT MAKE MANUAL REVISIONS TO MASTER.



TOLERANCE UNLESS OTHERWISE SPECIFIED	
X.	±0.50
X.X	±0.30
X.XX	±0.20
X.XXX	±0.10

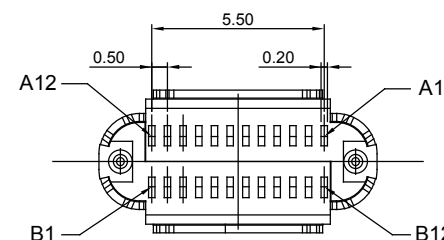
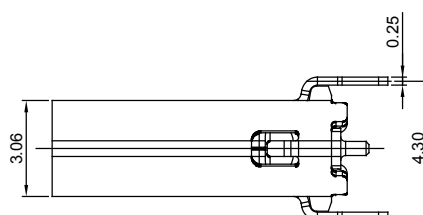
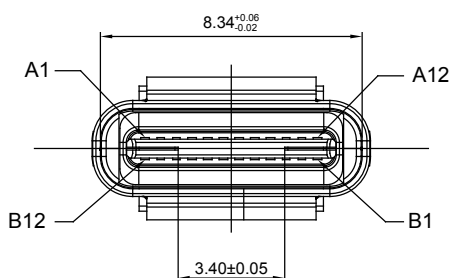
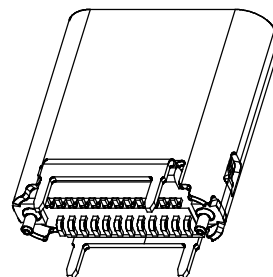
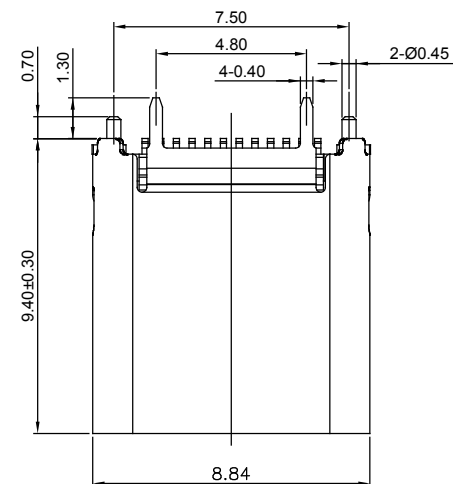

NOTES:

- INSULATOR: HIGH TEMPERATURE PLASTIC, UL 94 V-0, BLACK COLOR
- CONTACT: COPPER ALLOY, T=0.15mm
SELECTIVE GOLD PLATING ALL OVER 50u" Min NICKEL
80u" min. MATTE TIN ALL OVER 50u" Min. NICKEL ON SOLDER AREA
- SHELL: STAINLESS STEEL, T=0.20mm
50u" min. NICKEL ALL OVER
- CONTACT RESISTANCE: 40mΩ Max. FOR INITIAL. 10mΩ CHANGE AFTER TEST.
MEASURE AT 20mV, 100mA.
- CONTACT CURRENT RATING: 5A FOR VBUS PIN; 1.25A FOR VCONN PIN.
- DIELECTRIC WITHSTANDING VOLTAGE: 100V AC R.M.S.
- INSULATION RESISTANCE: 100MΩ Min.
- OPERATING TEMPERATURE: -40°C ~ 85°C
- MATING FORCE: 5~20 N.
- UNMATING FORCE: 6~20N AFTER TEST.

PART NUMBER	CONTACT PLATING
690-024-294T331	GOLD FLASH PLATING
690-024-394T331	15u" GOLD PLATING
690-024-694T331	30u" GOLD PLATING

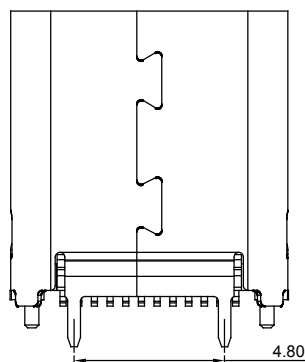

USB 3.1, TYPE C, FEMALE, VERTICAL, SMT

ACAD REFERENCE NO.: 690-024-X94T331

DRAWN: Y.Z DATE: MAY.01/2018

CHECKED: DATE:

SCALE: (IN C.A.D. 1:1) SHEET 1 OF 2

DRAWING NUMBER: 690-024-X94T331

ISSUE

PART NUMBER: SEE TABLE

1



THIS SERIES FULLY CONFORMS TO
THE EUROPEAN UNION DIRECTIVES
2011/65/EU FOR RoHS COMPLIANCY.



EDAC INC
TORONTO, ONTARIO
CANADA
YOUR CONNECTION TO QUALITY & SERVICE

THESE DRAWINGS AND SPECIFICATIONS
ARE THE PROPERTY OF EDAC INC., AND
SHALL NOT BE REPRODUCED, OR COPIED
OR USED AS THE BASIS FOR THE
MANUFACTURE OR SALE OF APPARATUS
WITHOUT WRITTEN PERMISSION.

THIS IS A C.A.D. GENERATED DRAWING
DO NOT MAKE MANUAL REVISIONS TO MASTER.

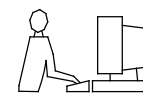

TOLERANCE UNLESS OTHERWISE SPECIFIED	
X.	±0.50
X.X	±0.30
X.XX	±0.20
X.XXX	±0.10

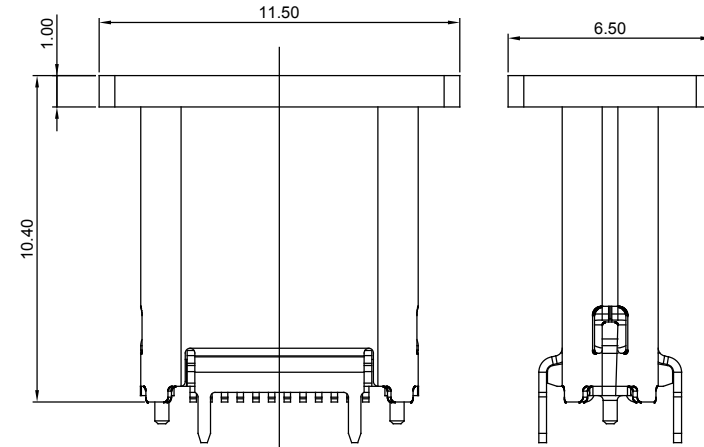
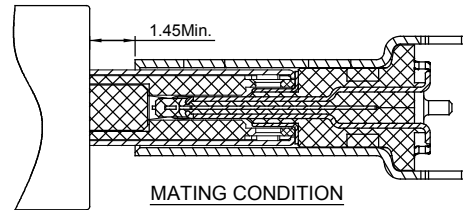
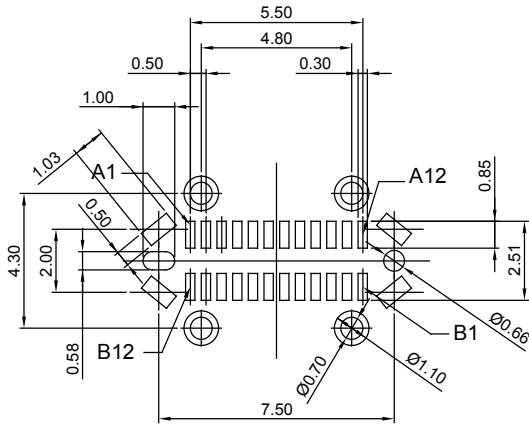

RECOMMEND P.C.B LAYOUT (COMPONENT SIDE)

TOLERANCE FOR PCB LAYOUT IS ± 0.05
KEEP OUT AREA

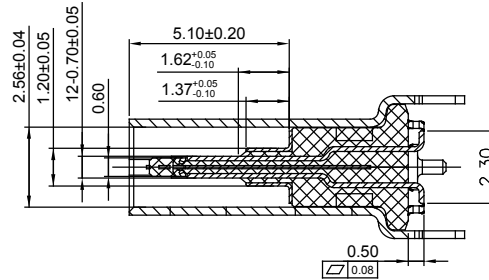
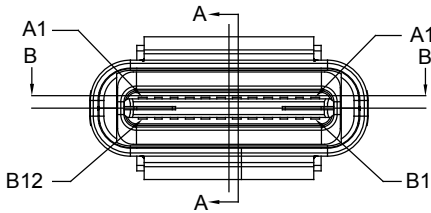

SECTION A-A

INCLUDE THE DIAGRAMS OF CAP

PIN	SIGNAL NAME	MATING SEQUENCE	PIN	SIGNAL NAME	MATING SEQUENCE
A1	GND	FIRST	B12	GND	FIRST
A2	SSTXp1	SECOND	B11	SSRXp1	SECOND
A3	SSTXn1	SECOND	B10	SSRXn1	SECOND
A4	V _{BUS}	FIRST	B9	V _{BUS}	FIRST
A5	CC1	SECOND	B8	SBU2	SECOND
A6	Dp1	SECOND	B7	Dn2	SECOND
A7	Dn1	SECOND	B6	Dp2	SECOND
A8	SBU1	SECOND	B5	CC2	SECOND
A9	V _{BUS}	FIRST	B4	V _{BUS}	FIRST
A10	SSRXn2	SECOND	B3	SSTXn2	SECOND
A11	SSRXp2	SECOND	B2	SSTXp2	SECOND
A12	GND	FIRST	B1	GND	FIRST
SHELL		GND	SHELL		GND

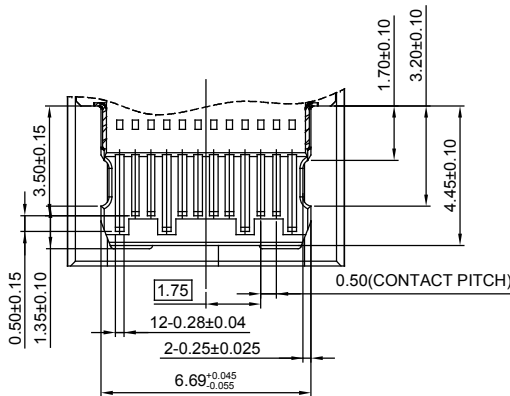

SECTION B-B

USB 3.1, TYPE C, FEMALE, VERTICAL, SMT

ACAD REFERENCE NO.: 690-024-X94T331

DRAWN: Y.Z DATE: MAY.01/2018

CHECKED: DATE:

SCALE: (IN C.A.D. 1:1) SHEET 2 OF 2

DRAWING NUMBER: 690-024-X94T331

ISSUE

PART NUMBER: SEE TABLE

1



THIS SERIES FULLY CONFORMS TO THE EUROPEAN UNION DIRECTIVES 2011/65/EU FOR RoHS COMPLIANCE.



EDAC INC
TORONTO, ONTARIO
CANADA

YOUR CONNECTION TO QUALITY & SERVICE

THESE DRAWINGS AND SPECIFICATIONS ARE THE PROPERTY OF EDAC INC., AND SHALL NOT BE REPRODUCED, OR COPIED OR USED AS THE BASIS FOR THE MANUFACTURE OR SALE OF APPARATUS WITHOUT WRITTEN PERMISSION.