

P.C. MOUNTING

SWITCH FUNCTION	
POS. 1	POS. 2 POS. 3
ON	OFF ON
2-1, 5-4	OPEN 2-3, 5-6

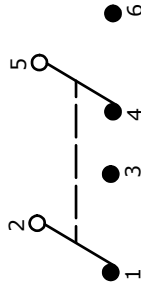

- NOTE:
- ALL DIMENSIONS IN MM [INCH]
 - GENERAL TOLERANCE: X.X=±0.4
X.XX=±0.25
 - TERMINAL NUMBERS FOR REF ONLY
 - PLATING MATERIAL: SILVER
 - CONTACT RATING: 2A @ 250VAC
5A @ 120VAC OR 28VDC
 - ELECTRIC LIFE: 30,000 ACTUATIONS AT FULL LOAD.
 - INSULATION RESISTANCE: 1,000 MEGA-OHM MIN.
 - DIELECTRIC STRENGTH: 1,000 V RMS @SEA LEVEL.
 - OPERATING TEMP.: -30°C to 85°C
 - ▲ DENOTES CRITICAL PARAMETER.
 - 2002/95/EC (ROHS) COMPLIANT
 - CONTACT RESISTANCE: 10 mΩ OHM MAX. INITIAL @ 2-4 VDC
100mA FOR BOTH SILVER AND GOLD PLATING

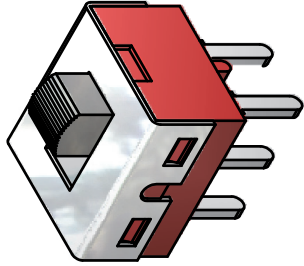
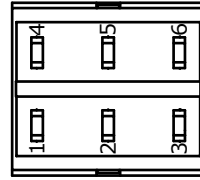
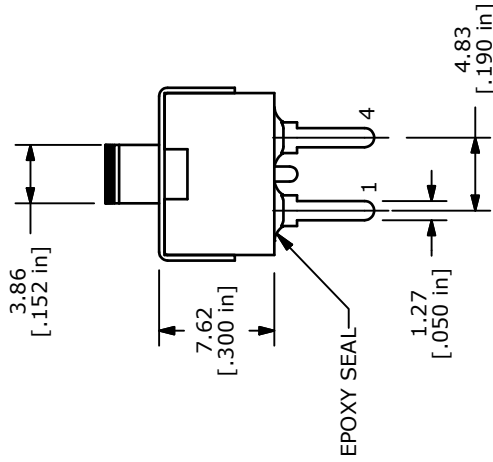
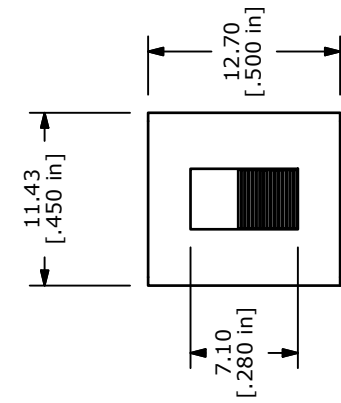

ISOMETRIC

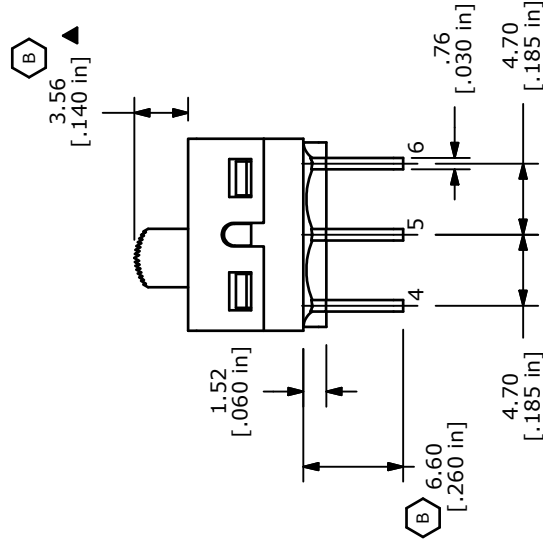

E-SWITCH®

TITLE 500SDP3S4M2QEA

SCALE 2:1

DATE 4/3/2006

DR PH

DWG T523004

REV B

B	19565	DRAWING UPDATE	1/6/11	BGL
A	15923	RELEASED FOR PRODUCTION	4/3/06	PH
REV	PCR NO	DESCRIPTION	DATE	BY

THE INFORMATION CONTAINED IN THIS DOCUMENT IS PROPRIETARY TO E-SWITCH AND IS NOT TO BE COPIED OR TRANSFERRED