

THIS DOCUMENT IS SUBJECT TO CHANGE WITHOUT NOTICE. IT IS CONFIDENTIAL AND A PROPERTY OF Amphenol LTW. DISCLOSURE TO THIRD PARTY HAS TO BE AUTHORIZED BY Amphenol LTW.

REV.	ECN NO.	DATE	SIGN	DESCRIPTION

ALTW
CONFIDENTIAL
 2012-04-11
R&D DEPT.

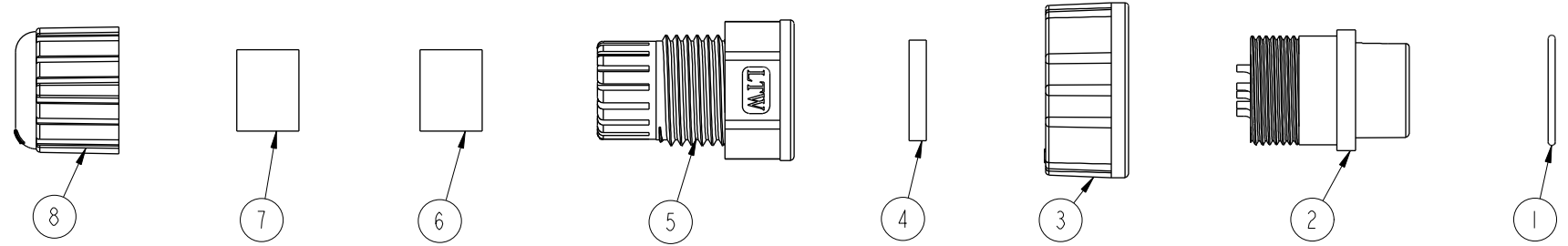

ALTW
DCC. DEPT.
CONFIDENTIAL
 2012-05-21
ISSUED

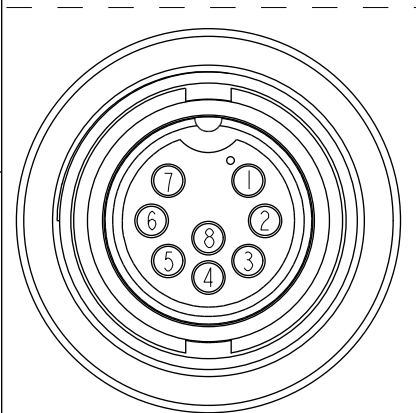

Pin Assignments
Front View

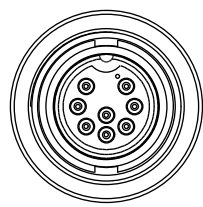
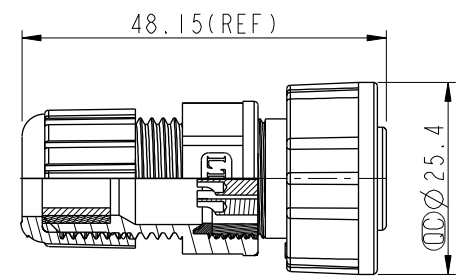

Conn.

Note:

- * \varnothing Important Dimensions To Check.
- * Waterproof Rate: IP67
- * Housing: Nylon+GF, Black
- * Male Pin: Copper Alloy, Gold Plated
- * O-Ring: EPDM, Black
- * Screw Nut: Nylon+GF, Black
- * Gasket: EPDM, Black
- * Clamp Ring: Nylon, Black
- * Sealing Nut: Nylon, Black
- * Seals B1 for Cable OD: $\varnothing 7.6\text{mm} \sim \varnothing 9.6\text{mm}$
- * Seals B2 for Cable OD: $\varnothing 4.0\text{mm} \sim \varnothing 7.6\text{mm}$
- * One Set Unassembled in One PE Bag.

UNIT:mm		TITLE		ITEM NO.		DRAWN BY		DATE
		Middle, Assy Screw 8Pin F Conn M Pin		CD-08BFMA-SL7001		SamChang		2012-04-11
TOLERANCE		SCALE	SIZE	SHEET	DWG NO.	CHECKED BY	DATE	
.X ±0.25		1:1	A4	1	CD-08BFMA-SL7001	Jeffrey	2012-05-21	
.XX ±0.1	REV.	WC-REV.	SHEET OF		CUSTOMER	APPROVED BY	DATE	
.XXX ±0.05	A	A.2	1		ALTW	Lion	2012-05-21	
ANGLES ±1°	\varnothing : Inspection item		Amphenol LTW					
			安費諾亮泰企業股份有限公司					