

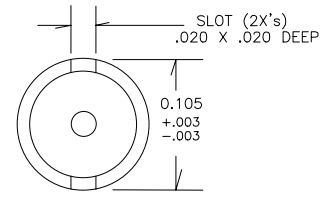

B2C502B  
 2-56 THREAD NON-HERMETIC  
 5,000pF Cap. FEED-THRU

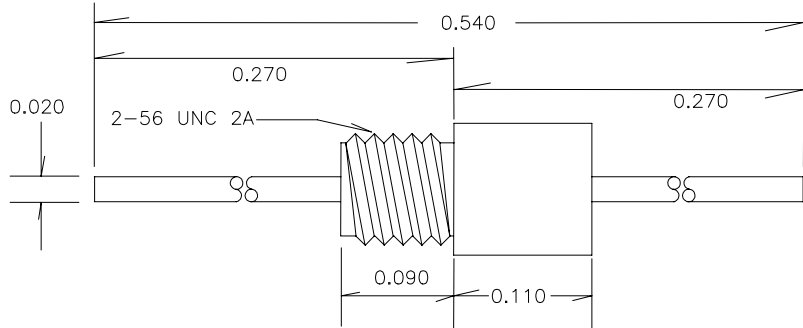
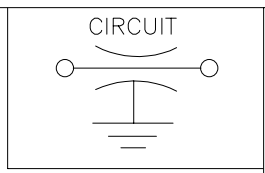

\* RoHS Compliant  
 \* Discoidal Capacitor Construction

PART NUMBER	EMI P/N	CAP. (pF)	COLOR DOT(S)*	MAX. WVDC	DC AMPS	MINIMUM NO LOAD INSERTION LOSS				
						1 MHz	10 MHz	100 MHz	1 GHz	10 GHz
B3C502B		5,000	YELLOW	100	5	5	15	30	45	55

ELECTRICAL

CAPACITANCE TOLERANCE: +100/-0%  
 DISSIPATION FACTOR: 3.5% MAX.  
 INSULATION RESISTANCE:  
 25° C=10,000 Mohm Min.  
 125° C=1,000 Mohm Min.  
 DIELECTRIC STRENGTH (DWV):  
 250% of WVDC (5 seconds)  
 TEMPERATURE CHARACTERISTIC:  
 X7R or better

PHYSICAL

DIMENSION TOLERANCE:  
 CASE LENGTH: +/- .005" (.123mm)  
 LEAD LENGTH: +/- .030" (.762mm)  
 LEAD DIAMETER: +/- .002" (.051mm)  
 MATERIAL AND FINISH:  
 CASE: Brass CASE FINISH: Gold  
 LEAD: Brass, 3/4 Hard  
 LEAD FINISH: Gold, Suitable For Wire Bond  
 Per MIL-G-45204, Type III, Grade A, Class 1

IDENTIFICATION & LIMITS

\*MARKING:  
 NO MARKING STANDARD.  
 Color dot marking option available.  
 OPERATING TEMP: -55° C to +125° C  
 INSTALLATION TEMP: N/A  
 MAXIMUM MOUNTING TORQUE: 1.0 in\*lbs

\*NOTE\*  
 For a .024" diameter lead, append "24" to the end of the EMI P/N.

EMI Filter Company  
 12750 59th Way N.  
 Clearwater, FL  
 33760  
 (727) 585-7990  
 (727) 586-5138 Fax  
 www.emifiltercompany.com

FILTER, EMI, MINIATURE,  
 2-56 THREADED BODY

FSCM NO.	DWG NO. B2C502B REVD	REV D
----------	-------------------------	----------

