

4000012329

3 CIRCUIT CONNECTOR SHOWN

CKT	A	B
2	10.1	5.0
3	15.1	10.0
4	20.1	15.0
5	25.1	20.0
6	30.1	25.0
7	35.1	30.0
8	40.1	35.0

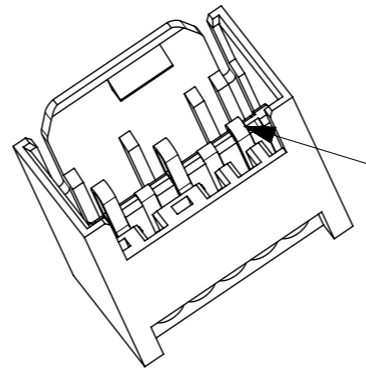
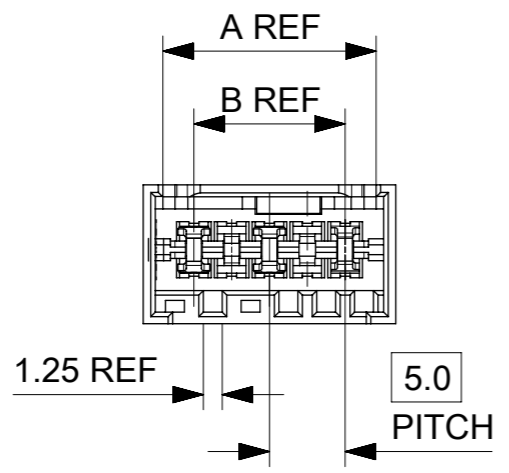
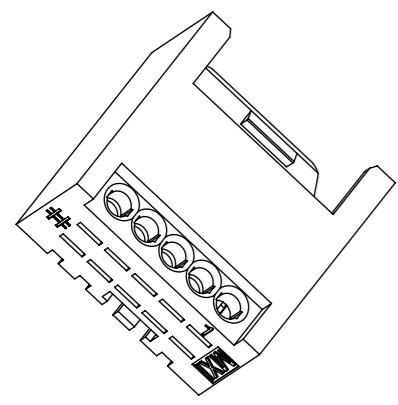

CIRCUIT 1
NOTE 6

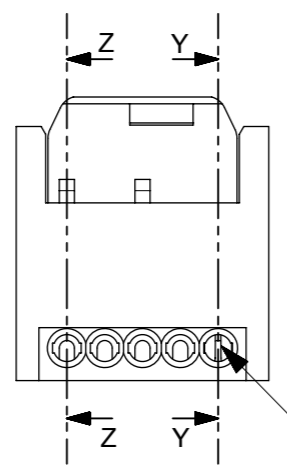
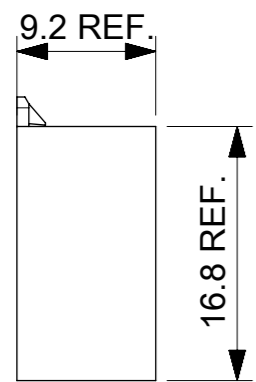

CIRCUIT 1
NOTE 6

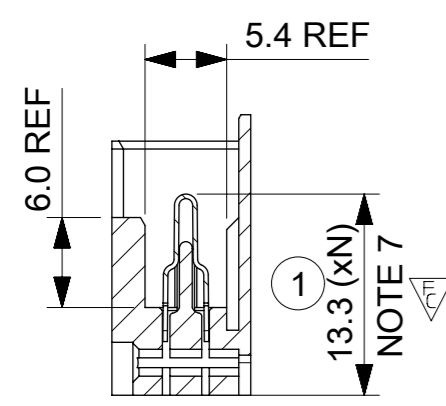
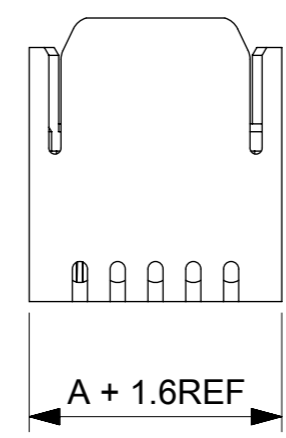
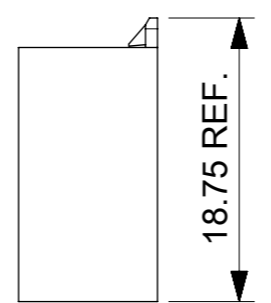

SECTION Z-Z

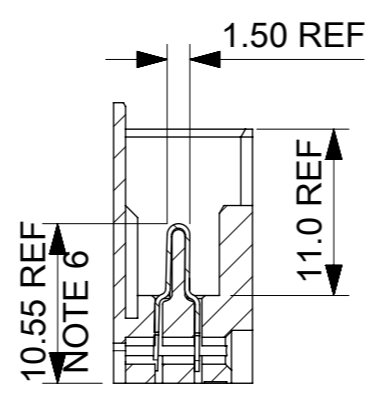

SECTION Y-Y

- NOTES:
- MATERIALS
HOUSING: POLYAMIDE 6 (PA6)
UL94-V2. COLOUR NATURAL
TERMINAL: COPPER ALLOY
PLATING: PRE PLATED HOT TIN DIP
 - PRODUCT CONFORMS TO SPECIFICATION PS-99020-0090.
 - MATES WITH RAST 2.5 APPLIMATE FEMALE CONNS.
 - SEE PACKAGING PK-93422-001
 - CONNECTOR DESIGNED FOR USE WITH PANEL 0.80MM TO 0.90MM THICKNESS.
 - TERMINATED HEIGHT. CIRCUIT 1 SHOWN IN TERMINATED POSITION ONLY FOR PURPOSE OF DIMENSIONING TERMINATED HEIGHT POSITION.
 - TERMINAL PRE-TERMINATED HEIGHT. N=NUMBER OF CIRCUITS.
 - SEE APPLICATION SPEC AS-99033-010.
 - CONNECTOR DESIGNED TO RAST 2.5 STANDARD.

LAST INSPECTION NUMBER: 1

THIS DRAWING CONTAINS INFORMATION THAT IS PROPRIETARY TO MOLEX ELECTRONIC TECHNOLOGIES, LLC AND SHOULD NOT BE USED WITHOUT WRITTEN PERMISSION		CURRENT REV DESC: DOC TYPE UPDATED		molex	
DIMENSION UNITS	SCALE	EC NO: 608137			
mm	2:1	DRWN: AKABADI 2018/11/23		FLYING HEADER 5MM PITCH 0.22-0.38MM ² CABLE	
GENERAL TOLERANCES (UNLESS SPECIFIED)		CHK'D: TCLEARY 2018/12/10		PRODUCT CUSTOMER DRAWING	
ANGULAR TOL	± 0.5°	APPR: DRYAN 2018/12/11		DOCUMENT NUMBER	
4 PLACES	±	INITIAL REVISION:		934250001	
3 PLACES	±	DRWN: TJMURPHY 2016/03/21		DOC TYPE	
2 PLACES	± 0.05	APPR: BRUTTLE 2016/06/13		PSD	
1 PLACE	± 0.1	MATERIAL NUMBER		000	
0 PLACES	±	CUSTOMER		D	
DRAFT WHERE APPLICABLE MUST REMAIN WITHIN DIMENSIONS		THIRD ANGLE PROJECTION	DRAWING	SERIES	SHEET NUMBER
			A3-SIZE	93425	1 OF 2

DOCUMENT STATUS	P1	RELEASE DATE	2018/12/11	17:38:17
-----------------	----	--------------	------------	----------

2 Circuit			
MOLEX PART NO.	MOLEX HSG PART NO.	BLOCKED POSITION KEYS	CONFIGURATION (SEE NOTES)
93425-0001	93429-0301	NONE	
93425-0008	93429-0302	c d	

5 Circuit			
MOLEX PART NO.	MOLEX HSG PART NO.	BLOCKED POSITION KEYS	CONFIGURATION (SEE NOTES)
93425-3001	93429-0901	NONE	

8 Circuit			
MOLEX PART NO.	MOLEX HSG PART NO.	BLOCKED POSITION KEYS	CONFIGURATION (SEE NOTES)
93425-6001	93429-1501	NONE	

3 Circuit			
MOLEX PART NO.	MOLEX HSG PART NO.	BLOCKED POSITION KEYS	CONFIGURATION (SEE NOTES)
93425-1001	93429-0501	NONE	

6 Circuit			
MOLEX PART NO.	MOLEX HSG PART NO.	BLOCKED POSITION KEYS	CONFIGURATION (SEE NOTES)
93425-4001	93429-1101	NONE	

4 Circuit			
MOLEX PART NO.	MOLEX HSG PART NO.	BLOCKED POSITION KEYS	CONFIGURATION (SEE NOTES)
93425-2001	93429-0701	NONE	

7 Circuit			
MOLEX PART NO.	MOLEX HSG PART NO.	BLOCKED POSITION KEYS	CONFIGURATION (SEE NOTES)
93425-5001	93429-1301	NONE	

EXAMPLE CIRCUIT SIZE 7 SHOWN BELOW

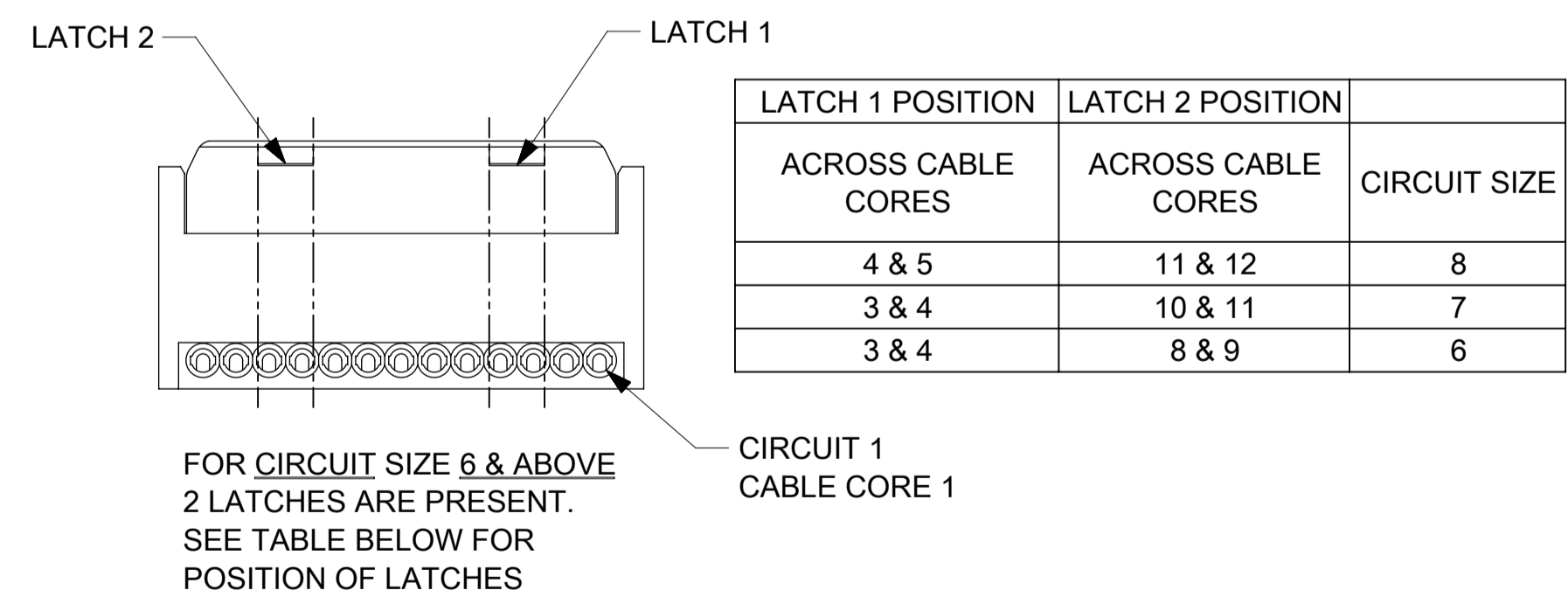

abcdef

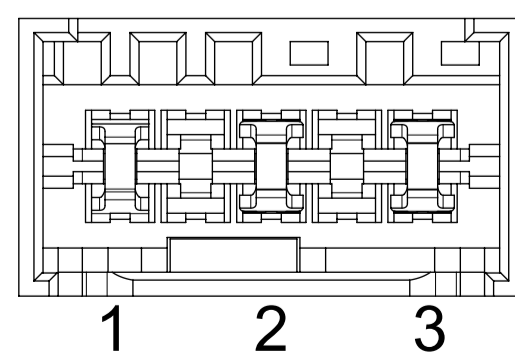

CODING IDENTIFICATION
(3 CKT EXAMPLE WITH CODING KEYS D & F BLOCKED)
VIEW IN MATING DIRECTION

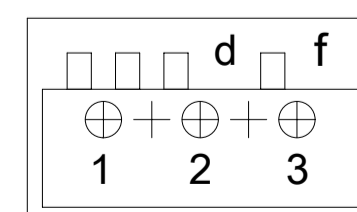

NOTES:

- ⊕ DENOTES LOADED TERMINAL POSITION
⊖ DENOTES VOIDED TERMINAL POSITION
- MOLEX HOUSING NUMBER FOR REFERENCE ONLY

THIS DRAWING CONTAINS INFORMATION THAT IS PROPRIETARY TO MOLEX ELECTRONIC TECHNOLOGIES, LLC AND SHOULD NOT BE USED WITHOUT WRITTEN PERMISSION

DIMENSION UNITS	SCALE	CURRENT REV DESC: DOC TYPE UPDATED				
mm	4:1					
GENERAL TOLERANCES (UNLESS SPECIFIED)				WIRE TO WIRE HEADER ASSEMBLY FLYING HEADER 5MM PITCH 0.22-0.38MM ² CABLE		
ANGULAR TOL	± 0.5°	EC NO: 608137		PRODUCT CUSTOMER DRAWING		
4 PLACES	±	DRWN: AKABADI 2018/11/23		DOCUMENT NUMBER		
3 PLACES	±	CHK'D: TCLEARY 2018/12/10		DOC TYPE DOC PART REVISION		
2 PLACES	± 0.05	APPR: DRYAN 2018/12/11		934250001		
1 PLACE	± 0.1	INITIAL REVISION:		PSD 000 D		
0 PLACES	±	DRWN: TJMURPHY 2016/03/21		MATERIAL NUMBER		
DRAFT WHERE APPLICABLE MUST REMAIN WITHIN DIMENSIONS		APPR: BRUTTLE 2016/06/13		CUSTOMER		
THIRD ANGLE PROJECTION		DRAWING		SHEET NUMBER		
		A1-SIZE		2 OF 2		
		SERIES		SEE CHARTS		
		93425		GENERAL MARKET		

EM-93424-010

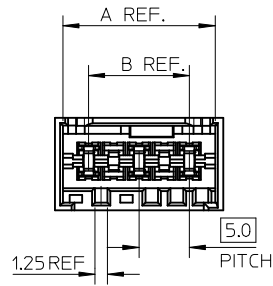
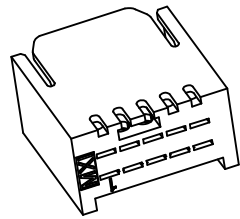

3 CIRCUIT CONNECTOR SHOWN

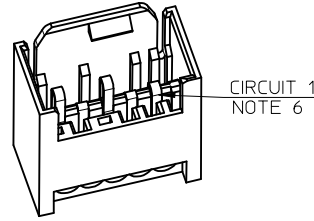

CKT	A	B
2	10.1	5.0
3	15.1	10.0
4	20.1	15.0
5	25.1	20.0
6	30.1	25.0
7	35.1	30.0
8	40.1	35.0
9	45.1	40.0
10	50.1	45.0

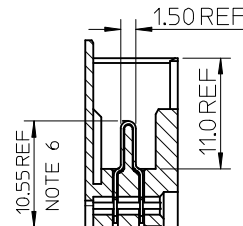
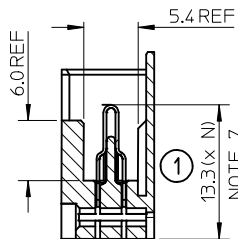
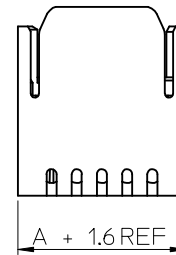
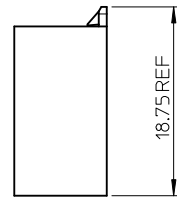
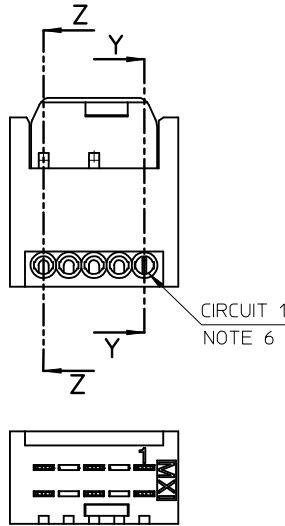
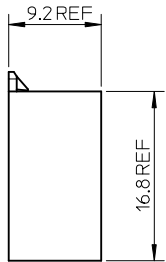

NOTES: SECTION Z-Z

- MATERIALS:
HOUSING: POLYAMIDE 66 (PA66)
UL94-V0. COLOUR NATURAL.
TERMINAL: COPPER ALLOY
PLATING: PRE PLATED HOT TIN DIP 4 - 7µm
- PRODUCT CONFORMS TO SPECIFICATION PS-99020-0090.
- MATES WITH RAST 2.5 APPLIMATE FEMALE CONNS.
- SEE PACKAGING PK-93422-001
- CONNECTOR DESIGNED FOR USE WITH PANEL 0.80MM TO 0.90MM THICKNESS.
- TERMINATED HEIGHT. CIRCUIT 1 SHOWN IN TERMINATED POSITION ONLY FOR PURPOSE OF DIMENSIONING TERMINATED HEIGHT POSITION.
- TERMINAL PRE-TERMINATED HEIGHT. N=NUMBER OF CIRCUITS.
- SEE APPLICATION SPEC AS-99033-010.
- CONNECTOR DESIGNED TO RAST 2.5 STANDARD.

LAST INSPECTION NUMBER: 16

Original Release EC NO: IPG2015-0156 DRW:MSHANAHAN 2014/08/25 CHKD:CMONAHAN 2014/10/14 APPR:MSHANAHAN 2014/11/06	QUALITY SYMBOLS FC = 1	GENERAL TOLERANCES (UNLESS SPECIFIED)		DIMENSION STYLE MM ONLY	SCALE 2:1	DESIGN UNITS METRIC	THIRD ANGLE PROJECTION
			mm	INCH	DRAWN BY MSHANAHAN	DATE 2013/02/01	TITLE VO FLYING HEADER ASSY 0.22 TO 0.38 WIRE 5MM PITCH
		4 PLACES	± ---	± ---	CHECKED BY DATE		
		3 PLACES	± ---	± ---	CMONAHAN	2014/10/14	
		2 PLACES	± 0.05	± ---	APPROVED BY DATE		
1 PLACE	± 0.10	± ---	MSHANAHAN	2014/11/06			
0 PLACE	± ---	± ---	MATERIAL NO.		DOCUMENT NO.	SHEET NO.	
		ANGULAR ± .5 °	SEE SHEETS 2+		SD-93725-001	1 OF 3	
DRAFT WHERE APPLICABLE MUST REMAIN WITHIN DIMENSIONS		SIZE A3	THIS DRAWING CONTAINS INFORMATION THAT IS PROPRIETARY TO MOLEX INCORPORATED AND SHOULD NOT BE USED WITHOUT WRITTEN PERMISSION				

2-CIRCUIT

MOLEX PART NO.	MOLEX HSG PART NO.	BLOCKED POSITION KEYS	CONFIGURATION (SEE NOTES)
93725-0001	93729-0301	NONE	
93725-0008	93729-0302	c, d	

4-CIRCUIT

MOLEX PART NO.	MOLEX HSG PART NO.	BLOCKED POSITION KEYS	CONFIGURATION (SEE NOTES)
93725-0003	93729-0701	NONE	

3-CIRCUIT

MOLEX PART NO.	MOLEX HSG PART NO.	BLOCKED POSITION KEYS	CONFIGURATION (SEE NOTES)
93725-0002	93729-0501	NONE	

5-CIRCUIT

MOLEX PART NO.	MOLEX HSG PART NO.	BLOCKED POSITION KEYS	CONFIGURATION (SEE NOTES)
93725-0004	93729-0901	NONE	

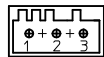
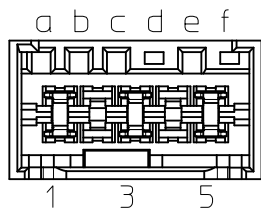

CODING IDENTIFICATION
(3 CKT EXAMPLE WITH
CODING KEYS D AND F BLOCKED)
VIEW IN MATING DIRECTION

NOTES:

- ⊕ DENOTES LOADED TERMINAL POSITION
+ DENOTES VOIDED TERMINAL POSITION
- MOLEX HOUSING NUMBER FOR REFERENCE ONLY

SEE SHEET 1 EC NO: IPG2015-0156 DRW: MSHANAHAN 2014/08/25 CHK'D: CMONAHAN APPR: MSHANAHAN 2014/11/06	QUALITY SYMBOLS	GENERAL TOLERANCES (UNLESS SPECIFIED)		DIMENSION STYLE MM ONLY		SCALE 3:1	DESIGN UNITS METRIC	THIRD ANGLE PROJECTION	
			mm	INCH	DRAWN BY	DATE	TITLE		
		4 PLACES	± ---	± ---	MSHANAHAN	2013/02/01	VO FLYING HEADER ASSY 0.22 TO 0.38 WIRE 5MM PITCH		
		3 PLACES	± ---	± ---	CHECKED BY	DATE			
		2 PLACES	± 0.05	± ---	CMONAHAN	2014/10/14	<div style="text-align: center; font-size: 2em; font-weight: bold;">molex</div>		
1 PLACE	± 0.10	± ---	APPROVED BY	DATE					
0 PLACE	± ---	± ---	MSHANAHAN	2014/11/06	MATERIAL NO.		DOCUMENT NO.	SHEET NO.	
		ANGULAR ± .5 °		SEE CHARTS		SD-93725-001		2 OF 3	
		DRAFT WHERE APPLICABLE MUST REMAIN WITHIN DIMENSIONS		THIS DRAWING CONTAINS INFORMATION THAT IS PROPRIETARY TO MOLEX INCORPORATED AND SHOULD NOT BE USED WITHOUT WRITTEN PERMISSION					

6-CIRCUIT			
MOLEX PART NO.	MOLEX HSG PART NO.	BLOCKED POSITION KEYS	CONFIGURATION (SEE NOTES)
93725-0005	93729-1101	NONE	

8-CIRCUIT			
MOLEX PART NO.	MOLEX HSG PART NO.	BLOCKED POSITION KEYS	CONFIGURATION (SEE NOTES)
93725-0007	93729-1501	NONE	

7-CIRCUIT			
MOLEX PART NO.	MOLEX HSG PART NO.	BLOCKED POSITION KEYS	CONFIGURATION (SEE NOTES)
93725-0006	93729-1301	NONE	

EXAMPLE CIRCUIT SIZE 7 SHOWN BELOW

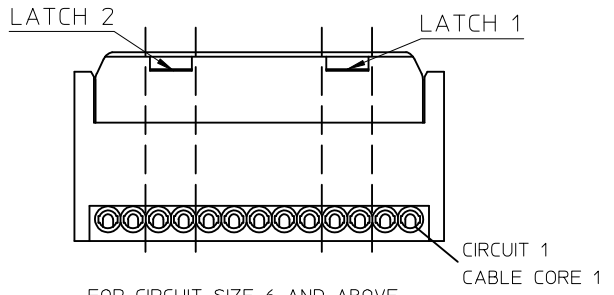

FOR CIRCUIT SIZE 6 AND ABOVE
2 LATCHES ARE PRESENT.
SEE TABLE BELOW FOR
POSITION OF LATCHES

LATCH 1 POSITION ACROSS CABLE CORES	LATCH 2 POSITION ACROSS CABLE CORES	CIRCUIT SIZE
4 & 5	11 & 12	8
3 & 4	10 & 11	7
3 & 4	8 & 9	6

NOTES:

- ⊕ DENOTES LOADED TERMINAL POSITION
+ DENOTES VOIDED TERMINAL POSITION
- MOLEX HOUSING NUMBER FOR REFERENCE ONLY

SEE SHEET 1 EC NO: IPG2015-0156 DRWN:MSHANAHAN 2014/08/25 CHKD:CMONAHAN 2014/10/14 APPR:MSHANAHAN 2014/11/06	QUALITY SYMBOLS	GENERAL TOLERANCES (UNLESS SPECIFIED)	DIMENSION STYLE MM ONLY	SCALE 2:1	DESIGN UNITS METRIC	THIRD ANGLE PROJECTION
	DESCRIPTION	mm	INCH	DRAWN BY MSHANAHAN	DATE 2013/02/01	TITLE VO FLYING HEADER ASSY 0.22 TO 0.38 WIRE 5MM PITCH
		4 PLACES ± ---	± ---	CHECKED BY CMONAHAN	DATE 2014/10/14	
		3 PLACES ± ---	± ---	APPROVED BY MSHANAHAN	DATE 2014/11/06	
2 PLACES ± 0.05	± ---	MATERIAL NO.	DOCUMENT NO.	SHEET NO.	THIS DRAWING CONTAINS INFORMATION THAT IS PROPRIETARY TO MOLEX INCORPORATED AND SHOULD NOT BE USED WITHOUT WRITTEN PERMISSION	
1 PLACE ± 0.10	± ---	ANGULAR ± .5 °	SEE CHARTS		SD-93725-001 3 OF 3	
0 PLACE ± ---	± ---	DRAFT WHERE APPLICABLE MUST REMAIN WITHIN DIMENSIONS	SIZE A3			

EM-93424-010

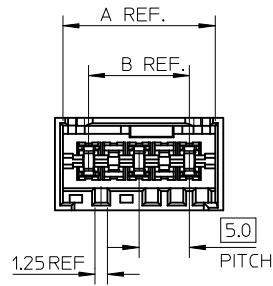
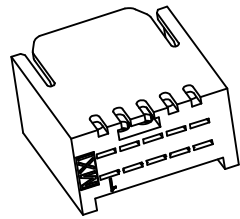

3 CIRCUIT CONNECTOR SHOWN

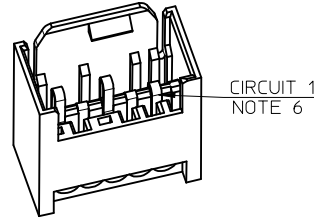

CKT	A	B
2	10.1	5.0
3	15.1	10.0
4	20.1	15.0
5	25.1	20.0
6	30.1	25.0
7	35.1	30.0
8	40.1	35.0
9	45.1	40.0
10	50.1	45.0

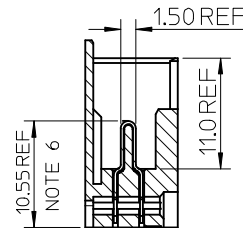
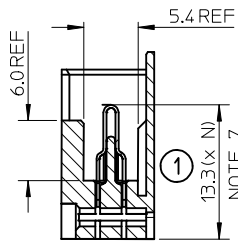
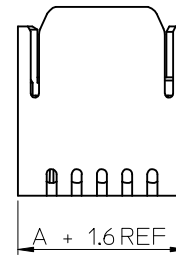
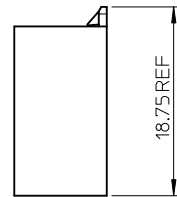
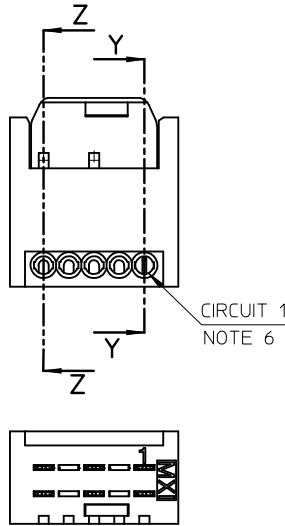
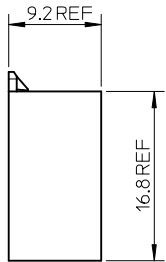

NOTES: SECTION Z-Z

- MATERIALS:
HOUSING: POLYAMIDE 66 (PA66)
UL94-V0. COLOUR NATURAL.
TERMINAL: COPPER ALLOY
PLATING: PRE PLATED HOT TIN DIP 4 - 7µm
- PRODUCT CONFORMS TO SPECIFICATION PS-99020-0090.
- MATES WITH RAST 2.5 APPLIMATE FEMALE CONNS.
- SEE PACKAGING PK-93422-001
- CONNECTOR DESIGNED FOR USE WITH PANEL 0.80MM TO 0.90MM THICKNESS.
- TERMINATED HEIGHT. CIRCUIT 1 SHOWN IN TERMINATED POSITION ONLY FOR PURPOSE OF DIMENSIONING TERMINATED HEIGHT POSITION.
- TERMINAL PRE-TERMINATED HEIGHT. N=NUMBER OF CIRCUITS.
- SEE APPLICATION SPEC AS-99033-010.
- CONNECTOR DESIGNED TO RAST 2.5 STANDARD.

LAST INSPECTION NUMBER: 16

Original Release EC NO: IPG2015-0156 DRW:MSHANAHAN 2014/08/25 CHKD:CMONAHAN 2014/10/14 APPR:MSHANAHAN 2014/11/06	QUALITY SYMBOLS FC = 1	GENERAL TOLERANCES (UNLESS SPECIFIED)		DIMENSION STYLE MM ONLY		SCALE 2:1	DESIGN UNITS METRIC	THIRD ANGLE PROJECTION		
			mm	INCH	DRAWN BY MSHANAHAN	DATE 2013/02/01	TITLE VO FLYING HEADER ASSY 0.22 TO 0.38 WIRE 5MM PITCH			
		4 PLACES	± ---	± ---	CHECKED BY CMONAHAN	DATE 2014/10/14	DOCUMENT NO. SD-93725-001			
		3 PLACES	± ---	± ---	APPROVED BY MSHANAHAN	DATE 2014/11/06				
		2 PLACES	± 0.05	± ---	MATERIAL NO.		SEE SHEETS 2+			
1 PLACE	± 0.10	± ---	DRAFT WHERE APPLICABLE MUST REMAIN WITHIN DIMENSIONS		THIS DRAWING CONTAINS INFORMATION THAT IS PROPRIETARY TO MOLEX INCORPORATED AND SHOULD NOT BE USED WITHOUT WRITTEN PERMISSION					
0 PLACE	± ---	± ---	ANGULAR ± .5 °							

2-CIRCUIT

MOLEX PART NO.	MOLEX HSG PART NO.	BLOCKED POSITION KEYS	CONFIGURATION (SEE NOTES)
93725-0001	93729-0301	NONE	
93725-0008	93729-0302	c, d	

4-CIRCUIT

MOLEX PART NO.	MOLEX HSG PART NO.	BLOCKED POSITION KEYS	CONFIGURATION (SEE NOTES)
93725-0003	93729-0701	NONE	

3-CIRCUIT

MOLEX PART NO.	MOLEX HSG PART NO.	BLOCKED POSITION KEYS	CONFIGURATION (SEE NOTES)
93725-0002	93729-0501	NONE	

5-CIRCUIT

MOLEX PART NO.	MOLEX HSG PART NO.	BLOCKED POSITION KEYS	CONFIGURATION (SEE NOTES)
93725-0004	93729-0901	NONE	

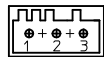
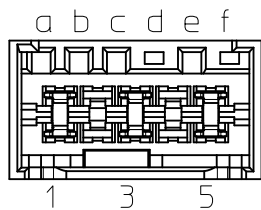

CODING IDENTIFICATION
(3 CKT EXAMPLE WITH
CODING KEYS D AND F BLOCKED)
VIEW IN MATING DIRECTION

NOTES:

- ⊕ DENOTES LOADED TERMINAL POSITION
+ DENOTES VOIDED TERMINAL POSITION
- MOLEX HOUSING NUMBER FOR REFERENCE ONLY

SEE SHEET 1 EC NO: IPG2015-0156 DR: W/MSHANAHAN 2014/08/25 CHK'D: CMONAHAN APPR: MSHANAHAN 2014/11/06	QUALITY SYMBOLS	GENERAL TOLERANCES (UNLESS SPECIFIED)		DIMENSION STYLE MM ONLY		SCALE 3:1	DESIGN UNITS METRIC	THIRD ANGLE PROJECTION	
			mm	INCH	DRAWN BY	DATE	TITLE		
		4 PLACES	± ---	± ---	MSHANAHAN	2013/02/01	VO FLYING HEADER ASSY 0.22 TO 0.38 WIRE 5MM PITCH		
		3 PLACES	± ---	± ---	CHECKED BY	DATE			
		2 PLACES	± 0.05	± ---	CMONAHAN	2014/10/14	<div style="text-align: center; font-size: 2em; font-weight: bold;">molex</div>		
1 PLACE	± 0.10	± ---	APPROVED BY	DATE					
0 PLACE	± ---	± ---	MSHANAHAN	2014/11/06	MATERIAL NO.	DOCUMENT NO.	SHEET NO.		
DRAFT WHERE APPLICABLE MUST REMAIN WITHIN DIMENSIONS		ANGULAR ± .5 °		SEE CHARTS		SD-93725-001	2 OF 3		
THIS DRAWING CONTAINS INFORMATION THAT IS PROPRIETARY TO MOLEX INCORPORATED AND SHOULD NOT BE USED WITHOUT WRITTEN PERMISSION									

6-CIRCUIT			
MOLEX PART NO.	MOLEX HSG PART NO.	BLOCKED POSITION KEYS	CONFIGURATION (SEE NOTES)
93725-0005	93729-1101	NONE	

8-CIRCUIT			
MOLEX PART NO.	MOLEX HSG PART NO.	BLOCKED POSITION KEYS	CONFIGURATION (SEE NOTES)
93725-0007	93729-1501	NONE	

7-CIRCUIT			
MOLEX PART NO.	MOLEX HSG PART NO.	BLOCKED POSITION KEYS	CONFIGURATION (SEE NOTES)
93725-0006	93729-1301	NONE	

EXAMPLE CIRCUIT SIZE 7 SHOWN BELOW

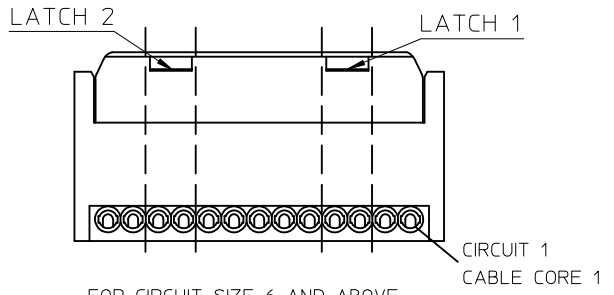

FOR CIRCUIT SIZE 6 AND ABOVE
2 LATCHES ARE PRESENT.
SEE TABLE BELOW FOR
POSITION OF LATCHES

LATCH 1 POSITION ACROSS CABLE CORES	LATCH 2 POSITION ACROSS CABLE CORES	CIRCUIT SIZE
4 & 5	11 & 12	8
3 & 4	10 & 11	7
3 & 4	8 & 9	6

NOTES:

- ⊕ DENOTES LOADED TERMINAL POSITION
+ DENOTES VOIDED TERMINAL POSITION
- MOLEX HOUSING NUMBER FOR REFERENCE ONLY

SEE SHEET 1 EC NO: IPG2015-0156 DRWN:MSHANAHAN 2014/08/25 CHKD:CMONAHAN 2014/10/14 APPR:MSHANAHAN 2014/11/06	DESCRIPTION QUALITY SYMBOLS	GENERAL TOLERANCES (UNLESS SPECIFIED)		DIMENSION STYLE MM ONLY		SCALE 2:1	DESIGN UNITS METRIC	THIRD ANGLE PROJECTION			
		4 PLACES ± --- ± --- 3 PLACES ± --- ± --- 2 PLACES ± 0.05 ± --- 1 PLACE ± 0.10 ± --- 0 PLACE ± --- ± ---	mm INCH	DRAWN BY MSHANAHAN	DATE 2013/02/01	TITLE VO FLYING HEADER ASSY 0.22 TO 0.38 WIRE 5MM PITCH					
		ANGULAR ± .5 °		CHECKED BY CMONAHAN	DATE 2014/10/14	APPROVED BY MSHANAHAN 2014/11/06					
		DRAFT WHERE APPLICABLE MUST REMAIN WITHIN DIMENSIONS		MATERIAL NO. SEE CHARTS		DOCUMENT NO. SD-93725-001		SHEET NO. 3 OF 3			