

THIS DRAWING IS A CONTROLLED DOCUMENT

THIS DRAWING IS UNCLASSIFIED DATE 01-11-2001 BY 60328/UC/BAW/STP/STP

DIST

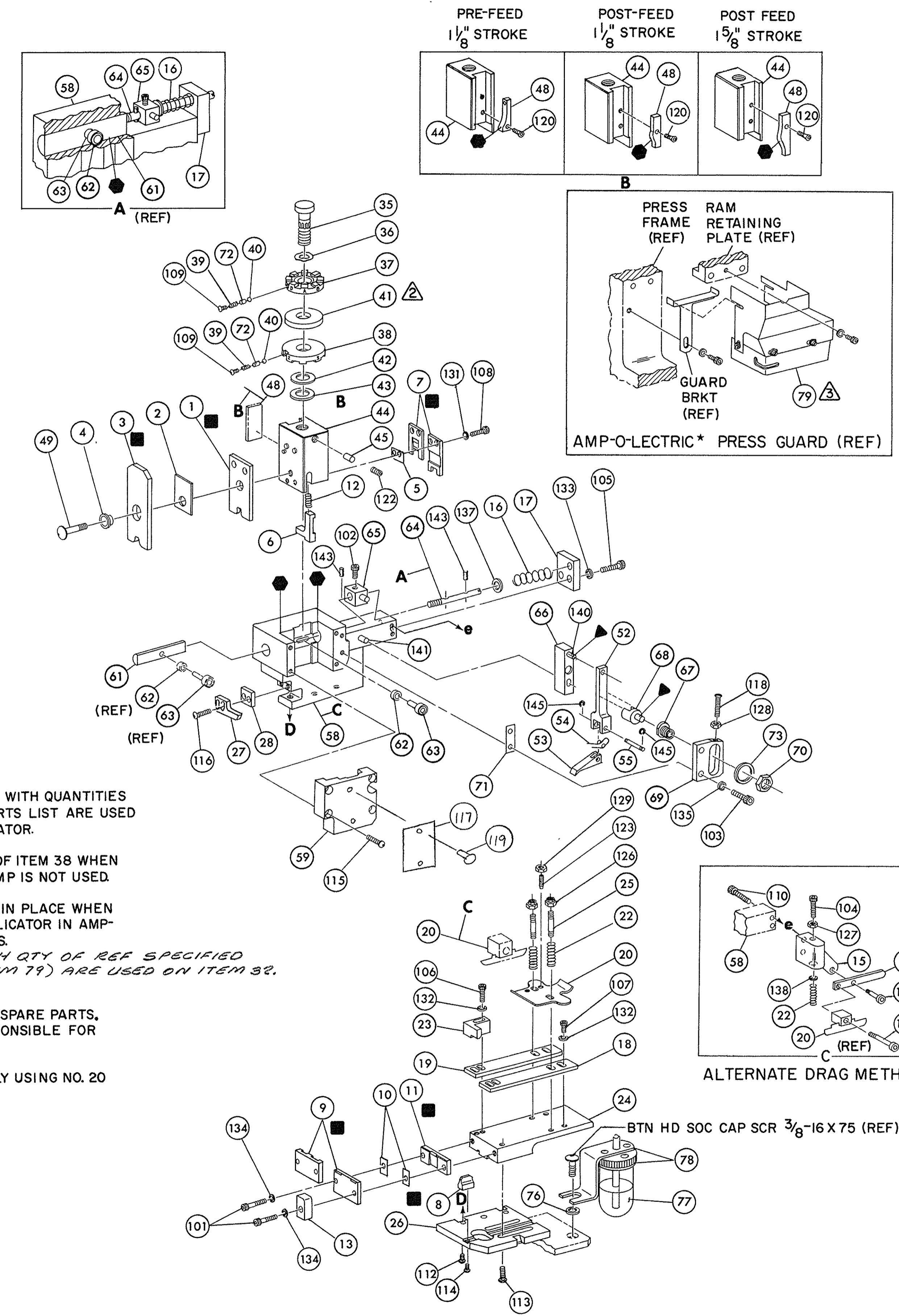

NOTES:

1. ONLY THE ITEMS WITH QUANTITIES SPECIFIED ON PARTS LIST ARE USED ON THIS APPLICATOR.
2. USED IN PLACE OF ITEM 38 WHEN INSULATION CRIMP IS NOT USED.
3. GUARD MUST BE IN PLACE WHEN OPERATING APPLICATOR IN AMP-O-LECTRIC PRESS.
4. PARTS WITH QTY OF REF SPECIFIED (EXCEPT ITEM 79) ARE USED ON ITEM 32.

KEY:

- RECOMMENDED SPARE PARTS. CUSTOMER RESPONSIBLE FOR REPLACEMENT.
- ▲ LUBRICATE DAILY USING NO. 20 MACHINE OIL.
- GREASE LIGHTLY.

* Trademark of AMP Incorporated

REF	QTY	PART NO	DESCRIPTION	ITEM NO	REF	QTY	PART NO	DESCRIPTION	ITEM NO
REF		21045-3	RING, RETAINING 'C' (.187 DIA) FEED PIN	145	REF		454220-1	CAP, RAM	59
REF		5-21028-1	PIN, SLOT SPG (.12 DIA X .50) FD ADJ ROD	143	REF		453736-1	HOUSING	58
REF		1-21030-7	PIN, DOWEL (.187 DIA X 1.50) HOUSING	141	REF		240624-1	PIN, FEED FINGER	55
REF		1-21030-1	PIN, DOWEL (.187 DIA X .50) LEVER	140	REF		691499-1	SPRING, FEED FINGER	54
REF		22260-5	WASHER, FLAT (NO 6) DRAG SPRING	138	REF		240635-1	FINGER, FEED	53
REF		21899-4	WASHER, FLAT (5/16 DIA) SCR ADJ	137	REF		240634-3	LEVER, TERMINAL	52
REF		21024-5	WASHER, LOCK (NO 10) FEED ADJ PLATE	135	1		7-21002-9	BOLT, CRIMPER	50
2		21024-5	WASHER, LOCK (NO 10) SHEAR PLATES	134	1		690501-4	CAM, POST FEED	49
REF		21024-5	WASHER, LOCK (NO 10) FEED ROD GUIDE	133					48
4		21024-4	WASHER, LOCK (NO 8) STRIP GUIDE	132					47
2		21024-4	WASHER, LOCK (NO 8) SHEAR BLADE	131	1		690191-1	PLUG, NYLON	46
REF		21018-4	NUT, HEX MACH (4-40) DRAG	130	1		455674-1	RAM	45
REF		21068-5	NUT, HEX MACH (6-32) FD ADJ PLATE	129	1		690125-1	WASHER, LAMINATED	44
REF		21018-7	NUT, HEX MACH (10-32) DRAG SPRING	127	1		690124-1	WASHER, RAM	43
2		21022-2	NUT, HEX SELF-LKG (8-32) DRAG STUD	126	2		23241-6	SPACER, DISC	41
REF		5-21004-7	SCR, SKT HD SHLD (250 DIA X .25) DRAG ARM	125	2		690170-1	BALL, STEEL	40
REF		21004-5	SCR, SKT HD SHLD (250 DIA X 1.00) DRAG	124	1		690170-1	SPRING, COMPRESSION	39
2		4-21078-8	SCR, SKT SET OVAL POINT (4-40 X .75) DRAG	123	1		690142-1	DISC, INSULATION	38
1		21009-2	SCR, SKT SET (1/4-20 X 25) (LOC-WEL) RAM	122	1		5-690141-8	DISC, WIRE	37
REF		21017-2	SCR, DRIVE (#2 X .19) ID PLATE	120	1		22480-5	WASHER, SPRING	36
REF		3-21064-2	SCR, RD HD MACH (6-32 X 1.50) FEED ADJ PLATE, ID	118	1		690212-1	POST, RAM	35
REF		2-21002-9	SCR, BTN HD SKT CAP (8-32 X .50) STRIPPER	116					34
REF		2-21002-9	SCR, BTN HD SKT CAP (10-32 X .75) HSG CAP	115					33
REF		2-21002-9	SCR, BTN HD SKT CAP (8-32 X .38) (LOC-WEL) ANVIL	114	1		458980-2	APPLICATOR, BASIC (SUB ASSY)	32
REF		3-21002-3	SCR, BTN HD SKT CAP (1/4-20 X .50) STR GDE PL	113	1				31
REF		1-24073-9	SCR, BTN HD SKT CAP (1/4-20 X .75) BASE PL	112	REF		455676-1	PLATE, BASE	26
REF		2-21000-4	SCR, SKT HD CAP (6-32 X 1.00) DRAG ADAPTOR	111	2		22354-8	DRAG, STUD	25
REF		2-21000-7	SCR, SKT HD CAP (8-32 X .25) (LOC-WEL) CP DISC	109	1		455678-1	PLATE, STRIP GUIDE	24
REF		2-21000-6	SCR, SKT HD CAP (8-32 X .50) SHEAR BLADE	108	2		4-22281-1	PLATE, STRIP HOLD	23
REF		2-21000-6	SCR, SKT HD CAP (8-32 X .38) STRIP GUIDE	107	REF		240636-1	SPRING, DRAG	22
REF		3-21000-7	SCR, SKT HD CAP (10-32 X .75) FD ROD GUIDE	106	1		454177-1	LEVER, DRAG	21
REF		3-21000-9	SCR, SKT HD CAP (10-32 X 1.00) DRAG SPRING	105	1		458030-5	DRAG, STOCK	20
REF		3-21000-6	SCR, SKT HD CAP (10-32 X .62) FD ADJ PLATE	104	1		458031-5	GUIDE, STRIP (REAR)	19
REF		3-21000-4	SCR, SKT HD CAP (10-32 X .38) PIVOT BLK	103	REF		454178-1	GUIDE, STRIP (FRONT)	18
REF		3-21000-8	SCR, SKT HD CAP (10-32 X .88) SHEAR PLATE	102	REF		4-22284-9	GUIDE, FEED ROD	17
REF		455745-1	GUARD	101				SPRING, FEED RETURN	16
REF		465184-9	LUBRICATOR ASSY	78				ADAPTER, DRAG	15
REF		455985-1	OIL, LUBRICATING	77					14
REF		454406-1	SPACER, LUB BRACKET	76	1		240644-1	SPACER, HOLD DOWN	13
REF		458109-1	WASHER, FLAT (SPECIAL)	75				SPRING, HOLD DOWN	12
REF		690603-1	SPRING, ASSIST	74	1		690482-8	PLATE, REAR SHEAR	11
REF		690517-1	SPACER	73	1		4-238005-7	SPACER, SHEAR PLATE	10
REF		22594-8	NUT, HEX	72	1		1-690474-0	PLATE, FRONT SHEAR	9
REF		240628-1	PLATE, ADJ	71	1		5-240641-0	ANVIL	8
REF		240626-1	SHAFT, PIVOT	70	1		238009-1	BLADE, SLUG	7
REF		240633-1	BUSHING	69	1		1-458134-1	HOLD DOWN, TERMINAL	6
REF		455680-1	LEVER, INTERMEDIATE	68	1		455838-7	SPACER, SHEAR BLADE	5
REF		240629-1	BLOCK, PIVOT	67	1		456411-7	SPACER, TUBULAR	4
REF		240632-2	SCREW, ADJ	66	1			CRIMPER, INSULATION	3
REF		240659-3	PIN, CAM ROLLER	65				SPACER, INSULATION	2
REF		240658-1	CAM, ROLLER	64				CRIMPER, WIRE	1
REF		454398-1	ROD, FEED	63					

REMARKS		NO	REV
APPL USED ON MACHINE PART NO		TO APPLY TERMINAL	
CUSTOMER NAME		DISTRIBUTION	
ADDRESS		ORIGINAL	
CITY		CUSTOMER COPY	
		FIELD ENG COPY	

CRIMPING DATA					APPLICATOR WILL APPLY	
PAD LTR	CRIMP HEIGHT	WIRE SIZE	WIRE STRIP LENGTH	60744		
A	.089	14				
B	.083	16				
C	.078	18				
D	NOT USED					

CRIMP	SIZE	TYPE	FEED	APPL INST
WIRE	.140	F		A18039
INSUL	.210	F	.855	
WIRE RANGE	18-19			
INSULATION RANGE	.120-.160			
PRESS NO				

REMARKS: AMPOMATOR

APPL SPEC 114-2084