

4

3

2

1

THIS DRAWING IS UNPUBLISHED. RELEASED FOR PUBLICATION
 © COPYRIGHT - TE Connectivity Ltd. ALL RIGHTS RESERVED.

REVISIONS				
P	LTR	DESCRIPTION	DATE	APVD
H1		REVISED PER ECR-09-017960	26AUG09	HMR JR
H2		REVISED PER ECO-18-006974	08MAY2018	RS DR

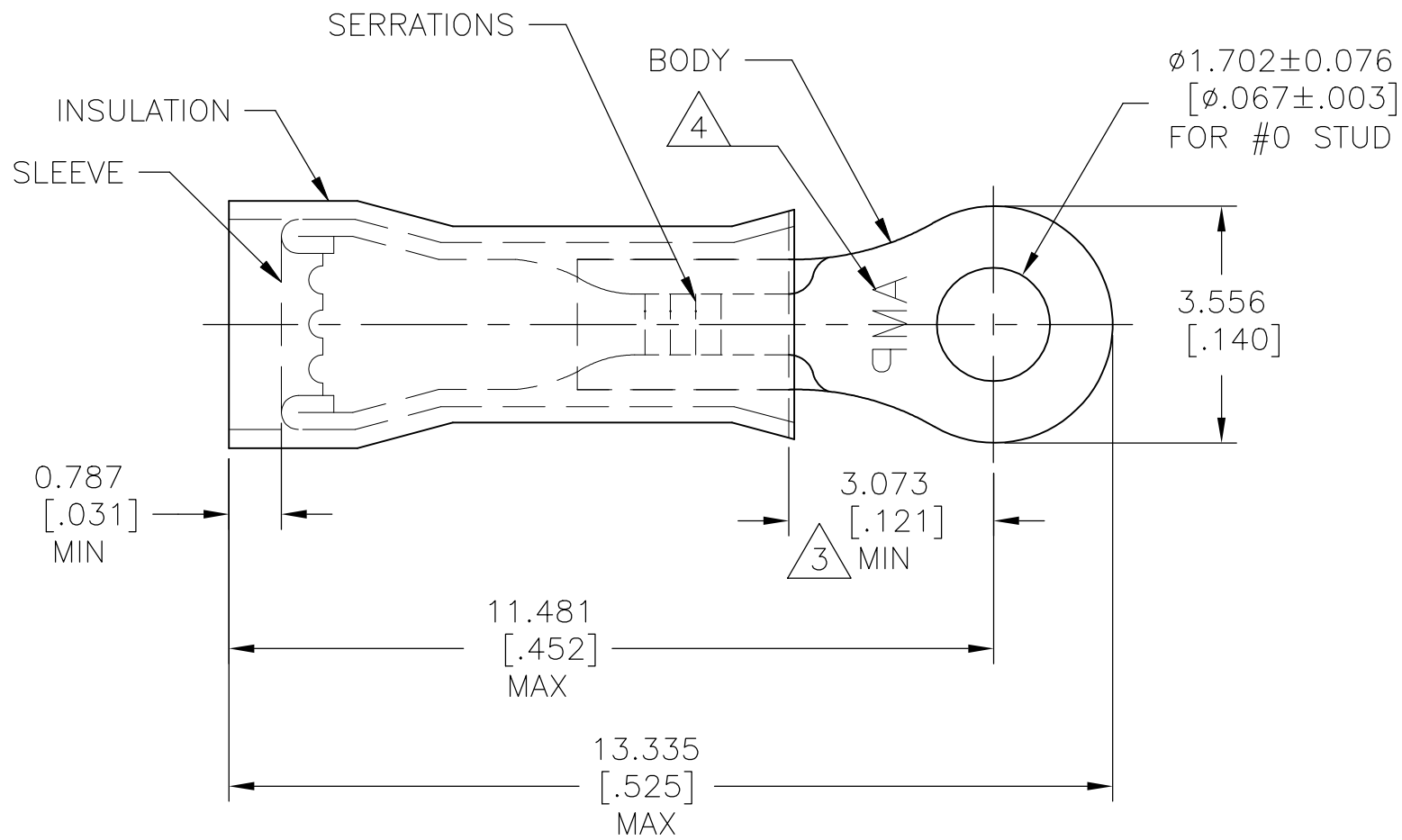

- 1 FOR $\phi 1.270$ [$\phi 0.050$] TO $\phi 2.083$ [$\phi 0.082$] WIRE INSULATION DIA
- 2 BODY MATERIAL THK: 0.457 ± 0.051 [0.018 ± 0.002]
- 3** APPLIES FROM THE EDGE OF THE METAL BARREL TO THE CENTER OF THE STUD
- 4** STAMP AMP APPROX AS SHOWN

QTY	DESCRIPTION	MATERIAL & FINISH	PART NO
4000	321013 ON TAPE	BODY: COPPER (ASTM-B152) TIN PL (ASTM-B545)	2-321013-1
1000	LOOSE PIECE	SLEEVE: COPPER (ASTM-B152) INSULATION: YELLOW NYLON	321013

AMP INCORPORATED
CUSTOMER SERVICE SYSTEMS

FOR ADDITIONAL PRODUCT INFORMATION OR COPIES OF DRAWINGS AND TECHNICAL DOCUMENTS	PRODUCT INFORMATION CENTER 1-800-522-6752
FOR APPLICATION TOOLING INFORMATION	TOOLING ASSISTANCE CENTER 1-800-722-1111
FOR ORDER ENTRY	1-800-526-5142

MAX RECOMMENDED OPERATING TEMPERATURE: 105°C [221°F]
VOLTAGE RATING: 300 V MAX
CIRCULAR MIL AREA: 0.10mm ² -0.41mm ² [202-810]

THIS DRAWING IS A CONTROLLED DOCUMENT.	
DIMENSIONS: mm [INCHES]	TOLERANCES UNLESS OTHERWISE SPECIFIED:
	0 PLC ± -
	1 PLC ± -
	2 PLC ± -
	3 PLC ± 0.127[.005]
	4 PLC ± -
	ANGLES ± 5°
MATERIAL SEE TABLE	FINISH SEE TABLE

DWN	26AUG09
CHK	RAGHAVENDRA
APVD	26AUG09
PRODUCT SPEC	JEFF RUTH
APPLICATION SPEC	TOM MICHIELUTTI
WEIGHT	114-2157
CUSTOMER DRAWING	

TE TE Connectivity Ltd.			
NAME WIRE TERMINAL PIDG - RING TONGUE WIRE SIZE: 26 - 22 AWG			
SIZE	CAGE CODE	DRAWING NO	RESTRICTED TO
A3	00779	C-321013	-
SCALE 10:1		SHEET 1 OF 1	REV H2