

4

3

2

1

Item	PartNo	Description	Qty
1	5000-15	PIANO HINGE, CUSTOM, 20X16	1
2	9912672-87-10	THUMB SCREW, #10 X 0.38LG, ZINC	2
3	9912681-87-10	WASHER,RETAINING,#8,.06 THK,NYLON	2
4	KIT-GPP-2016	PANEL PAD KIT, 20X16	1
5	9912595-82-10	SCREW, PAN HD, #10-16 X 1/2 LG, THD CUTTER, S.S.	4
6	5000-15-SPACER	SPACER, 3/8" O.D. X 0.219 I.D. X 0.219 LG,	4

NOTES:

A FULLY FUNCTIONAL WORKING UNIT MUST INCLUDE THE FOLLOWING:

- P/N 2016CHO: 20X16 HINGED LID: QTY 1
- P/N 201608BH: 20X16X08 HINGED BASE: QTY 1
- P/N KIT-GMMR8: MULTI-MAX RAIL KIT: QTY 1
 - P/N 20160835: MULTI-MAX RAIL: QTY: 4 PER KIT
 - P/N 9912636-87-10: SCREW, FLAT HD, #10-32 UNF X 3/8 LG, MACH, S.S.: QTY 4 PER KIT
 - P/N 9912595-82-10: SCREW, PAN HEAD, #10-16 X 1/2 LG, THD CUTTER, S.S.: QTY 8 PER KIT
- P/N GSR2016: STIFFENER, 20X16: QTY 1
- P/N ABP2016 GSOPK: ALUMINUM SWING OUT PANEL KIT: QTY 1

ENCLOSURE BASE,
P/N 201608BH
REFERENCE

POSITION SPACERS ON THE
RAIL, 1ST AND 2ND LOCATION.
TYPICAL

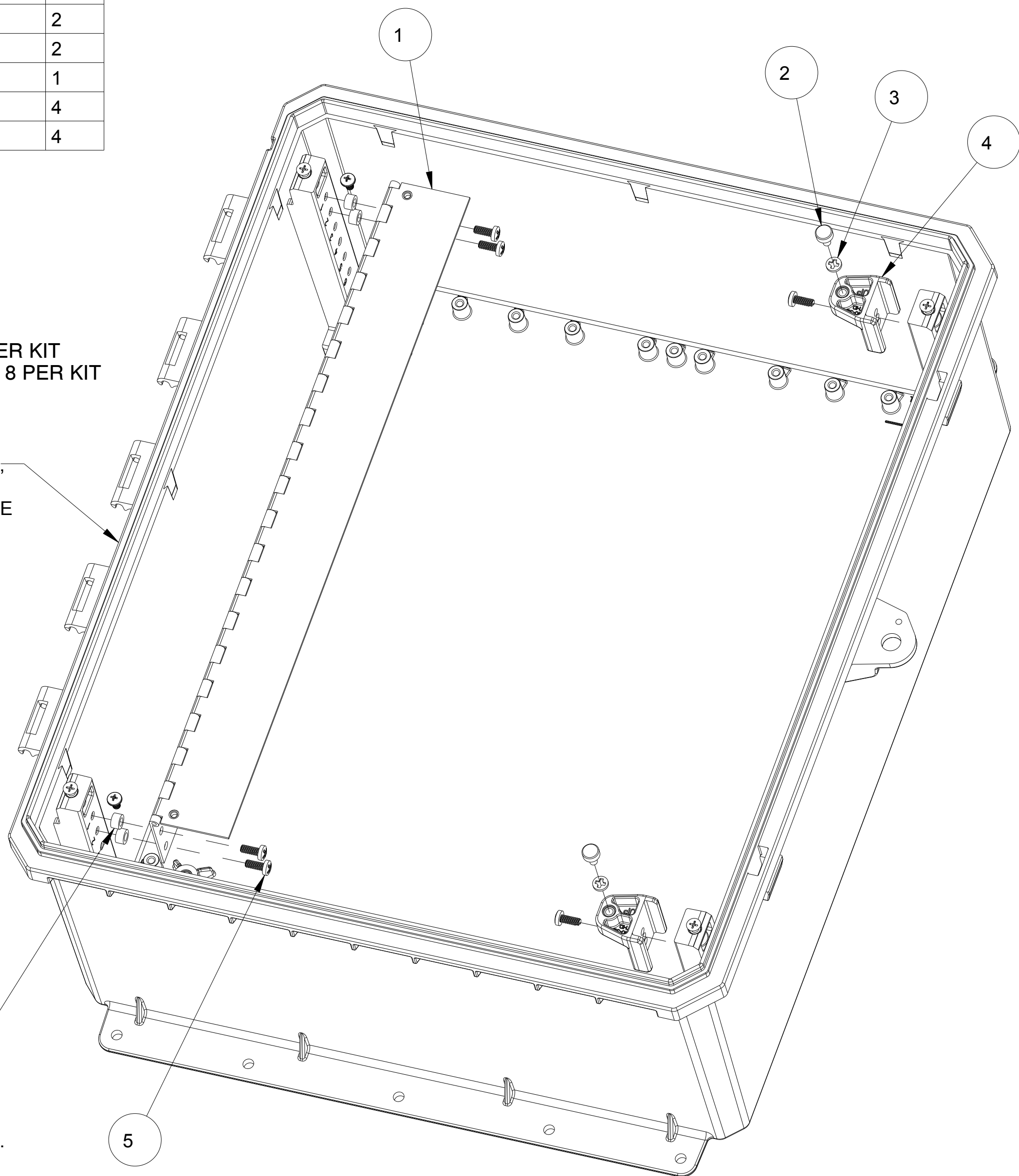

D

D

C

C

B

B

A

A

4

3

2

1

REV	DESCRIPTION	BY	DATE	ECN NO.	APPROVED BY
A	INITIAL RELEASE TO PRODUCTION	W.T.	03-29-2016		

DEFAULT TOLERANCES DECIMAL .XX ± 0.03 .XXX ± 0.010 FRACTIONAL ± 1/16 ANGULAR ± 5°		SCALE 0.430	SHEET 1 of 1	DRAWN BY W.TIDWELL	MUM INDUSTRIES 7750 TYLER BLVD MENTOR, OHIO, U.S.A. (440) 269-8155 FAX (440) 269-8166
TITLE GENESIS 20X16X08 SWING OUT PANEL KIT (NO PANEL INCLUDED)			DATE 03.29.16	DRAWING NUMBER GSOPK20	REV