

MOLEX LOGO

CKT NO.

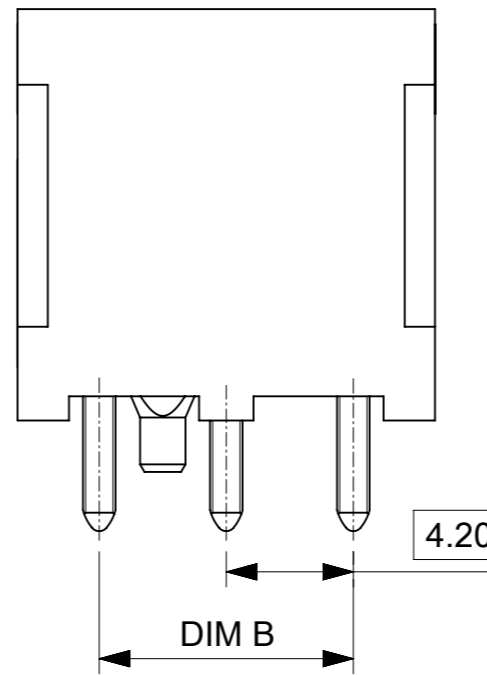
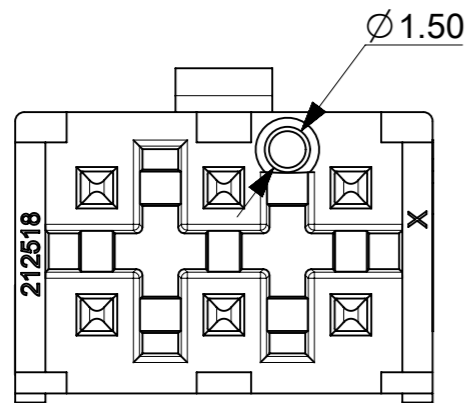

NOTES:

- MATERIALS:  
HOUSING - LCP UL94V-0, COLOR: BLACK  
TERMINAL - COPPER ALLOY
- TERMINAL PLATING: TIN OVER NICKEL OVERALL.
- PRODUCT SPECIFICATION: 2125150000-PS.
- PACKAGING SPECIFICATION: TRAY PACK PER: 212520001-PK
- PART MATES WITH MINI-FIT MAX RECEPTACLE SERIES 212514.
- DISCOLORIZATION IN THE BANDOLIER CARRIER AREA OF THE PIN IS INHERENT TO THE PLATING PROCESS AND IS DUE TO THE MASKING EFFECT OF THE CARRIER. THIS DISCOLORIZATION IS A NON-FUNCTIONAL AREA OF THE PIN AND WILL NOT AFFECT THE PERFORMANCE OF THE HEADER ASSEMBLY.
- CONNECTORS ARE NOT TO BE MATED OR UNMATED WHILE CIRCUITS ARE LIVE.
- PARTS ARE NOT DESIGNED FOR CURRENT SHARING.
- THIS PART CONFORMS TO CLASS "B" REQUIREMENTS OF COSMETIC SPECIFICATION PS-45499-002.
- TEXT ON PART IS FOR REFERENCE ONLY. TEXT AND TEXT LOCATION MAY VARY DEPENDING ON PART NUMBER AND/OR TOOL.

FUNCTIONAL SYMBOLS	THIS DRAWING CONTAINS INFORMATION THAT IS PROPRIETARY TO MOLEX ELECTRONIC TECHNOLOGIES, LLC AND SHOULD NOT BE USED WITHOUT WRITTEN PERMISSION		CURRENT REV DESC:		<b>molex</b>
	MM	SCALE			
FA = 0	mm	4:1			MINI-FIT MAX DR HDR VERTICAL VERT. HEADER ASSY 2-12 CKT
FE = 0	GENERAL TOLERANCES (UNLESS SPECIFIED)				PRODUCT CUSTOMER DRAWING
FE = 0	ANGULAR TOL ± °				DOCUMENT NUMBER
DIVISIONAL SYMBOLS	4 PLACES	±	EC NO: 712754	2022/07/01	2125200001-SD
	3 PLACES	±	DRWN: ZIXUAQ	2022/07/01	
	2 PLACES	± 0.25	CHK'D: XQZHANG	2022/07/01	DOC TYPE
	1 PLACE	± 0.5	APPR: XQZHANG	2022/07/01	DOC PART
	0 PLACES	±	INITIAL REVISION:		REVISION
DRAFT WHERE APPLICABLE MUST REMAIN WITHIN DIMENSIONS		THIRD ANGLE PROJECTION	DRWING	SERIES	MATERIAL NUMBER
			A3-SIZE	212520	SEE TABLE
			GENERAL MARKET		SHEET NUMBER
					1 OF 2

TIN PLATING				
CKT SIZE	PART NO.	DIM A	DIM B	DIM C
2	212520-1002	5.40	NA	NA
4	212520-1004	9.60	4.2	2.10
6	212520-1006	13.80	8.40	4.20
8	212520-1008	18.00	12.60	6.30
10	212520-1010	22.20	16.80	8.40
12	212520-1012	26.40	21.00	10.50

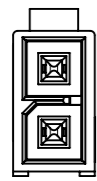

2 CKT

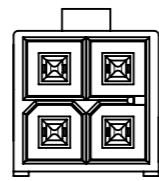

4 CKT

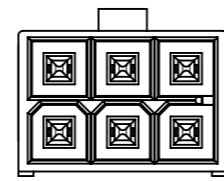

6 CKT

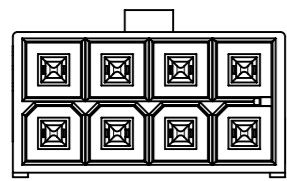

8 CKT

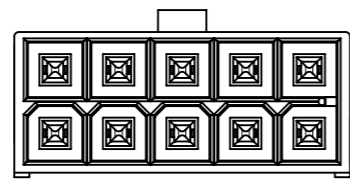

10 CKT

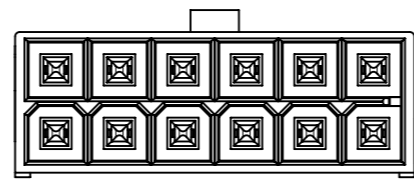

12 CKT

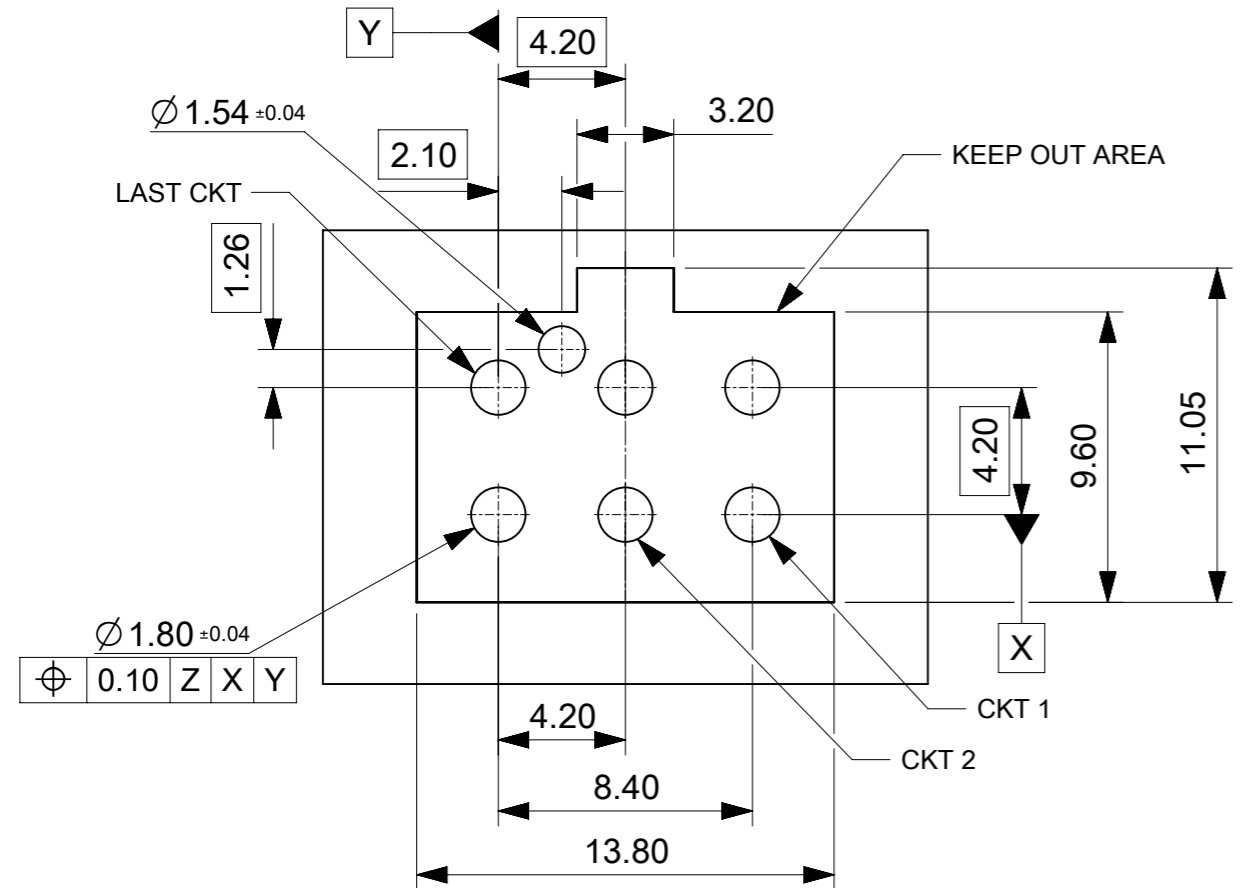

FOR 4 TO 12CKTS

PCB LAYOUT COMPONENT SIDE  
RECOMENDED PCB THICKNESS 1.60MM-2.40MM

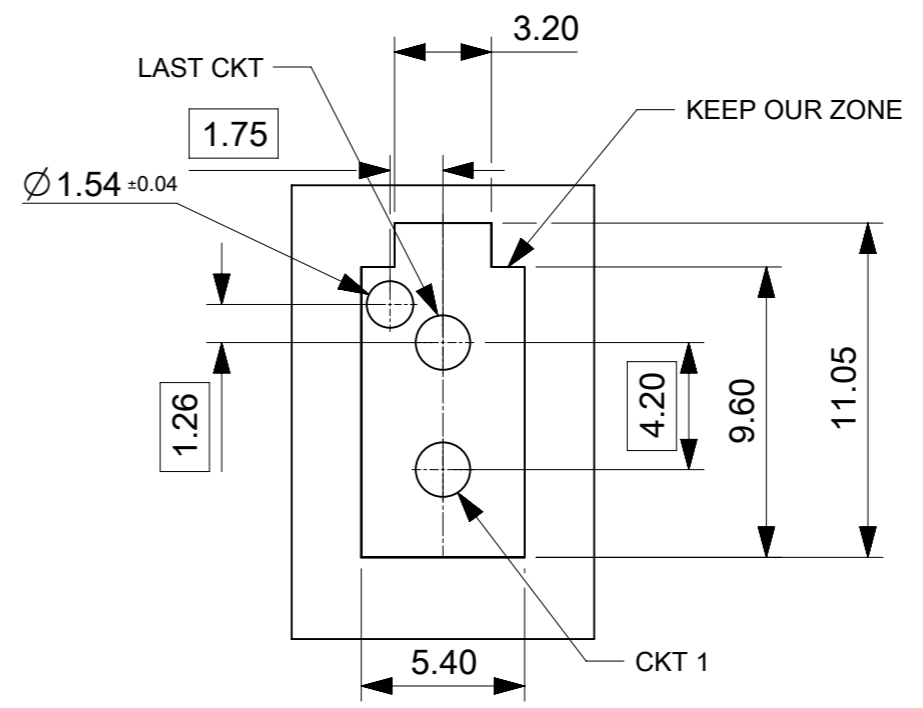

FOR 2CKTS

NOTE: DATUM -Z- IS ON PCB COMPONENT SIDE

FUNCTIONAL SYMBOLS	THIS DRAWING CONTAINS INFORMATION THAT IS PROPRIETARY TO MOLEX ELECTRONIC TECHNOLOGIES, LLC AND SHOULD NOT BE USED WITHOUT WRITTEN PERMISSION	CURRENT REV DESC:																											
	<table border="1"> <tr> <th>FUNCTIONAL SYMBOLS</th> <th>DIMENSION UNITS</th> <th>SCALE</th> </tr> <tr> <td><math>\nabla_A = 0</math></td> <td>mm</td> <td>4:1</td> </tr> <tr> <td colspan="3">GENERAL TOLERANCES (UNLESS SPECIFIED)</td> </tr> <tr> <td><math>\nabla_E = 0</math></td> <td colspan="2">ANGULAR TOL ± °</td> </tr> <tr> <td><math>\nabla_F = 0</math></td> <td colspan="2">4 PLACES ±</td> </tr> <tr> <td rowspan="4">DIVISIONAL SYMBOLS</td> <td>3 PLACES ±</td> <td></td> </tr> <tr> <td>2 PLACES ± 0.25</td> <td></td> </tr> <tr> <td>1 PLACE ± 0.5</td> <td></td> </tr> <tr> <td>0 PLACES ±</td> <td></td> </tr> </table>	FUNCTIONAL SYMBOLS	DIMENSION UNITS				SCALE	$\nabla_A = 0$	mm	4:1	GENERAL TOLERANCES (UNLESS SPECIFIED)			$\nabla_E = 0$	ANGULAR TOL ± °		$\nabla_F = 0$	4 PLACES ±		DIVISIONAL SYMBOLS	3 PLACES ±		2 PLACES ± 0.25		1 PLACE ± 0.5		0 PLACES ±		EC NO: 712754 DRWN: ZIXUAG CHK'D: XQZHANG APPR: XQZHANG 2022/07/01 2022/07/01
FUNCTIONAL SYMBOLS	DIMENSION UNITS	SCALE																											
$\nabla_A = 0$	mm	4:1																											
GENERAL TOLERANCES (UNLESS SPECIFIED)																													
$\nabla_E = 0$	ANGULAR TOL ± °																												
$\nabla_F = 0$	4 PLACES ±																												
DIVISIONAL SYMBOLS	3 PLACES ±																												
	2 PLACES ± 0.25																												
	1 PLACE ± 0.5																												
	0 PLACES ±																												
INITIAL REVISION:				PRODUCT CUSTOMER DRAWING																									
DRWN: SCHEN76 APPR: YXZHENG 2020/04/24 2020/05/13				DOCUMENT NUMBER		DOC TYPE	DOC PART	REVISION																					
DRAFT WHERE APPLICABLE MUST REMAIN WITHIN DIMENSIONS				2125200001-SD		PSD	000	B2																					
THIRD ANGLE PROJECTION				MATERIAL NUMBER		CUSTOMER		SHEET NUMBER																					
				SEE TABLE		GENERAL MARKET		2 OF 2																					