

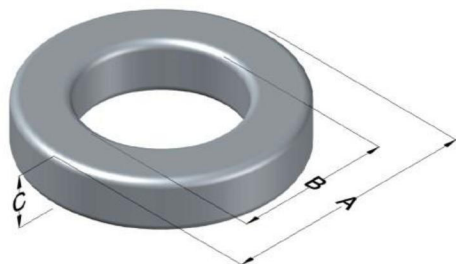

0059076A2

110 Delta Drive
 Pittsburgh, PA 15238
 NAFTA Sales: (1)800-245-3984
 HK Sales : (852)3102-9337
 magnetics@spang.com
 www.mag-inc.com



Edge Permeability (μ)	A_L (nH/T ²)	Core Marking			Coating Color
		Lot Number	Part Number	Inductance Grade	
60	56 \pm 8%	XXXXXX	59076A2	N/A	Green

Dimensions						Packaging
Uncoated			Coated Limits			
	(mm)	(in)	(mm)	(in)		Cardboard cut-outs Box Qty = 220 Pcs
OD (A)	35.81	1.410	36.70	1.445	max	
ID (B)	22.35	0.880	21.54	0.848	min	
HT (C)	10.46	0.412	11.35	0.447	max	

Electrical Characteristics			Physical Characteristics						
Watt Loss @ 100kHz, 100mT (max, mW/cm ³)	DC Bias min (Oersteds)		Voltage Breakdown wire-to-wire min (V _{AC})	Break Strength (min, kg)	Window Area, W _A (mm ²)	Cross Section, A _e (mm ²)	Path Length, L _e (mm)	Volume V _e (mm ³)	Weight (g)
	80%	50%							
525	100	180	3000	80	364	67.8	89.8	6090	49

Winding Information					Temperature Rating	
Winding Length per Turn			Wound Coil Dimensions (mm)		Curie Temp (°C):	500 °C
Winding Factor	(mm)	Winding Factor	(mm)	40% Winding Factor	OD	40.2
0%	37.9	40%	48.9	Completely Full Window	HT	18.4
20%	43.5	45%	50.6		Max OD	51.1
25%	44.8	50%	52.0	Surface Area (mm ²)	Max HT	29.6
30%	46.0	60%	55.5		Unwound Core:	3400
35%	47.6	70%	59.3		40% Wound:	5700

Coating Temp: (Continuous, up to; °C) 200 °C

Notes:

