

ITEM NUMBER	CKT. SIZE	DIM. A	DIM. B	DIM. C	TERMINAL PLATING	PACKAGING SPECIFICATION
469862121	2	.138/[3.50]	.823/[20.90]	.071/[1.80]	OVERALL BRIGHT TIN	TRAY PACKAGING/PK-42819-2375
469862131	2	.138/[3.50]	.823/[20.90]	.071/[1.80]	SELECT GOLD / SELECT MATTE TIN	
469864331	4	.200/[5.10]	1.61/[40.90]	.133/[3.40]	SELECT GOLD / SELECT MATTE TIN	
469864431	4	.327/[8.30]	1.610/[40.90]	.259/[6.58]	SELECT GOLD / SELECT MATTE TIN	

- NOTES:**
- MATERIAL:  
HOUSING MATERIAL: LCP, GLASS FILLED, UL94V-0. COLOR: BLACK.  
TERMINAL MATERIAL: COPPER
  - FINISH: 2 = .000100/(.00254) MIN. TIN  
OVER .000050/(.00127) MIN. NICKEL. (SEE NOTE 10)  
3 = .000030/(.00076) MIN. SELECT GOLD IN CONTACT AREA.  
.000100/(.00254) MIN. SELECT TIN ON SOLDER TAILS  
OVER .000050/(.00127) MIN. NICKEL.
  - PRODUCT SPECIFICATION: PS-42815-001
  - PACKAGING INFORMATION: SEE CHART.
  - PART MATES WITH MOLEX RECEPTACLE #42816-\*\*\*2 WITH T.P.A.
  - PART IS DESIGNED IN METRIC.
  - AN "X" IN FRONT OF THE ITEM NUMBER INDICATES THE PART IS NOT TOOLED.
  - PARTS ARE NOT TO BE MATED OR UNMATED WHILE CIRCUITS ARE LIVE.
  - WHEN USING OVERALL TIN PLATED TERMINALS; FOR APPLICATIONS INVOLVING VIBRATION AND/OR THERMAL CYCLING, MOLEX STRONGLY RECOMMENDS THE USE OF NYE LUBRICANT (NYOGEL 760G) ON THE MATING SURFACES. REF. AS-42815-001.
  - PARTS CONFORM TO CLASS 'B' REQUIREMENTS OF COSMETIC SPECIFICATION PS-45499-002.

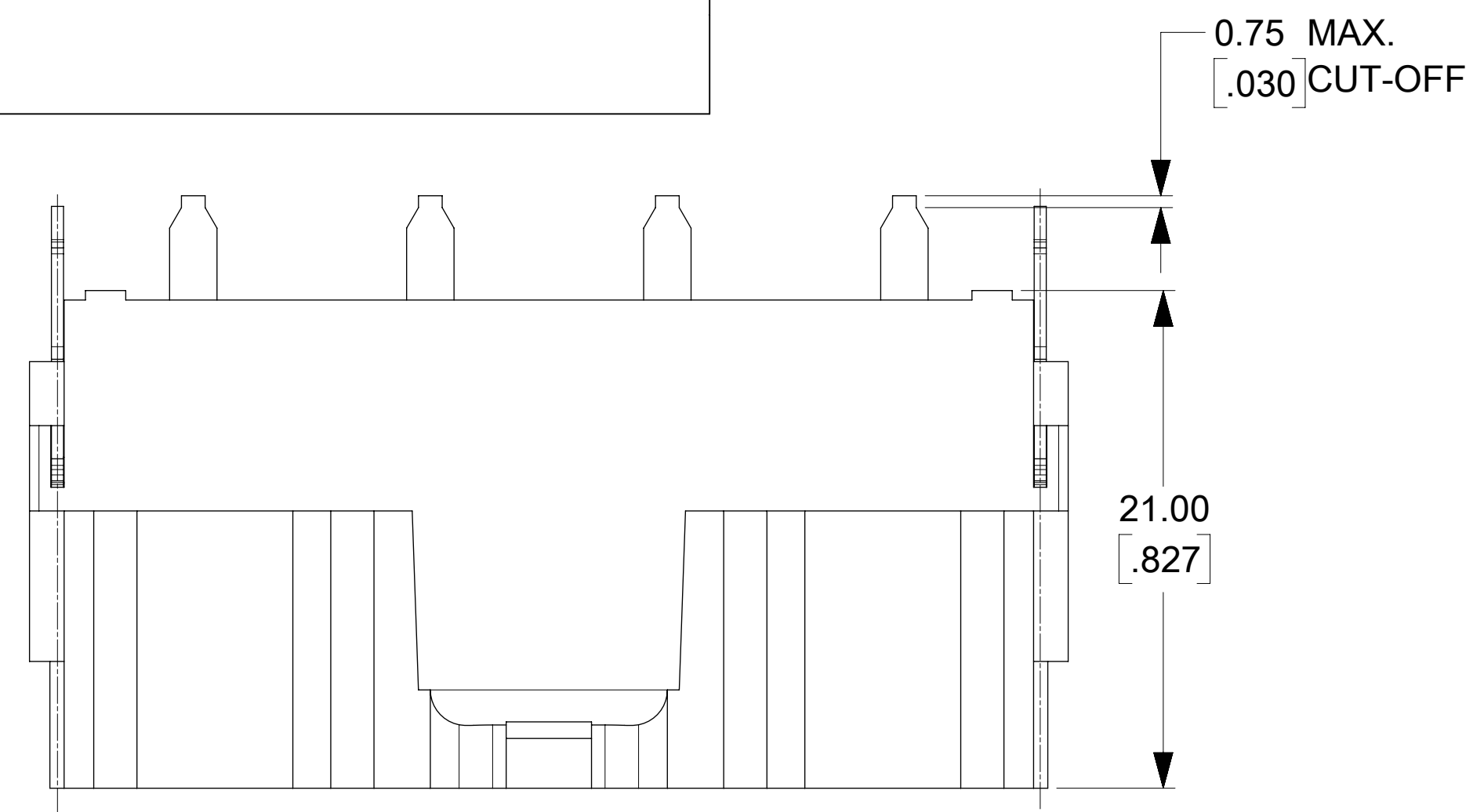

**LEGEND:**

A - 46986 - \* \* \* \*

CIRCUIT SIZE (2-6)

P.C. BOARD THICKNESS  
1 = .062/(1.57) NOMINAL  
2 = .093/(2.36) NOMINAL  
3 = .125/(3.18) NOMINAL  
4 = .250/(6.35) NOMINAL

PACKAGING  
1) = TRAY  
2) = TUBE  
3) = TAPE & REEL  
4) = HARD TRAY

PLATING  
2 OR 9 = PURE BRIGHT TIN OVER NICKEL  
3 OR 8 = SELECT GOLD AND SELECT PURE MATTE TIN OVER NICKEL  
7 = PURE MATTE TIN OVER NICKEL

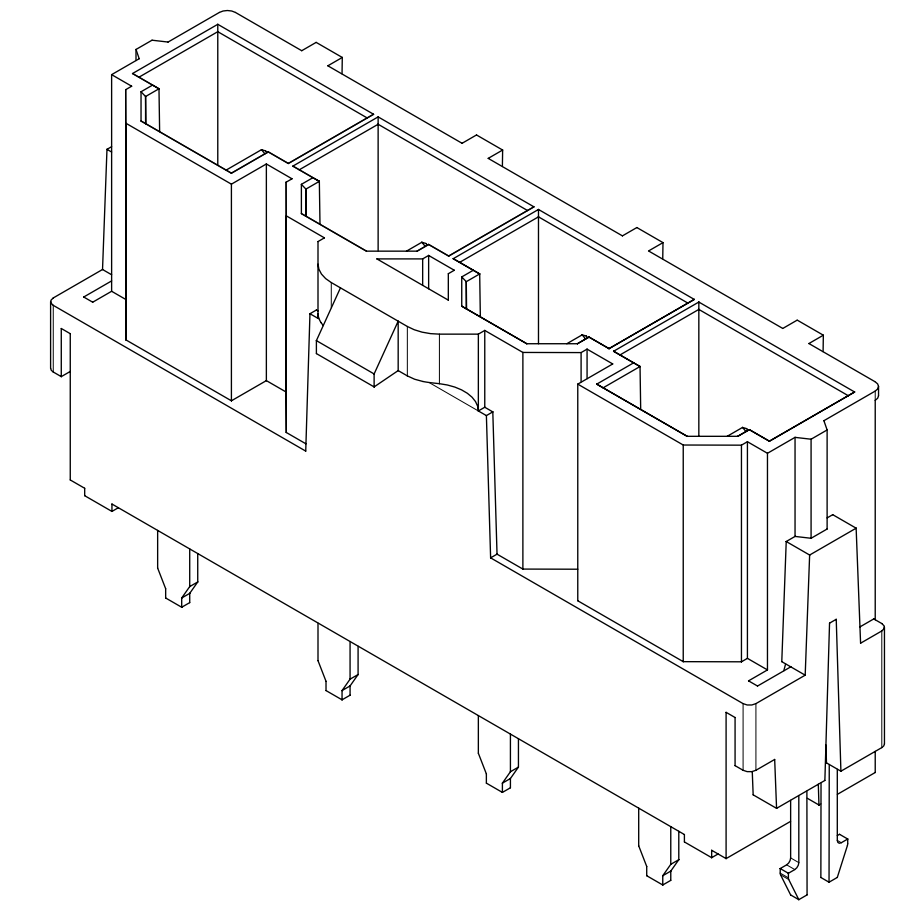
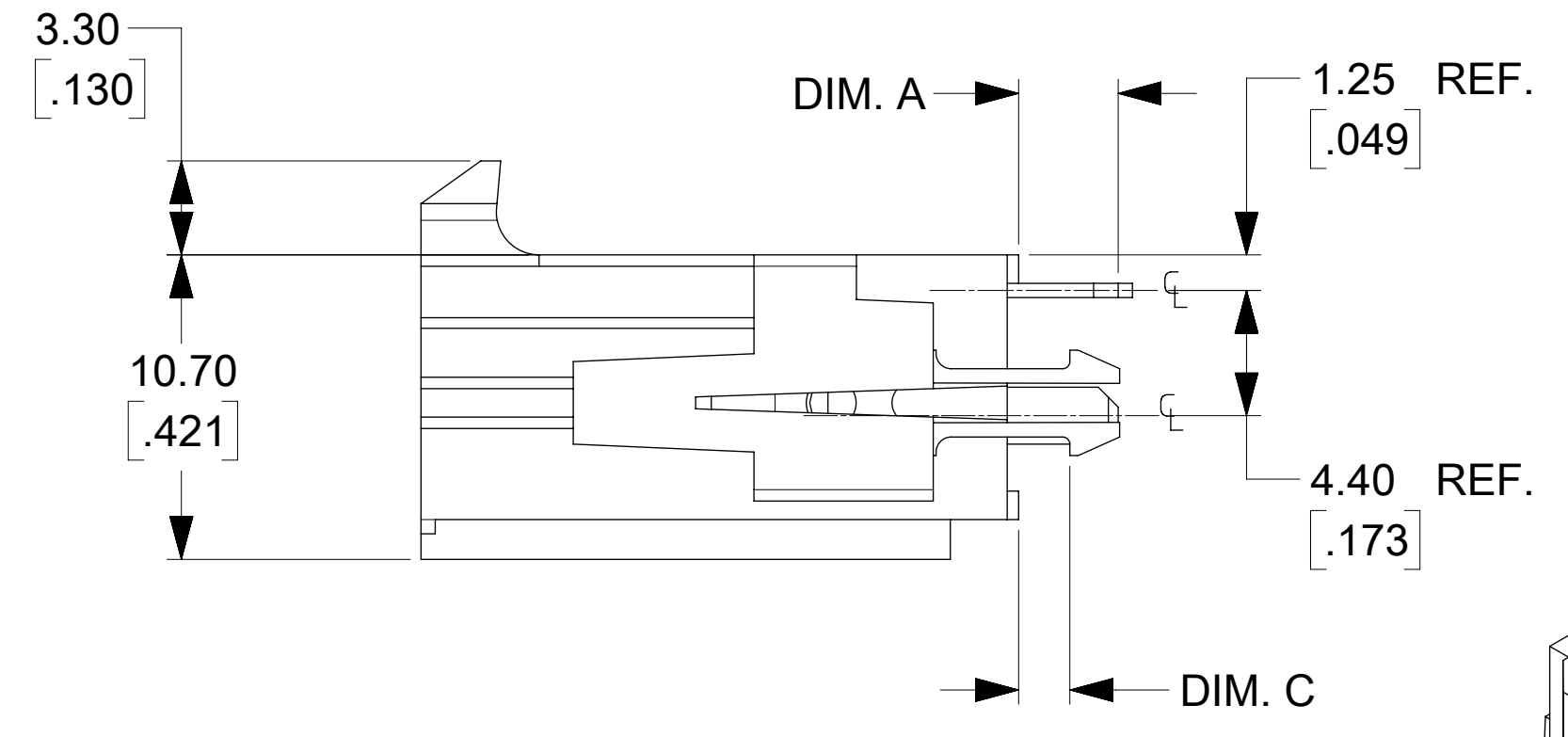
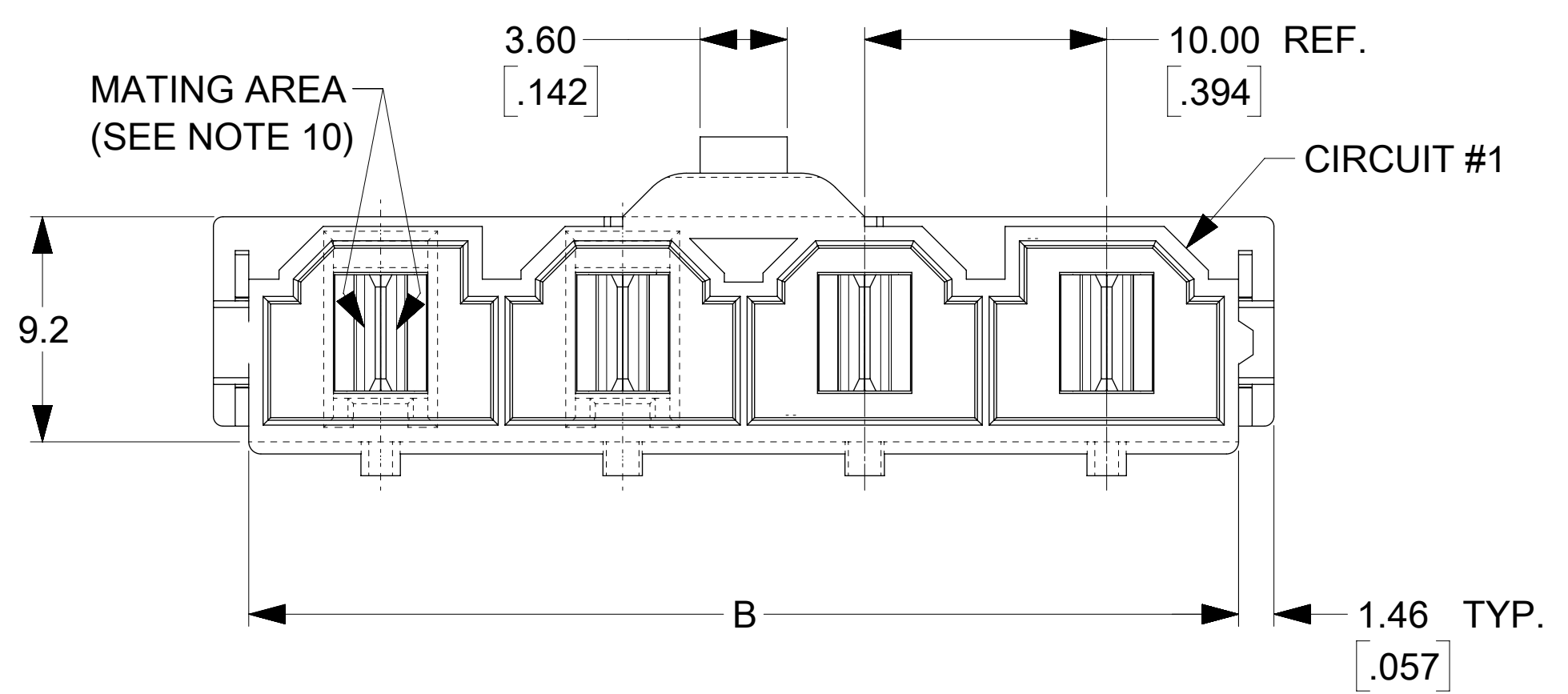

HEADER WITH VERTICAL TERMINAL & CLIP  
ISO VIEW

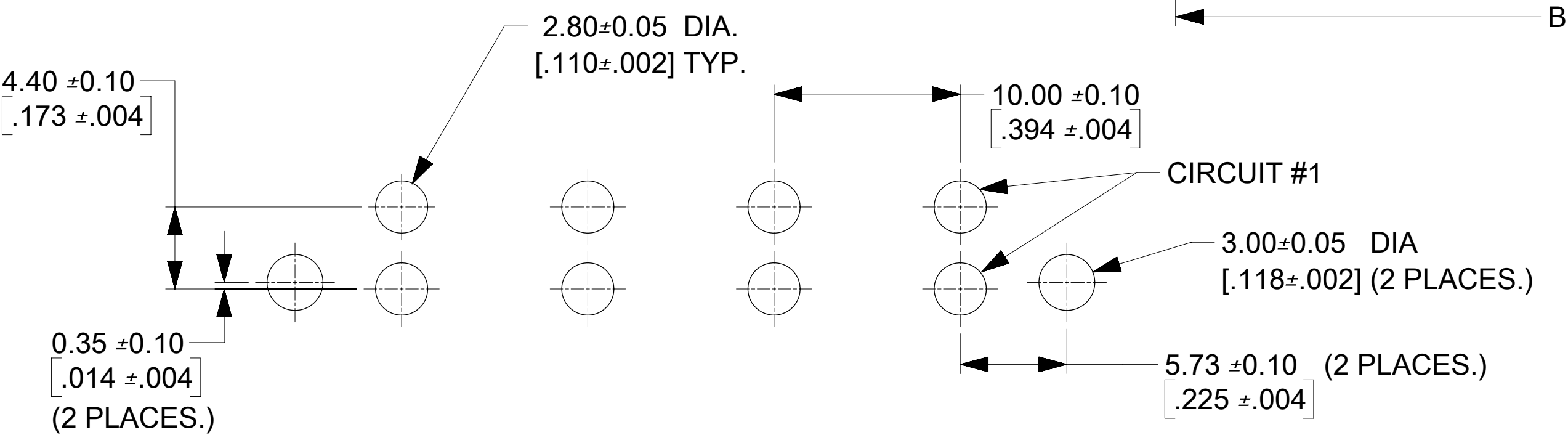

RECOMMENDED P.C. BOARD PLATED-THRU HOLE LAYOUT  
(4 CKT. SHOWN FOR REF.)

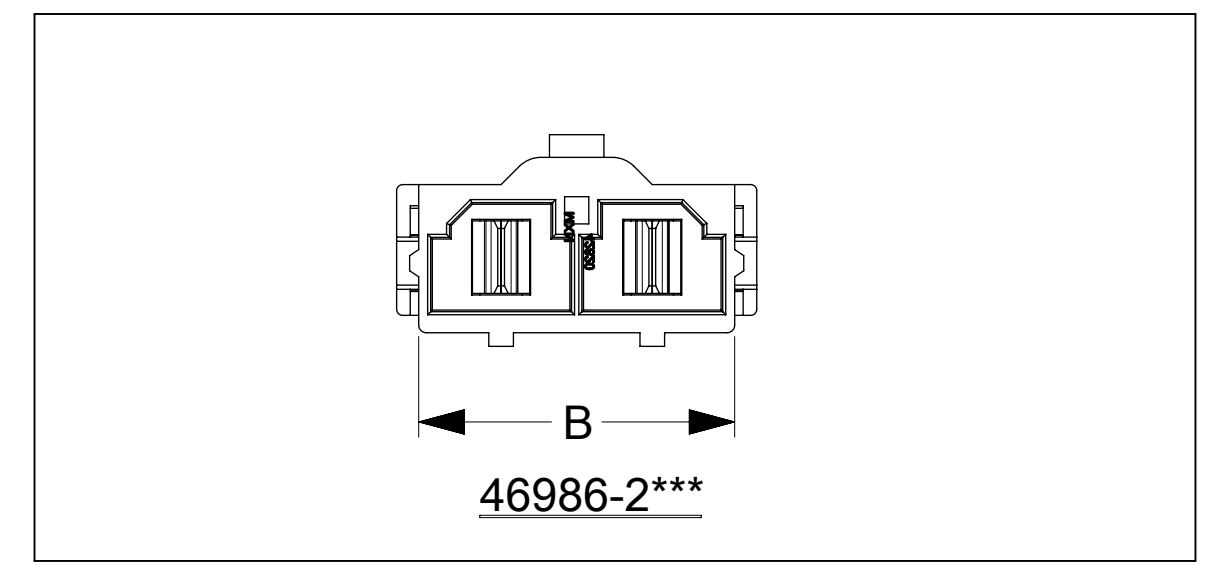

THIS DRAWING CONTAINS INFORMATION THAT IS PROPRIETARY TO MOLEX ELECTRONIC TECHNOLOGIES, LLC AND SHOULD NOT BE USED WITHOUT WRITTEN PERMISSION									
DIMENSION UNITS <b>IN/MM</b>		SCALE <b>4:1</b>		CURRENT REV DESC:					
GENERAL TOLERANCES (UNLESS SPECIFIED)				EC NO: 644976		DRWN: KCHIKKANNA		2020/09/03	
4 PLACES ±		±		CHK'D: KCHIKKANNA		2020/09/09		APPR: ISHWARG	
3 PLACES ±		0.25 ±		INITIAL REVISION:		DRWN: AELHAG		2008/05/13	
2 PLACES ±		0.4 ±		DRWN: AELHAG		2014/02/18		APPR: FSMITH	
1 PLACE ±		0.5 °		DRAFT WHERE APPLICABLE MUST REMAIN WITHIN DIMENSIONS		THIRD ANGLE PROJECTION		DRAWING SERIES	
0 PLACES ±				D-SIZE		46986		MATERIAL NUMBER CUSTOMER SHEET NUMBER	
				SEE CHART		GENERAL MARKET		1 OF 1	

**molex**

VERTICAL  
HEADER ASSEMBLY MINIFIT SR. SERIES

PRODUCT CUSTOMER DRAWING

DOCUMENT NUMBER: SDA-46986-001  
DOC TYPE: PSD  
DOC PART: 001  
REVISION: E