

LOC	DIST	REVISIONS			
P	LTR	DESCRIPTION	DATE	DWN	APVD
A1	-	A1	CHANGE TO TE STYLE	10.10.2005	M.S G.F

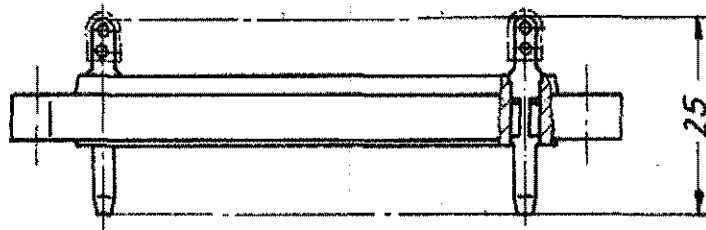

Manufacturer's code  
Herstellungskennzeichen

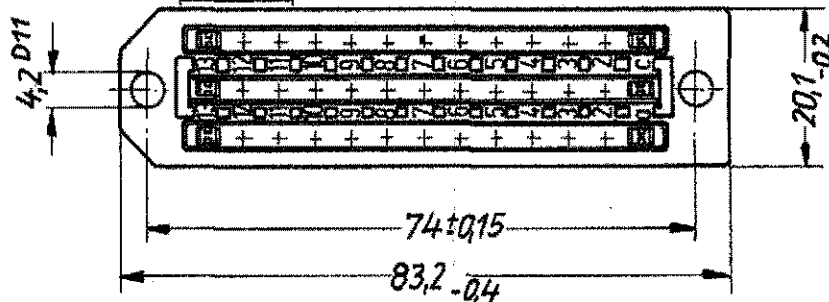

ON THIS MATCHES: 2-1393725-1 (OLD PN: C42334-A49-A6)  
EQUAL TO: DIN 41618  
SPECIFIED DIMENSIONS ARE MOUNTING DIMENSIONS

HIERZU PASST PN: 2-1393725-1  
ENTSPRICHT: DIN 41618  
ANGEGEBENE MAÖE SIND EINBAUMAÖE

REPLACEMENT FOR EC-DRAWING: C42334-A49-A5-\* -6  
ERSATZ FÜR EC - ZEICHNUNG:

2009

RELEASED FOR PUBLICATION

THIS DRAWING IS UNPUBLISHED.

© COPYRIGHT 2009 BY TYCO ELECTRONICS CORPORATION. ALL RIGHTS RESERVED.

DIMENSIONS: mm	DWN	M.SCHLEIHAUF	10.10.2005	MATERIAL	-	FINISH	-
	CHK	G.ÄCKERMANN	10.10.2005	Tyco Electronics Tyco Electronics AMP GmbH 64625 Bensheim (Germany)			
TOLERANCES UNLESS OTHERWISE SPECIFIED:	APVD	G.FELDMEIER	-				
0 PLC ±	PRODUCT SPEC	NAME PLUG CONNECTOR 39-point STECKVERBINDER 39-POLIG					
1 PLC ±	APPLICATION SPEC	SIZE	CAGE CODE	DRAWING NO	RESTRICTED TO		
2 PLC ±		A 4	00779	C=1-1393726-8	-		
3 PLC ±	WEIGHT	CUSTOMER DRAWING					
4 PLC ±		SCALE	1:1		SHEET	1	OF 1
ANGLES ±°				REV	A1		