

PART NUMBER	REV	TERMINATOR	FEED TYPE	DESCRIPTION
1528898-1	B	LEADMAKER	MECH POST FEED	CUTS CARRIER
1528898-2	B	BENCH	MECH PRE FEED	CUTS CARRIER
1528898-6	B	LEADMAKER	MECH POST FEED	CONTINUOUS CARRIER
7-1528898-1	B	LEADMAKER	MECH POST FEED	-1 AND SPARE PARTS
7-1528898-2	B	BENCH	MECH PRE FEED	-2 AND SPARE PARTS
7-1528898-6	B	LEADMAKER	MECH POST FEED	-6 AND SPARE PARTS
7-1528898-7	A	-	-	SPARE PARTS KIT

CRIMP	SIZE	TYPE	RANGE
WIRE	2.95 [1.16 IN]	F	1.00-2.00mm ²
INSUL	4.27 [1.68 IN]	O	3.96 MAX [1.56 IN MAX]
WIRE STRIP LENGTH	5.60 [1.220 IN]		

TE TERM PN	MANUF TERM PN	TE SEAL PN	MANUF SEAL PN
286510-1	12124580	286965-1	12015323
286638-1	12124582	286965-1	12015323

WIRE SIZE	CRIMP HEIGHT	REF SETTING
2.00mm ²	1.55 ± 0.05 [0.061 ± 0.002 IN]	C 3
1.50mm ²	1.45 ± 0.05 [0.057 ± 0.002 IN]	D 1
1.00mm ²	1.40 ± 0.05 [0.055 ± 0.002 IN]	D 3

- 1. RECOMMENDED SPARE PARTS.
- 2. GREASE RAM, CAM, CAM FOLLOWER AND FEED ROD LIGHTLY.
- 3. CERTAIN TERMINALS REQUIRE LUBRICATION. REFER TO THE APPLICATOR INSTRUCTION SHEET FOR MORE INFORMATION.
- 4. LUBRICATE DAILY PER THE APPLICATOR INSTRUCTION SHEET SUPPLIED WITH THE APPLICATOR.
- 5. THIS APPLICATOR APPLIES TERMINAL WITH A SEAL. INSULATION DIA QUOTED IS THAT OF THE TERMINAL. WIRE INSULATION DIA IS DEPENDENT ON SEAL BEING APPLIED. SEAL PN 286965-1 INS. DIA RANGE IS 2.03-2.85 [0.080-.112 IN].
- 6. APPLY TORQ-SEAL IN ALLEN SOCKET TO FILL HOLE AFTER FLAT HD HAS BEEN ADJUSTED TO CORRECT HEIGHT AT QUALIFICATION. APPLY #1-23419-5 LOC-TITE TO THREADS.
- 7. ALL CRIMP DATA SUPPLIED BY THE TERMINAL MANUFACTURER.
- 8. TERMINAL MANUFACTURERS INSULATION CRIMP HEIGHT IS NOT RECOMMENDED BY TYCO ELECTRONICS UK LTD.

*** WARNING**
ON INSTALLATION, SET WIRE DISC TO LARGEST WIRE SIZE SETTING. USE OF SETTINGS BELOW MIN. REQUIRED CRIMP HEIGHT SETTING WILL CAUSE DAMAGE TO CRIMP TOOLING.

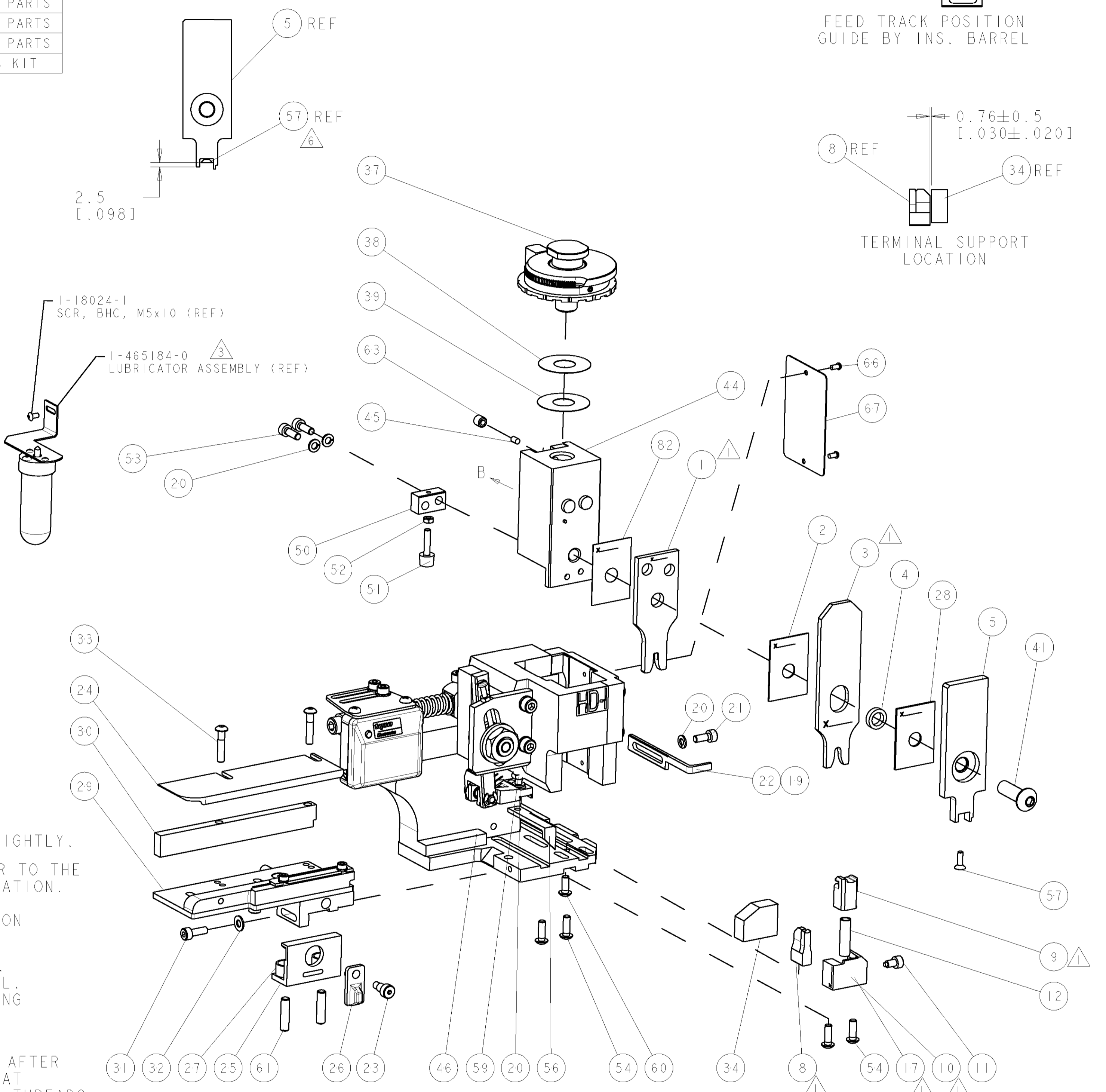
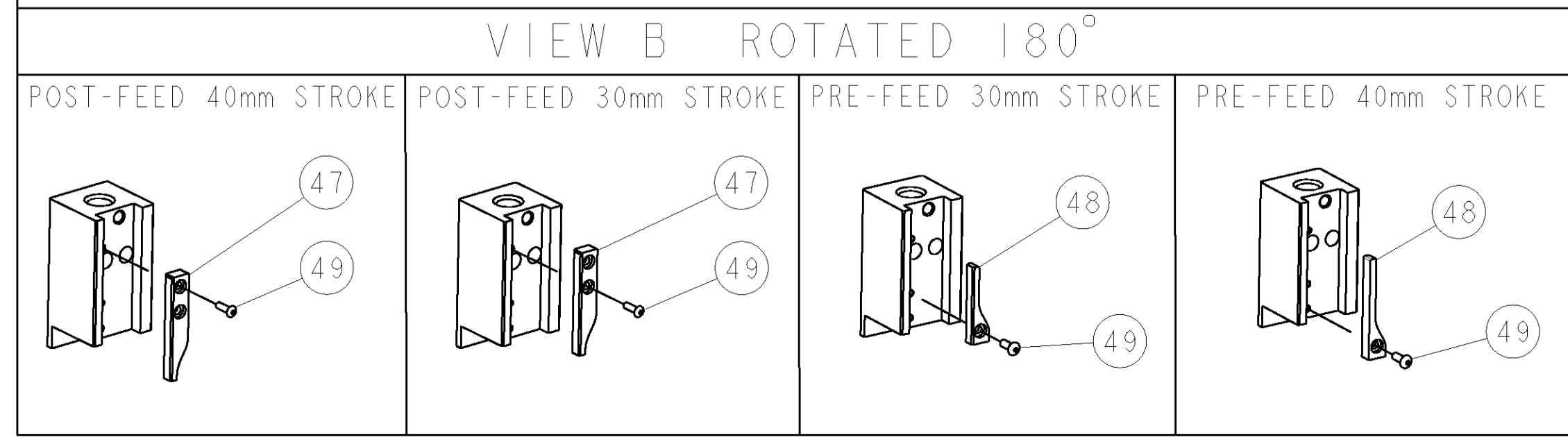

REV	DATE	BY	CHKD	APPVD
A	05JUN2008	LJL	MC	
B	11NOV2009	MY	TE	

REV	DATE	BY	CHKD	APPVD	DESCRIPTION	ITEM NO	
-	-	-	-	-	-	73	
-	-	-	-	-	-	72	
-	1	1	1	1	1338705-3	DOCUMENTATION PACKAGE	71
-	-	-	-	-	-	70	
-	-	-	-	-	-	69	
-	-	-	-	-	-	68	
-	1	1	1	1	461264-5	PLATE, IDENTIFICATION	67
-	2	2	2	2	21017-2	SCREW, DRIVE	66
-	-	-	-	-	-	65	
-	-	-	-	-	-	64	
-	1	1	1	1	3-18031-0	SCR, SET, CUP POINT M6 X 6.0	63
-	-	-	-	-	-	62	
-	2	2	2	2	2-18032-5	SCR, SET, FLT POINT M5 X 20.0	61
-	1	1	1	1	18024-7	SCR, BTN SKT HD CAP (M4 X 10.0)	60
-	1	1	1	1	5-18022-2	SCR, HEX HD CAP M4 X 8.0	59
-	-	-	-	-	-	58	
-	1	1	1	1	985575-3	SCR, FLT SKT HD CAP M3 X 10.0	57
-	1	1	1	1	1338685-1	PAWL, FEED	56
-	-	-	-	-	-	55	
-	4	4	4	4	18024-8	SCR, BTN SKT HD CAP (M4 X 12.0)	54
-	2	2	2	2	1-18023-2	SCR, SKT HD CAP M4 X 12.0	53
-	1	1	1	1	18030-1	NUT, HEX, REG M3	52
-	1	1	1	1	811242-5	BUMPER, HOLD DOWN	51
-	1	1	1	1	690753-2	SPACER, TONKER	50
-	1	1	1	1	18024-3	SCR, BTN SKT HD CAP (M3 X 10.0)	49
-	1	1	1	1	1338675-1	CAM, UNIVERSAL PRE FEED	48
-	1	1	1	1	1338676-1	CAM, UNIVERSAL POST-FEED	47
-	1	1	1	1	1320999-4	APPLICATOR SUBASSEMBLY, HDI	46
-	1	1	1	1	690191-1	PLUG, NYLON	45
-	1	1	1	1	1338660-1	RAM	44
-	-	-	-	-	-	43	
-	-	-	-	-	-	42	
-	1	1	1	1	2-18024-6	SCR, BTN SKT HD CAP (M8 X 25.0)	41
-	-	-	-	-	-	40	
-	1	1	1	1	690125-1	SHIM SUB-ASSY	39
-	1	1	1	1	469367-1	SHIM	38
-	1	1	1	1	879103-2	FINE ADJUST HEAD ASSEMBLY	37
-	-	-	-	-	-	36	
-	-	-	-	-	-	35	
-	1	1	1	1	1320934-1	SUPPORT, TERMINAL	34
-	2	2	2	2	1-18024-0	SCR, BTN SKT HD CAP (M4 X 20.0)	33
-	1	1	1	1	18027-2	WASHER, FLAT, REG M4	32
-	1	1	1	1	1-18023-2	SCR, SKT HD CAP M4 X 12.0	31
-	1	1	1	1	1320908-2	SPACER, STRIP GUIDE	30
-	1	1	1	1	1633073-1	STRIP GUIDE ASSEMBLY	29
-	1	1	1	1	455888-9	SPACER, CRIMPER	28
-	2	2	2	2	1-22284-0	SPRING, COMPRESSION	27
-	1	1	1	1	356835-1	LEVER, DRAG RELEASE	26
-	1	1	1	1	240792-1	DRAG, TERMINAL	25
-	1	1	1	1	1320928-1	PLATE, STRIP GUIDE	24
-	1	1	1	1	980371-4	SCR, SKT HD SHLDR 5.0 DIA X 6.0	23
-	1	1	1	1	690472-2	STRIPPER	22
-	1	1	1	1	1-18023-1	SCR, SKT HD CAP M4 X 10.0	21
-	4	4	4	4	18025-2	WASHER, SPRG LOCK, REG M4	20
-	1	1	1	1	690472-1	STRIPPER	19
-	-	-	-	-	-	18	
-	1	1	1	1	1338684-2	SHEAR HOLDER, FRONT	17
-	-	-	-	-	-	16	
-	-	-	-	-	-	15	
-	-	-	-	-	-	14	
-	-	-	-	-	-	13	
-	1	1	1	1	3-22280-3	SPRING, COMPRESSION	12
-	1	1	1	1	356885-5	STOP, SHEAR	11
-	1	1	1	1	1-1320921-0	SHEAR HOLDER, FRONT, CUT	10
-	1	1	1	1	318707-1	FLOATING SHEAR, FRONT	9
1	2	2	2	1	8-1633138-4	ANVIL, COMBINATION	8
-	-	-	-	-	-	7	
-	-	-	-	-	-	6	
-	1	1	1	1	1338680-1	DEPRESSOR, SHEAR	5
-	1	1	1	1	238011-2	BLOCK, CRIMPER SPACER	4
1	2	2	2	1	1-1633589-3	CRIMPER, INSUL O	3
-	1	1	1	1	455888-6	SPACER, CRIMPER	2
1	2	2	2	1	3-1633305-7	CRIMPER, WIRE PREMIUM	1

REV	DATE	BY	CHKD	APPVD	DESCRIPTION	ITEM NO	
-	-	-	-	-	-	84	
-	-	-	-	-	-	83	
-	1	1	1	1	455888-1	SPACER, CRIMPER	82
-	-	-	-	-	-	81	
-	-	-	-	-	-	80	
-	-	-	-	-	-	79	
-	-	-	-	-	-	78	
-	-	-	-	-	-	77	
-	-	-	-	-	-	76	
-	-	-	-	-	-	75	
-	-	-	-	-	-	74	
REV	DATE	BY	CHKD	APPVD	PART NO	DESCRIPTION	ITEM NO
-	-	-	-	-	-	-	-

THIS DRAWING IS UNPUBLISHED. RELEASED FOR PUBLICATION.

TYCO ELECTRONICS CORPORATION, ALL RIGHTS RESERVED.

LOC: A DIST: 66

REVISIONS:

REV	DATE	BY	CHKD	APPVD
A	05JUN2008	LJL	MC	
B	11NOV2009	MY	TE	

SET UP GAGE 458637-3

ITEM 30 LOCATED AT REAR HOLES

FEED TRACK POSITION GUIDE BY INS. BARREL

TERMINAL SUPPORT LOCATION

0.76 ± 0.5 [0.030 ± 0.020]

2.5 [0.098]

1-18024-1 SCR, BHC, M5x10 (REF)

1-465184-0 LUBRICATOR ASSEMBLY (REF)

VIEW B ROTATED 180°

POST-FEED 40mm STROKE

POST-FEED 30mm STROKE

PRE-FEED 30mm STROKE

PRE-FEED 40mm STROKE

* WARNING ON INSTALLATION, SET WIRE DISC TO LARGEST WIRE SIZE SETTING. USE OF SETTINGS BELOW MIN. REQUIRED CRIMP HEIGHT SETTING WILL CAUSE DAMAGE TO CRIMP TOOLING.

DIMENSIONS: mm [IN]

TOLERANCES UNLESS OTHERWISE SPECIFIED:

9 PLC ±

PLC ±

PLC ±

4 PLC ±

ANGLES ±

MATERIAL: FINISH:

SCALE: 3:5 SHEET 1 OF 1 REV B

CUSTOMER ACCESSIBLE PRODUCTION DRAWING