

76829-0106 SHOWN

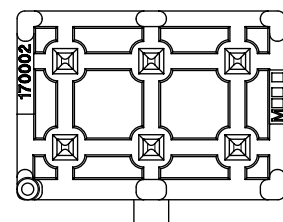
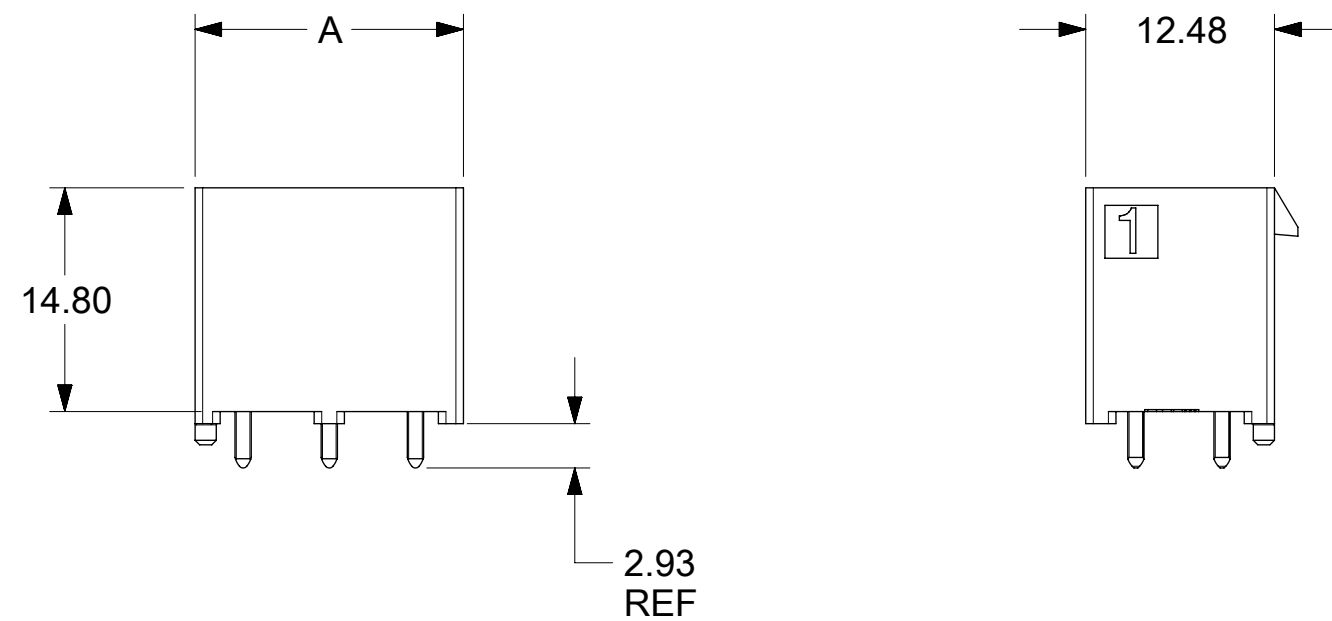

NOTES:

1. MATERIAL:  
HOUSING: LCP, UL94V-0, GLOW WIRE CAPABLE PER IEC-60335-1 5TH EDITION,  
COLOR: BLACK.  
TERMINAL: HIGH CONDUCTIVITY COPPER.
2. TERMINAL PLATING:  
(TIN) 1.52 MICROMETER /(60 MICROINCH) MIN REFLOWED MATTE TIN OVER  
1.27 MICROMETER /(50 MICROINCH) MIN NICKEL OVERALL.  
(15 GOLD) 0.38 MICROMETER /(15 MICROINCH) MIN SELECT GOLD ON CONTACT AREA  
2.54 MICROMETER /(100 MICROINCH) MIN SELECT MATTE TIN ON SOLDER AREA  
BOTH OVER 1.27 MICROMETER /(50 MICROINCH) MIN NICKEL OVERALL  
(30 GOLD) 0.76 MICROMETER /(30 MICROINCH) MIN SELECT GOLD ON CONTACT AREA  
2.54 MICROMETER /(100 MICROINCH) MIN SELECT MATTE TIN ON SOLDER AREA  
BOTH OVER 1.27 MICROMETER /(50 MICROINCH) MIN NICKEL OVERALL
3. PRODUCT SPECIFICATION:PS-76823-100/1720631000-PS
4. PART MATES WITH MOLEX PART NUMBER 170001 AND 171692 SERIES.
5. PACKAGING SPECIFICATION:768291100 (TRAY) , 1720659206-PK (T & R), AND 1720658000 (T&R W/ KAPTON)
6. APPLICATION SPECIFICATION:AS-76823-100/ 768232000-AS
7. PARTS CONFORM TO CLASS "B" REQUIREMENTS OF COSMETIC SPECIFICATION PS-45499-002.

THIS DRAWING CONTAINS INFORMATION THAT IS PROPRIETARY TO MOLEX ELECTRONIC TECHNOLOGIES, LLC AND SHOULD NOT BE USED WITHOUT WRITTEN PERMISSION

|  |  |       |  |                           |  |         |  |   |  |           |  |                |  |          |  |
|--|--|-------|--|---------------------------|--|---------|--|---|--|-----------|--|----------------|--|----------|--|
| DIMENSION UNITS                                      |  | SCALE |  | CURRENT REV DESC:         |  |         |  | <b>molex</b>  |  |           |  |                |  |          |  |
| mm   |  | NTS   |  |                           |  |         |  |   |  |           |  |                |  |          |  |
| GENERAL TOLERANCES (UNLESS SPECIFIED)                |  |       |  | EC NO: 722781             |  |         |  | MEGAFIT SLIM VERTICAL HEADER ASSY WITHOUT CRUSH PEGS 2-12 CKT |  |           |  |                |  |          |  |
| ANGULAR TOL ± 3.0°                                   |  |       |  | DRWN: WYATTH5 2022/10/14  |  |         |  |   |  |           |  |                |  |          |  |
| 4 PLACES ±   |  |       |  | CHK'D: XQZHANG 2022/10/27 |  |         |  | PRODUCT CUSTOMER DRAWING                                      |  |           |  |                |  |          |  |
| 3 PLACES ±   |  |       |  | APPR: XQZHANG 2022/10/27  |  |         |  |   |  |           |  |                |  |          |  |
| 2 PLACES ± 0.25                                      |  |       |  | INITIAL REVISION:         |  |         |  | DOCUMENT NUMBER   |  | DOC TYPE  |  | DOC PART       |  | REVISION |  |
| 1 PLACE ±  |  |       |  | DRWN: GSHARMA 2016/07/15  |  |         |  | 768290002   |  | PSD       |  | 000            |  | A5       |  |
| 0 PLACES ±   |  |       |  | APPR: KPRASAD 2017/07/21  |  |         |  | MATERIAL NUMBER   |  | CUSTOMER  |  | SHEET NUMBER   |  |          |  |
| DRAFT WHERE APPLICABLE MUST REMAIN WITHIN DIMENSIONS |  |       |  | THIRD ANGLE PROJECTION    |  | DRAWING |  | SERIES  |  | SEE TABLE |  | GENERAL MARKET |  | 1 OF 3   |  |

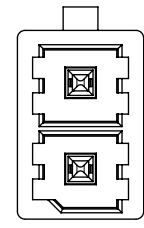

2 CKT

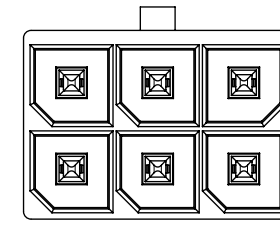

4-12 CKT

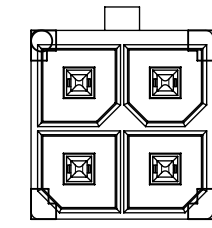

4 CKT

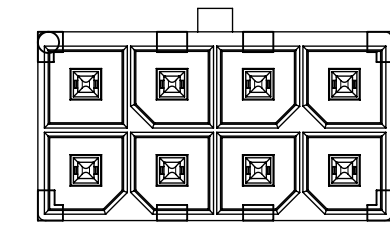
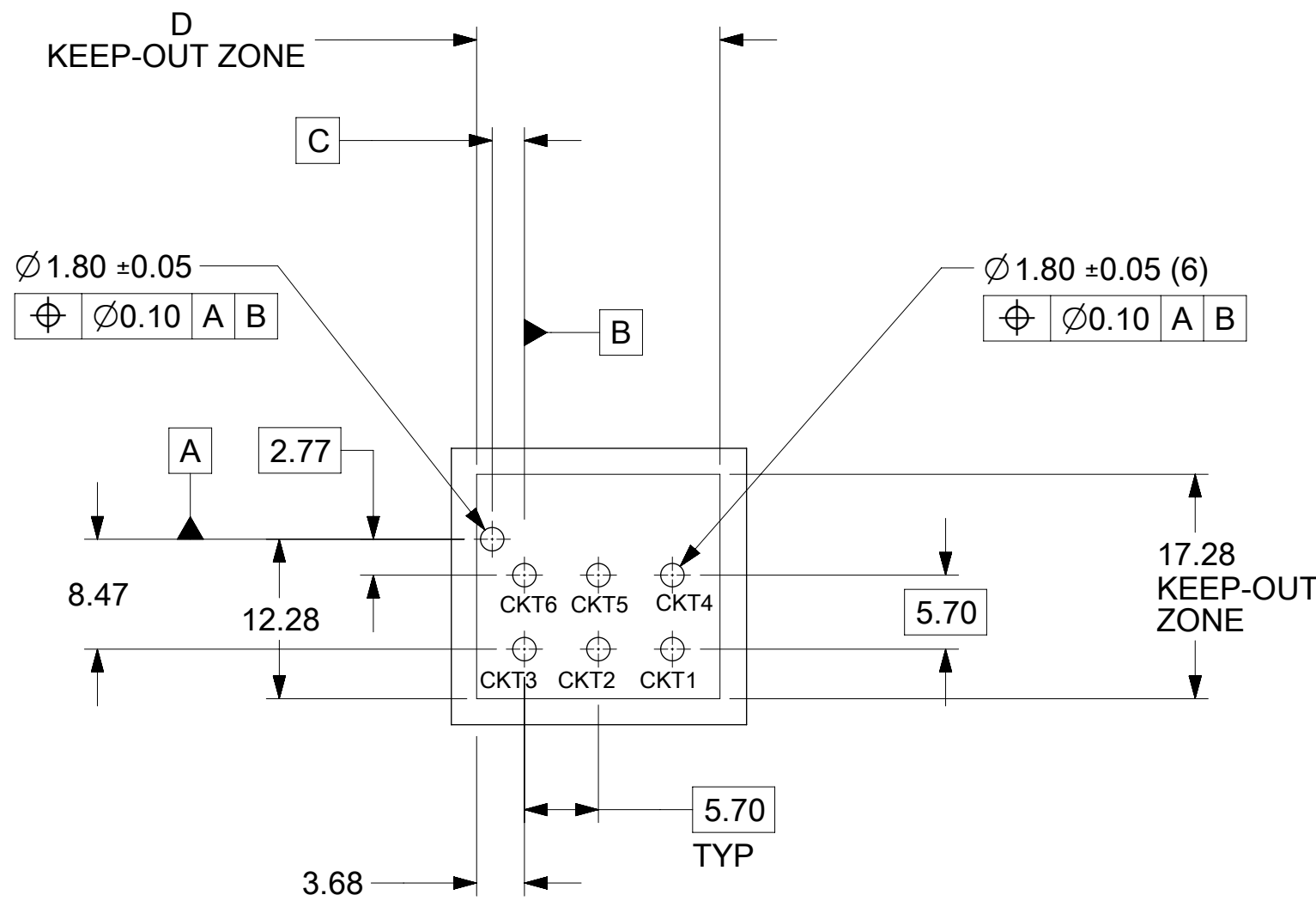
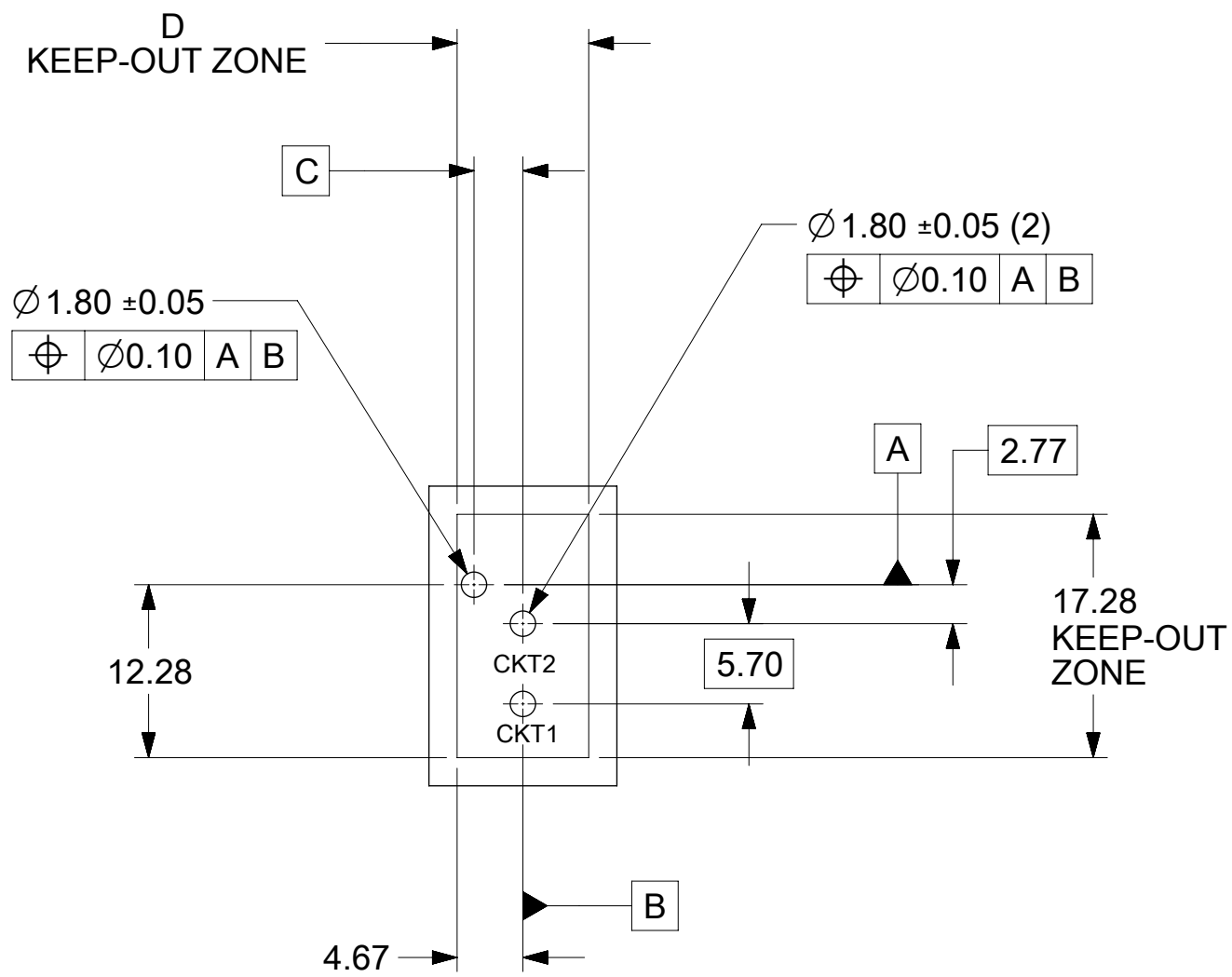

8 CKT

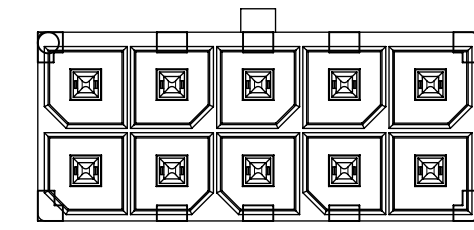

10 CKT

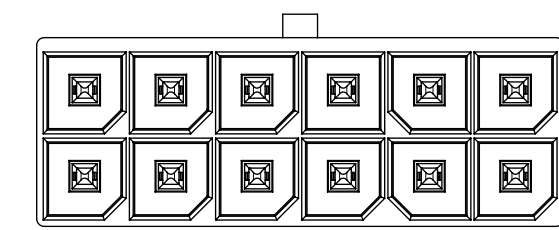

12 CKT

|   |  |                        |  |                           |  |              |  |   |  |
|---|--|------------------------|--|---------------------------|--|--------------|--|---|--|
| THIS DRAWING CONTAINS INFORMATION THAT IS PROPRIETARY TO MOLEX ELECTRONIC TECHNOLOGIES, LLC AND SHOULD NOT BE USED WITHOUT WRITTEN PERMISSION |  |                        |  |                           |  |              |  |   |  |
| DIMENSION UNITS   |  | SCALE                  |  | CURRENT REV DESC:         |  |              |  | <b>molex</b>  |  |
| mm  |  | NTS                    |  |                           |  |              |  |   |  |
| GENERAL TOLERANCES (UNLESS SPECIFIED)   |  |                        |  | EC NO: 722781             |  |              |  | MEGAFIT SLIM VERTICAL HEADER ASSY WITHOUT CRUSH PEGS 2-12 CKT |  |
| ANGULAR TOL $\pm 3.0^\circ$   |  |                        |  | DRWN: WYATTH5 2022/10/14  |  |              |  |   |  |
| 4 PLACES $\pm$  |  |                        |  | CHK'D: XQZHANG 2022/10/27 |  |              |  | PRODUCT CUSTOMER DRAWING                                      |  |
| 3 PLACES $\pm$  |  |                        |  | APPR: XQZHANG 2022/10/27  |  |              |  |   |  |
| 2 PLACES $\pm 0.25$   |  |                        |  | INITIAL REVISION:         |  |              |  | DOCUMENT NUMBER   |  |
| 1 PLACE $\pm$   |  |                        |  | DRWN: GSHARMA 2016/07/15  |  |              |  | 768290002   |  |
| 0 PLACES $\pm$  |  |                        |  | APPR: KPRASAD 2017/07/21  |  |              |  | PSD 000 A5  |  |
| DRAFT WHERE APPLICABLE MUST REMAIN WITHIN DIMENSIONS  |  | THIRD ANGLE PROJECTION |  | DRAWING                   |  | SERIES       |  | MATERIAL NUMBER   |  |
|   |  |                        |  | C-SIZE                    |  | 76829        |  | SEE TABLE   |  |
| DOCUMENT STATUS   |  | RELEASE DATE           |  | CUSTOMER                  |  | SHEET NUMBER |  |   |  |
| P1  |  | 2022/10/27 06:33:11    |  | GENERAL MARKET            |  | 2 OF 3       |  |   |  |

| CKT SIZE | PART NO.    | PLATING | DIM A | DIM C BASIC | DIM D | PK SPEC |
|----------|-------------|---------|-------|-------------|-------|---------|
| 2        | 76829-0102  | TIN     | 8.35  | 3.48        | 9.35  | TRAY    |
| 4        | 76829-0104  | TIN     | 12.05 | 2.48        | 13.05 |         |
| 6        | 76829-0106  | TIN     | 17.75 | 2.48        | 18.75 |         |
| 8        | 76829-0108  | TIN     | 23.45 | 2.48        | 24.45 |         |
| 10       | 76829-0110  | TIN     | 29.15 | 2.48        | 30.15 |         |
| 12       | 76829-0112  | TIN     | 34.85 | 2.48        | 35.85 |         |
| 2        | 172065-0202 | 15 GOLD | 8.35  | 3.48        | 9.35  |         |
| 4        | 172065-0204 | 15 GOLD | 12.05 | 2.48        | 13.05 |         |
| 6        | 172065-0206 | 15 GOLD | 17.75 | 2.48        | 18.75 |         |
| 8        | 172065-0208 | 15 GOLD | 23.45 | 2.48        | 24.45 |         |
| 10       | 172065-0210 | 15 GOLD | 29.15 | 2.48        | 30.15 |         |
| 12       | 172065-0212 | 15 GOLD | 34.85 | 2.48        | 35.85 |         |
| 2        | 172065-0302 | 30 GOLD | 8.35  | 3.48        | 9.35  |         |
| 4        | 172065-0304 | 30 GOLD | 12.05 | 2.48        | 13.05 |         |
| 6        | 172065-0306 | 30 GOLD | 17.75 | 2.48        | 18.75 |         |
| 8        | 172065-0308 | 30 GOLD | 23.45 | 2.48        | 24.45 |         |
| 10       | 172065-0310 | 30 GOLD | 29.15 | 2.48        | 30.15 |         |
| 12       | 172065-0312 | 30 GOLD | 34.85 | 2.48        | 35.85 |         |

| CKT SIZE | PART NO. | PLATING     | DIM A   | DIM C BASIC | DIM D | PK SPEC                     |       |
|----------|----------|-------------|---------|-------------|-------|-----------------------------|-------|
| *        | 2        | 76829-9102  | TIN     | 8.35        | 3.48  | TAPE&REEL<br>WITHOUT KAPTON |       |
| *        | 4        | 76829-9104  | TIN     | 12.05       | 2.48  |                             | 13.05 |
| *        | 6        | 76829-9106  | TIN     | 17.75       | 2.48  |                             | 18.75 |
| *        | 8        | 76829-9108  | TIN     | 23.45       | 2.48  |                             | 24.45 |
| *        | 10       | 76829-9110  | TIN     | 29.15       | 2.48  |                             | 30.15 |
| *        | 12       | 76829-9112  | TIN     | 34.85       | 2.48  |                             | 35.85 |
| *        | 2        | 172065-9202 | 15 GOLD | 8.35        | 3.48  |                             | 9.35  |
| *        | 4        | 172065-9204 | 15 GOLD | 12.05       | 2.48  |                             | 13.05 |
| *        | 6        | 172065-9206 | 15 GOLD | 17.75       | 2.48  |                             | 18.75 |
| *        | 8        | 172065-9208 | 15 GOLD | 23.45       | 2.48  |                             | 24.45 |
| *        | 10       | 172065-9210 | 15 GOLD | 29.15       | 2.48  |                             | 30.15 |
| *        | 12       | 172065-9212 | 15 GOLD | 34.85       | 2.48  |                             | 35.85 |
| *        | 2        | 172065-9302 | 30 GOLD | 8.35        | 3.48  |                             | 9.35  |
| *        | 4        | 172065-9304 | 30 GOLD | 12.05       | 2.48  |                             | 13.05 |
| *        | 6        | 172065-9306 | 30 GOLD | 17.75       | 2.48  |                             | 18.75 |
| *        | 8        | 172065-9308 | 30 GOLD | 23.45       | 2.48  |                             | 24.45 |
| *        | 10       | 172065-9310 | 30 GOLD | 29.15       | 2.48  |                             | 30.15 |
| *        | 12       | 172065-9312 | 30 GOLD | 34.85       | 2.48  |                             | 35.85 |

| CKT SIZE | PART NO. | PLATING     | DIM A   | DIM C BASIC | DIM D | PK SPEC                  |       |
|----------|----------|-------------|---------|-------------|-------|--------------------------|-------|
| *        | 2        | 76829-8102  | TIN     | 8.35        | 3.48  | TAPE&REEL<br>WITH KAPTON |       |
| *        | 4        | 76829-8104  | TIN     | 12.05       | 2.48  |                          | 13.05 |
| *        | 6        | 76829-8106  | TIN     | 17.75       | 2.48  |                          | 18.75 |
| *        | 8        | 76829-8108  | TIN     | 23.45       | 2.48  |                          | 24.45 |
| *        | 10       | 76829-8110  | TIN     | 29.15       | 2.48  |                          | 30.15 |
| *        | 12       | 76829-8112  | TIN     | 34.85       | 2.48  |                          | 35.85 |
| *        | 2        | 172065-8202 | 15 GOLD | 8.35        | 3.48  |                          | 9.35  |
| *        | 4        | 172065-8204 | 15 GOLD | 12.05       | 2.48  |                          | 13.05 |
| *        | 6        | 172065-8206 | 15 GOLD | 17.75       | 2.48  |                          | 18.75 |
| *        | 8        | 172065-8208 | 15 GOLD | 23.45       | 2.48  |                          | 24.45 |
| *        | 10       | 172065-8210 | 15 GOLD | 29.15       | 2.48  |                          | 30.15 |
| *        | 12       | 172065-8212 | 15 GOLD | 34.85       | 2.48  |                          | 35.85 |
| *        | 2        | 172065-8302 | 30 GOLD | 8.35        | 3.48  |                          | 9.35  |
| *        | 4        | 172065-8304 | 30 GOLD | 12.05       | 2.48  |                          | 13.05 |
| *        | 6        | 172065-8306 | 30 GOLD | 17.75       | 2.48  |                          | 18.75 |
| *        | 8        | 172065-8308 | 30 GOLD | 23.45       | 2.48  |                          | 24.45 |
| *        | 10       | 172065-8310 | 30 GOLD | 29.15       | 2.48  |                          | 30.15 |
| *        | 12       | 172065-8312 | 30 GOLD | 34.85       | 2.48  |                          | 35.85 |

\* DESIGNATES PART NOT RELEASED  
CONTACT FACTORY FOR AVAILABILITY.

|   |  |                        |  |                           |  |        |  |  |  |
|---|--|------------------------|--|---------------------------|--|--------|--|--|--|
| THIS DRAWING CONTAINS INFORMATION THAT IS PROPRIETARY TO MOLEX ELECTRONIC TECHNOLOGIES, LLC AND SHOULD NOT BE USED WITHOUT WRITTEN PERMISSION |  |                        |  |                           |  |        |  |  |  |
| DIMENSION UNITS   |  | SCALE                  |  | CURRENT REV DESC:         |  |        |  | <b>molex</b>   |  |
| mm  |  | NTS                    |  |                           |  |        |  |  |  |
| GENERAL TOLERANCES (UNLESS SPECIFIED)   |  |                        |  | EC NO: 722781             |  |        |  | MEGAFIT SLIM VERTICAL HEADER ASSY<br>WITHOUT CRUSH PEGS 2-12 CKT |  |
| ANGULAR TOL ± 3.0°  |  |                        |  | DRWN: WYATTH5 2022/10/14  |  |        |  |  |  |
| 4 PLACES ±  |  |                        |  | CHK'D: XQZHANG 2022/10/27 |  |        |  | PRODUCT CUSTOMER DRAWING   |  |
| 3 PLACES ±  |  |                        |  | APPR: XQZHANG 2022/10/27  |  |        |  |  |  |
| 2 PLACES ± 0.25   |  |                        |  | INITIAL REVISION:         |  |        |  | DOCUMENT NUMBER  |  |
| 1 PLACE ±   |  |                        |  | DRWN: GSHARMA 2016/07/15  |  |        |  | 768290002  |  |
| 0 PLACES ±  |  |                        |  | APPR: KPRASAD 2017/07/21  |  |        |  | PSD 000 A5   |  |
| DRAFT WHERE APPLICABLE<br>MUST REMAIN WITHIN DIMENSIONS   |  | THIRD ANGLE PROJECTION |  | DRAWING                   |  | SERIES |  | MATERIAL NUMBER  |  |
|   |  |                        |  | C-SIZE                    |  | 76829  |  | SEE TABLE  |  |
|   |  |                        |  |                           |  |        |  | CUSTOMER   |  |
|   |  |                        |  |                           |  |        |  | GENERAL MARKET   |  |
|   |  |                        |  |                           |  |        |  | SHEET NUMBER   |  |
|   |  |                        |  |                           |  |        |  | 3 OF 3   |  |