

NEMA L6-30 PRIMARY  
WOODHEAD #28W48 PLUG  
COLOR-YELLOW

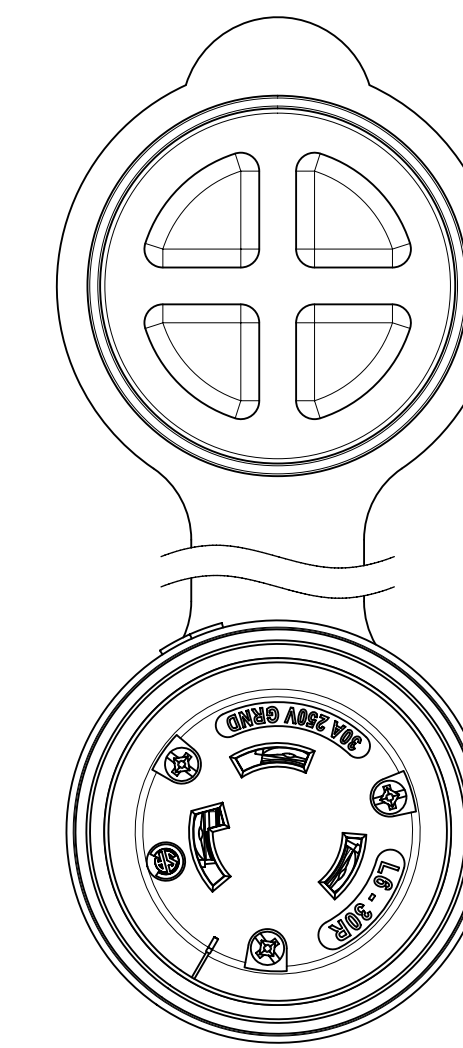

NEMA L6-30 SECONDARY  
WOODHEAD #29W48 CONNECTOR  
COLOR-YELLOW

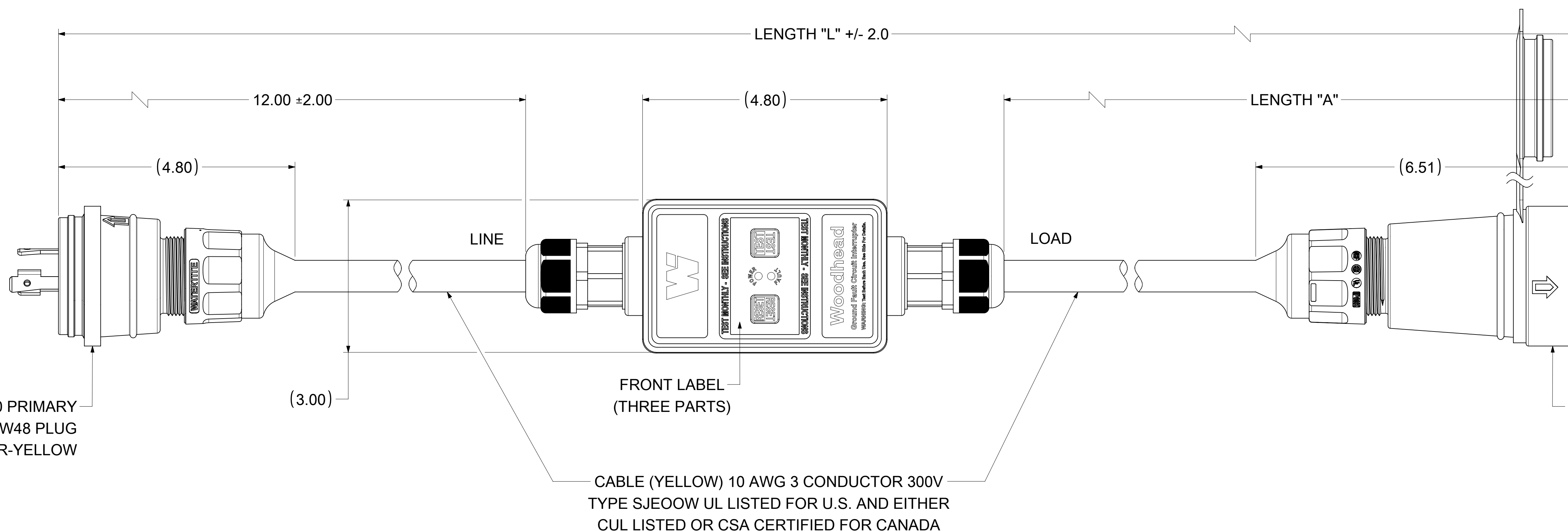
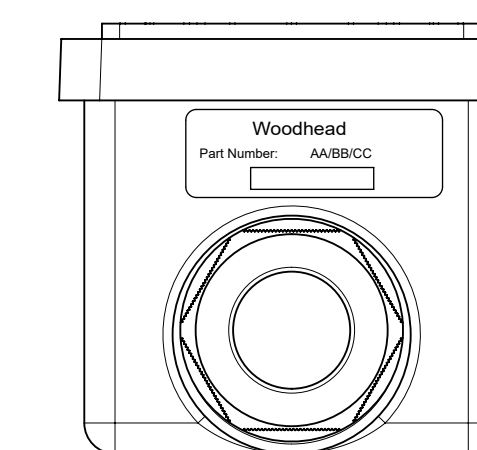
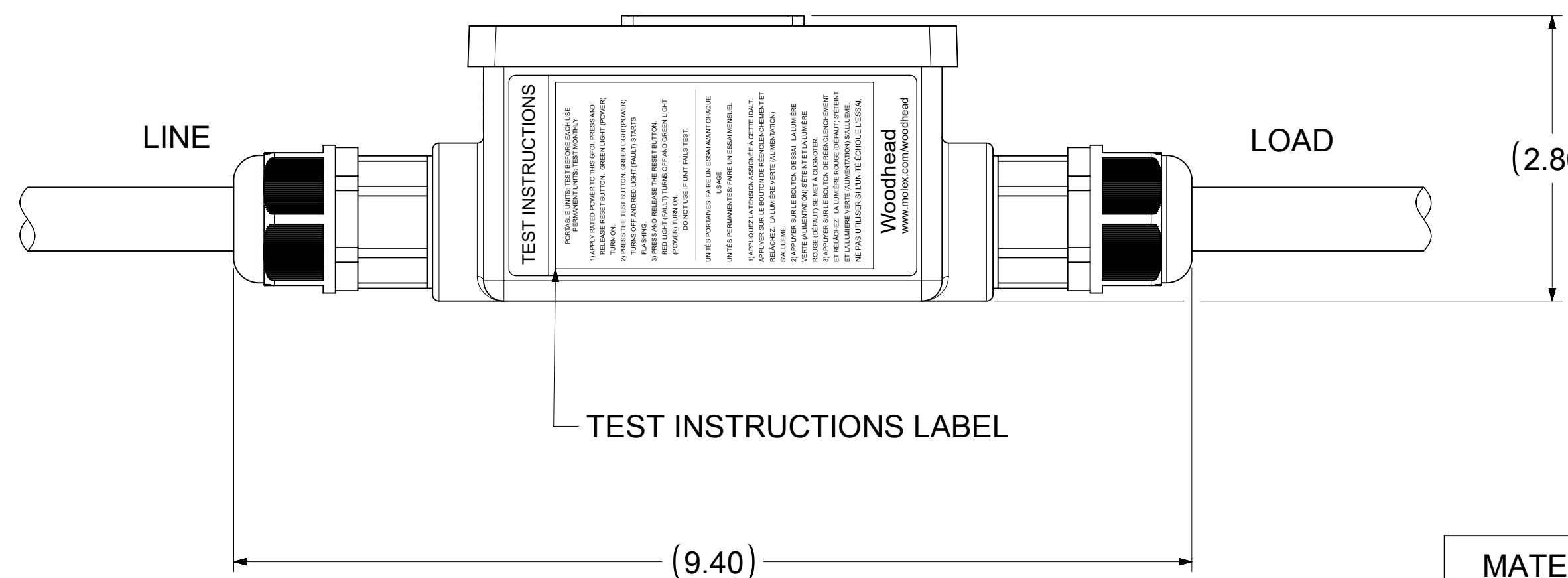
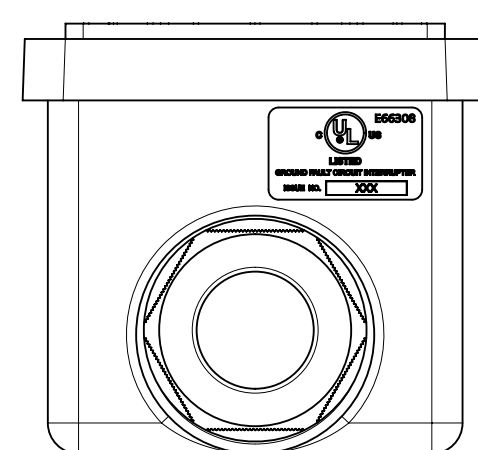

FRONT LABEL  
(THREE PARTS)

TEST INSTRUCTIONS LABEL

CABLE (YELLOW) 10 AWG 3 CONDUCTOR 300V  
TYPE SJE00W UL LISTED FOR U.S. AND EITHER  
CUL LISTED OR CSA CERTIFIED FOR CANADA

**TECHNICAL**

LISTED:	UL & CSA
RATED SUPPLY VOLTAGE:	240VAC
RATED CURRENT:	UP TO 30 AMPS
RESET TYPE:	AUTOMATIC OR MANUAL
OPERATING FREQUENCY:	60 Hz
TYPE:	CLASS A
GROUND TRIP CURRENT:	5mA +/- 1mA
OVERLOAD CURRENT:	180 AMPS, 0.45PF
INSULATION VOLTAGE:	1,500 VRMS - 1 MINUTE
ENDURANCE OPERATIONS:	3000 OPERATIONS
ENCLOSURE:	NEMA 4X/6P

MATERIAL NO.	ENGINEERING NO.	LENGTH "L"	LENGTH "A"	POWER-UP
1301530193	30054-1A	2 FT 9.4 IN.	1 FT	AUTO
1301530199	30054-6A	7 FT 9.4 IN.	6 FT	AUTO
1301530196	30054-25A	26 FT 9.4 IN.	25 FT	AUTO
1301530194	30054-1M	2 FT 9.4 IN.	1 FT	MANUAL
1301530200	30054-6M	7 FT 9.4 IN.	6 FT	MANUAL
1301530197	30054-25M	26 FT 9.4 IN.	25 FT	MANUAL

<b>FUNCTIONAL SYMBOLS</b> FA = 0 FC = 0 FP = 0 <b>DIVISIONAL SYMBOLS</b>	THIS DRAWING CONTAINS INFORMATION THAT IS PROPRIETARY TO MOLEX ELECTRONIC TECHNOLOGIES, LLC AND SHOULD NOT BE USED WITHOUT WRITTEN PERMISSION		DIMENSION UNITS: INCH SCALE: NTS		CURRENT REV DESC: NEW SALES DRAWING CREATED						
	GENERAL TOLERANCES (UNLESS SPECIFIED) ANGULAR TOL ± °		EC NO: 666699 DRWN: PPURSTANDEL 2021/07/06 CHK'D: DNGUYEN62 2021/08/16 APPR: HKNEELAND 2021/08/17		INITIAL REVISION: DRWN: PPURSTANDEL 2021/07/06 APPR: HKNEELAND 2021/08/17					30A/240V INLINE GFCI AUTO 2FT WATERTITE NEMA	
	4 PLACES ± 3 PLACES ± 2 PLACES ± 1 PLACE ± 0 PLACES ±		DRAFT WHERE APPLICABLE MUST REMAIN WITHIN DIMENSIONS		THIRD ANGLE PROJECTION		DRAWING: D-SIZE SERIES: 130153		PRODUCT CUSTOMER DRAWING		
	DOCUMENT NUMBER: 1301530193		DOC TYPE: PSD DOC PART: 000 REVISION: A		MATERIAL NUMBER: SEE TABLE CUSTOMER: GENERAL MARKET		SHEET NUMBER: 1 OF 1				