

RECOMMENDED
CARD EDGE LAYOUT
THICKNESS 1.57 ± 0.15 / .062 ± .006

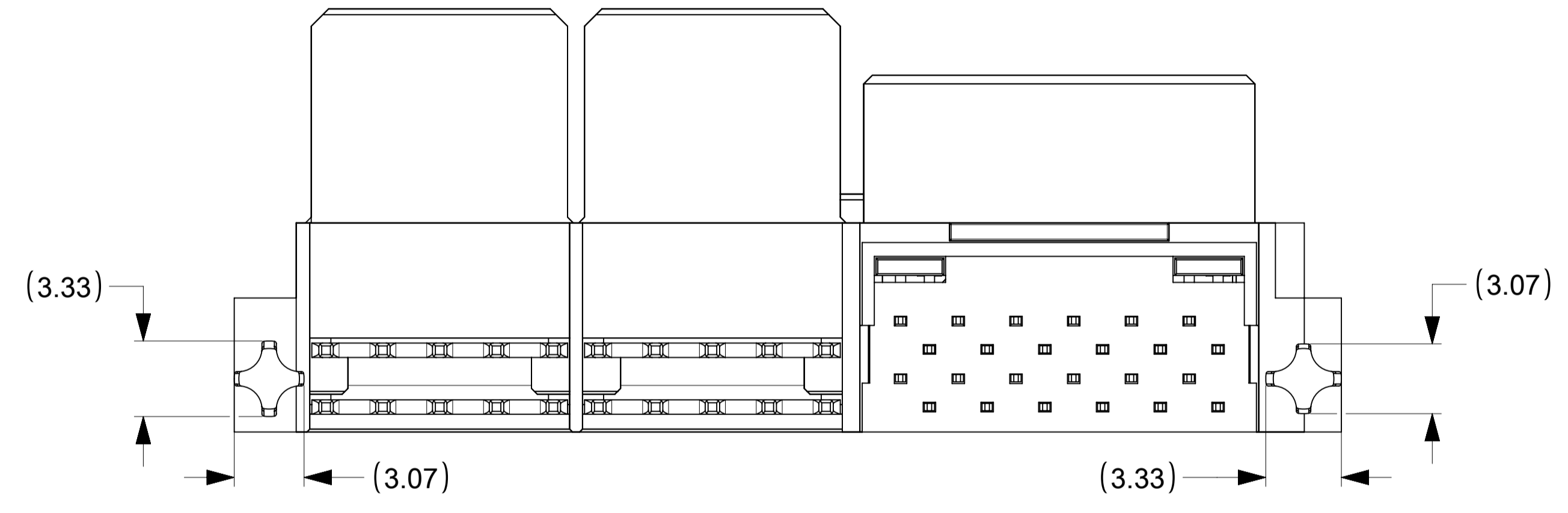

- NOTES:
- MATERIAL HOUSING: GLASS FILLED LCP (LIQUID CRYSTAL POLYMER), 94V-0, COLOR-BLACK.
CONTACT: COPPER ALLOY.
 - FINISH: SELECT GOLD - .76 μm / 30 μin MINIMUM CONTACT.
SELECT TIN - 3.81 μm / 150 μin MINIMUM TAIL.
BOTH OVER NICKEL - 1.27 μm / 50 μin MINIMUM.
 - POWER TERMINALS LUBRICATED IN CONTACT AREA.
 - PRODUCT SPECIFICATION: PS-45984-001.
 - PACKAGING: TRAY PER PK-45984-001.
 - PARTS ARE RoHS COMPLIANT.
 - MATES TO 1.57/.062 CARD EDGE OR MOLEX P/N 45985-4 ***

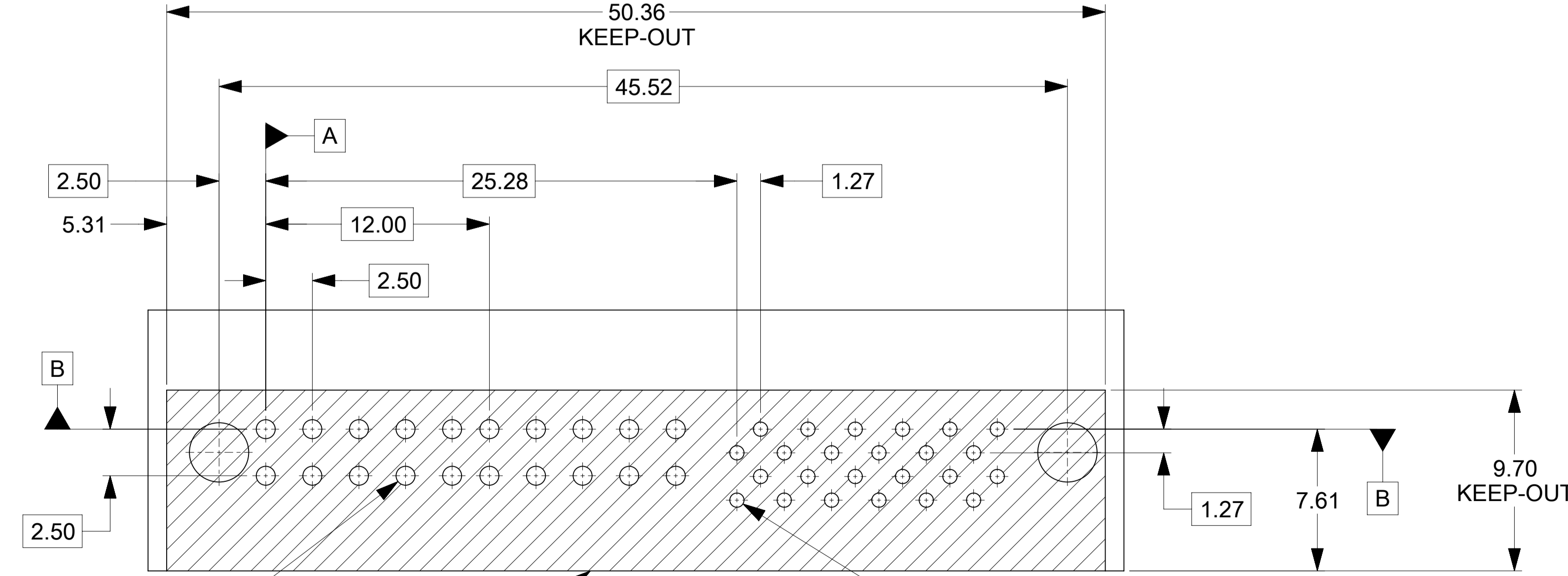

RECOMMENDED PCB LAYOUT
COMPONENT SIDE
PCB THICKNESS: 2.36/.093

PRLIMINARY

THIS DRAWING CONTAINS INFORMATION THAT IS PROPRIETARY TO MOLEX ELECTRONIC TECHNOLOGIES, LLC AND SHOULD NOT BE USED WITHOUT WRITTEN PERMISSION											
DIMENSION UNITS		SCALE		CURRENT REV DESC: RE-MASTERED IN ECTR							
mm		5:1									
GENERAL TOLERANCES (UNLESS SPECIFIED)				EC NO: 601373				LOW PROFILE HYBRID RECEPTACLE ASSEMBLY 4-POWER 24-SIGNAL			
4 PLACES ±		±		DRWN: RMV02		2017/08/16					
3 PLACES ±		±		CHK'D: RMV02		2019/04/26					
2 PLACES ±		0.25 ±		APPR: NCSR		2019/05/28					
1 PLACE ±		±		INITIAL REVISION:				PRODUCT CUSTOMER DRAWING			
0 PLACES ±		±		DRWN: MBANDURA		2010/04/23		DOCUMENT NUMBER		DOC TYPE DOC PART REVISION	
ANGULAR TOL ±		0.5 °		APPR: APATEL		2010/06/03		SD-45984-011		PSD 001 A	
DRAFT WHERE APPLICABLE MUST REMAIN WITHIN DIMENSIONS				THIRD ANGLE PROJECTION		DRAWING SERIES		MATERIAL NUMBER		CUSTOMER SHEET NUMBER	
						A1-SIZE 45984		45984-0011		GENERAL MARKET 1 OF 1	