

SIDE VIEW

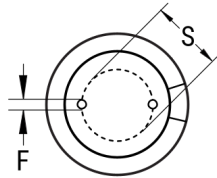

TERMINAL END VIEW



Click [here](#) for the 3D model.

Dimensions

| | |
|-------------|----------------|
| D | 18mm +/-0.5mm |
| L | 32mm +2mm |
| S | 7.5mm +/-0.5mm |
| LL Negative | 15mm MIN |
| LL Positive | 20mm MIN |
| F | 0.8mm NOM |

Packaging Specifications

| | |
|--------------------|-----------|
| Packaging | Bulk, Bag |
| Packaging Quantity | 500 |

General Information

| | |
|-------------|---|
| Series | ESW |
| Dielectric | Aluminum Electrolytic |
| Description | LowZ Single Ended Aluminum Electrolytic |
| Features | Low Z |
| RoHS | Yes |
| Lead | Wire Leads |
| AEC-Q200 | No |

Specifications

| | |
|-------------------------|--------------------------|
| Capacitance | 1,800 uF |
| Capacitance Tolerance | 20% |
| Voltage DC | 50 VDC, 63 VDC (Surge) |
| Temperature Range | -40/+105°C |
| Rated Temperature | 105°C |
| Life | 6000 Hrs |
| Dissipation Factor | 10% 120Hz 20C |
| Resistance | 0.021 Ohms (100kHz 20C) |
| Ripple Current | 3635 mAmps (100kHz 105C) |
| Leakage Current | 900 uA (2min 20°C) |
| Impedance Ratio at -25C | 2 |
| Impedance Ratio at -40C | 3 |