

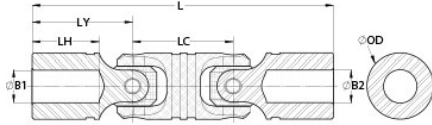

UD14-7/16"-8MM-F

Ruland UD14-7/16"-8MM-F, 7/16" x 8mm Double Universal Joint, Friction Bearing, Steel, 0.870" (22.1mm) OD, 4.375" (111.1mm) Length



Description

Ruland UD14-7/16"-8MM-F is a double cardan friction bearing universal joint with 0.4375" x 8mm bores, 0.870" (22.1mm) OD, and 4.375" (111.1mm) length. It is ideal for applications with wide distances between shafts and can accommodate all forms of misalignment. This plain bearing double universal joint is comprised of pins and blocks that are precision machined, selectively heat treated, and ground for high strength, accuracy, and wear resistance. The combination of these components with precision ground and hardened yoke ears allow for a longer lifespan, increased performance in demanding applications, and greater angular misalignment of up to 90° when compared to commodity style double universal joints. UD14-7/16"-8MM-F is made from high grade stainless steel for increased corrosion resistance. It can be combined with boot UBOOT14/22-NI-KIT to protect the joints from unwanted contaminants such as dust or water and self lubricate reducing maintenance time. This double cardan universal joint is manufactured in the USA by Belden Universal for strict control of processes.

Product Specifications

Bore (B1)	0.4375 in	Small Bore (B2)	8 mm
B1 Max Shaft Penetration	1.030 in (26.2 mm)	B2 Max Shaft Penetration	1.030 in (26.2 mm)
Joint Outer Diameter (OD)	0.870 in (22.1 mm)	Bore Tolerance	+0.0010 in / -0.0000 in (+0.025 mm / -0.000 mm)
Length (L)	4.375 in (111.1 mm)	Center Yoke Length (LC)	1.375 in (34.9 mm)
Yoke Length (LY)	1.500 in (38.1 mm)	Hub Depth (LH)	1.030 in (26.2 mm)
Peak Torque	1,575 in-lb (178.0 Nm)	Rated Torque	315 in-lb (35.6 Nm)
Max Operating Angle	90°	Material Specification	Alloy Steel
Manufacturer	Belden Universal	Country of Origin	USA
Recommended Lubricant	LUBRIPLATE No. 1200-2	Matching Boot Cover	UBOOT14/22-NI-KIT
UPC	63452931665	Tariff Code	8483.60.4000
UNSPC	25173810		

Note 1 Performance ratings are for guidance only. The user must determine suitability for a particular application.

Prop 65  **WARNING** This product can expose you to the chemical Ethylene Thiourea, known to the State of California to cause cancer and birth defects or other reproductive harm. For more information go to www.P65Warnings.ca.gov.