



Crimp Tool Basic Information

Read these instructions completely before using this tool!

Crimp Tool PN: 600 600

Crimp Head PN:
600 600 601 01



Crimp Head Die Size

.1" / .128" / .151" / .213"

Crimp Steps

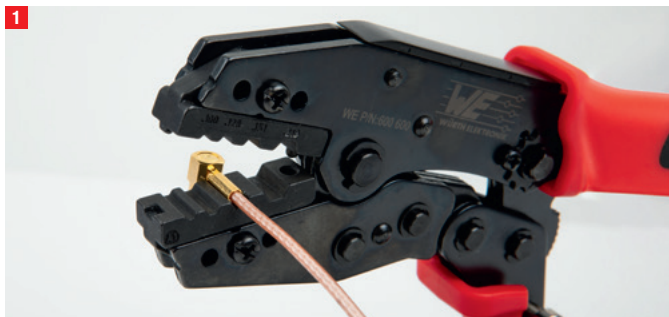

Locate ferrule at appropriate hex size according to datasheet.

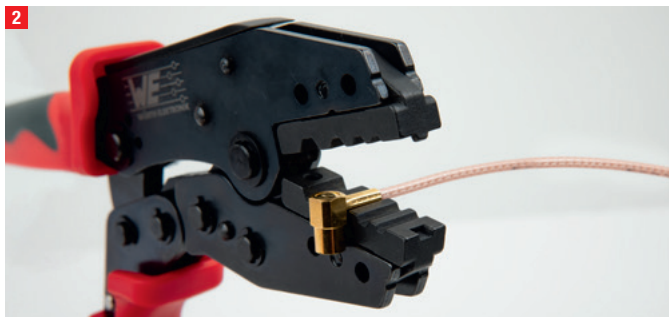

Make sure ferrule is well sit in crimp head slot.

Preface

The Operating Instructions must always be within reach of the hand crimping tool. This Crimp System Tool may be used only for the intended application and in strict compliance with all applicable safety rules, regulations and practices. It must be properly maintained, undamaged and in good working order. Unauthorized modification is prohibited and voids the manufacturer's warranty. Always wear safety glasses with side shields and other appropriate personal protective equipment.



MISUSE MAY CAUSE PERSONAL INJURY. KEEP OUT OF REACH OF CHILDREN!
NEVER INSERT FINGERS BETWEEN THE JAWS OF THE TOOL!

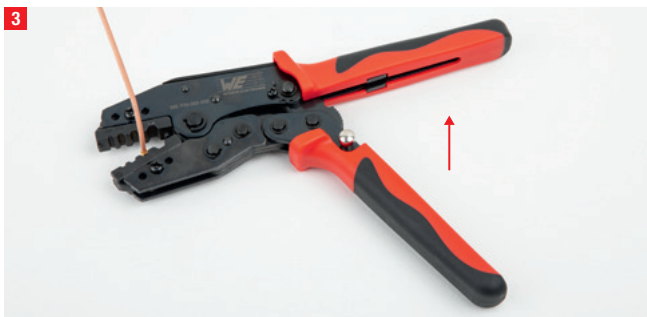

Crimp the ferrule manually.



Release the handle until last click.

Application

The Crimp System Tool has been developed for optimal crimping of a large variety of connectors and terminals by using different interchangeable crimping dies.

Description

This Crimp System Tool is comprised of the basic tool with adjustment dial and quick release, a set of dies, two setscrews for the dies and positioning locator. The crimping force can be adjusted (refer to "Adjustment of the Jaw Spread").

The ratchet has six steps. It automatically opens after the sixth step has been passed (principle of compulsory completion). To prevent damage to the crimping die or connector, the built-in quick release (lock) enables the tool to be opened prematurely in the event of failed crimping.

Built in quick release (lock)



For the moments that is necessary to release to crimp head.



Press the silver button at lower handle, in order to release the crimp head.



Release completed.

For quick release the lock: The lock will open automatically at the end of the crimping process. If the crimping process is interrupted, the handles of the tool must be pressed together a little and the lock pushed with an appropriate tool (e.g. screw driver).

Crimp Head Assembly



Insert crimp head manually.



Match middle screw hole.

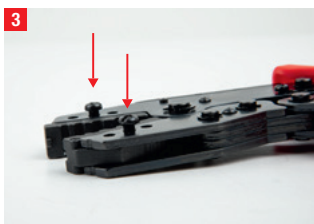

Place.

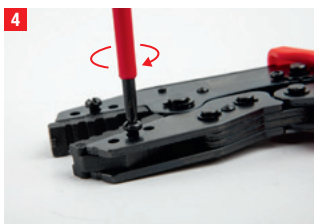

And screw.

Crimp Head Replacement



Unscrew.

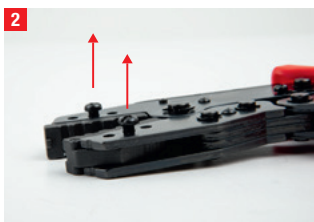

Remove screw.



Slowly remove crimp head manually.



Warranty

These crimp system tool are subject to thorough quality control before leaving the factory. The enclosed general terms and conditions of warranty apply.

Service

Before using the crimp system tool, make sure it is in a clean and proper operating state. Always remove crimping residue. Protect the joints from soiling and apply light machine oil to them regularly. Check the bolts regularly to ensure that the lock washers and headless screw, securing the adjustment dial, are intact and tight. All other maintenance should be performed by the manufacturer.



01ENECKARPRINZEN 999900009 0321 5010 FLY