

NOTES:
 1. MATERIAL: SEE TABLE
 2. FINISHES: SEE TABLE
 3. PACKAGING: PART IS PACKED IN A CLEAR POLY BAG WITH
 BARCODE LABEL ATTACHED TO OUTSIDE OF BAG
 4. MATES WITH: MINI-CHANGE A-SIZE RECEPTACLE

Iso1
 Scale 1:1

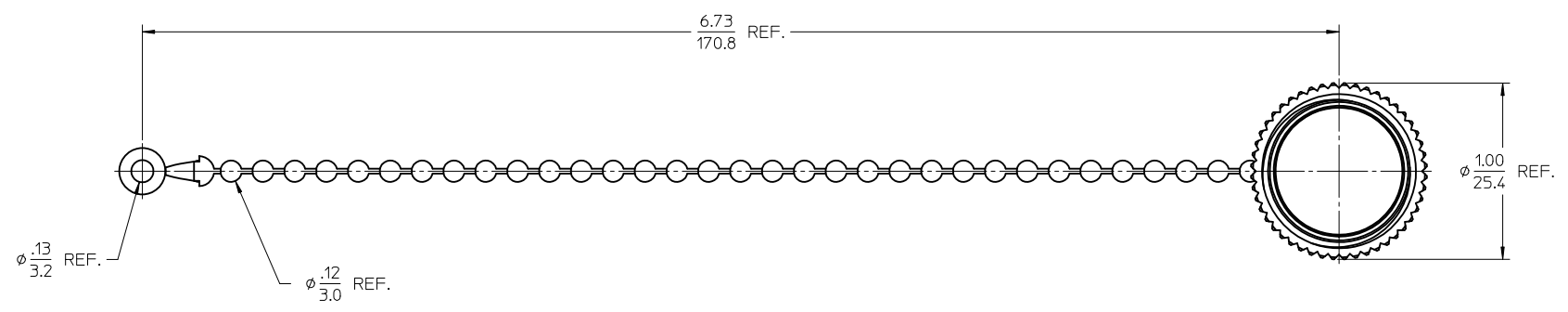
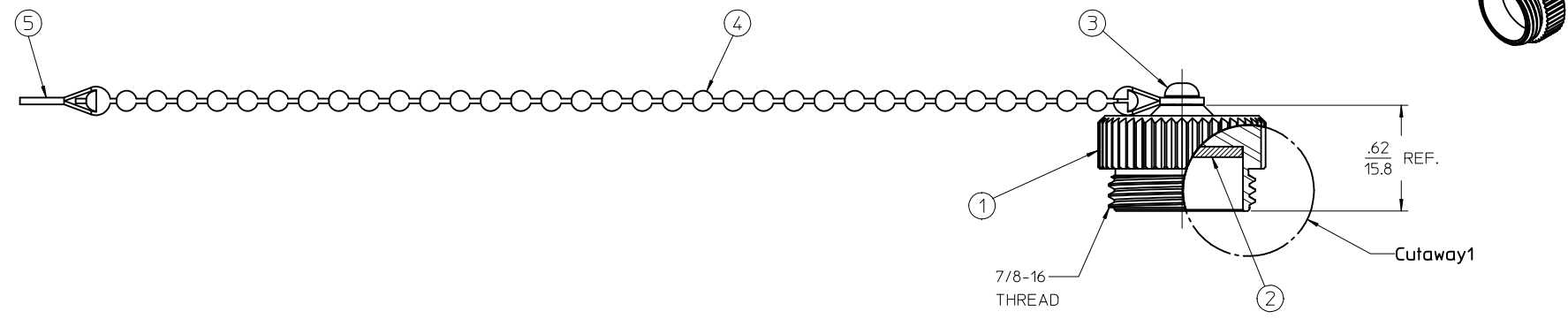

5	2	FITTING, #6	STAINLESS STEEL	PASSIVATED
4	1	BEAD CHAING, #6	STAINLESS STEEL	PASSIVATED
3	1	DRIVE SCREW	STAINLESS STEEL	PASSIVATED
2	1	GASKET SEAL	NEOPRENE	BLACK
1	1	CLOSURE CAP	STAINLESS STEEL	PASSIVATED
ITEM	QTY.	DESCRIPTION	MATERIAL	FINISH

RELEASED	EC NO: MNA2010-0461	2010/01/22
DRWR:RSTONE	CHKD:B.WOODMAN	2010/01/22
APPR:JFMURPHY		2010/01/25
REV	DESCRIPTION	QUALITY SYMBOLS
A		▽=0
		▽=0

GENERAL TOLERANCES (UNLESS SPECIFIED)	
	mm INCH
4 PLACES ±	--- ±
3 PLACES ±	--- ±
2 PLACES ±	--- ±.010
1 PLACE ±	0.3 ±
ANGULAR ±1/2°	
DRAFT WHERE APPLICABLE MUST REMAIN WITHIN DIMENSIONS	

DIMENSION STYLE	
IN/MM	
DRAWN BY	DATE
R.STONE	2010/01/22
CHECKED BY	DATE
B.WOODMAN	2010/01/25
APPROVED BY	DATE
JFMURPHY	2010/01/22
MATERIAL NO.	
848569106	
SIZE	
C	

SCALE	DESIGN UNITS	THIRD ANGLE PROJECTION
2:1	INCH	☉
TITLE		
MC CLOSURE CAP WITH #6 BEAD CHAIN, ST. STEEL MALE THREAD		
MOLEX INCORPORATED		SHEET NO.
DOCUMENT NO.		1 OF 1
SD-84856-020		
THIS DRAWING CONTAINS INFORMATION THAT IS PROPRIETARY TO MOLEX INCORPORATED AND SHOULD NOT BE USED WITHOUT WRITTEN PERMISSION		