

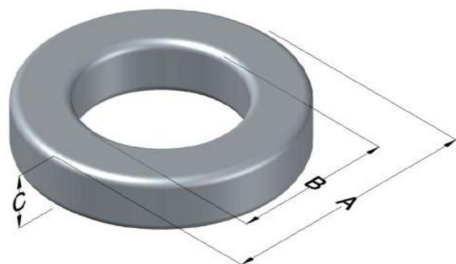

0076083A7

110 Delta Drive
 Pittsburgh, PA 15238
 NAFTA Sales: (1)800-245-3984
 HK Sales : (852)3102-9337
 magnetics@spang.com
 www.mag-inc.com



Kool M μ Hf Permeability (μ)	A_L (nH/T ²)	Core Marking			Coating Color
		Lot Number	Part Number	Inductance Grade	
60	81 \pm 8%	XXXXXX	76083A7	N/A	Black

Dimensions						Packaging
Uncoated			Coated Limits			
	(mm)	(in)	(mm)	(in)		
OD (A)	39.88	1.570	40.77	1.605	max	
ID (B)	24.13	0.950	23.32	0.918	min	
HT (C)	14.48	0.570	15.37	0.605	max	

Cardboard cut-outs
Box Qty = 180 Pcs

Electrical Characteristics			Physical Characteristics						
Watt Loss @ 100kHz, 100mT (max, mW/cm ³)	DC Bias min (Oersteds)		Voltage Breakdown wire-to-wire min (V _{Ac})	Break Strength (min, kg)	Window Area, W _A (mm ²)	Cross Section, A _e (mm ²)	Path Length, L _e (mm)	Volume V _e (mm ³)	Weight (g)
	80%	50%							
450	45	100	3000	126	427	107	98.4	10600	67.9

Winding Information					Temperature Rating					
Winding Length per Turn				Wound Coil Dimensions (mm)		Curie Temp (°C):	500 °C			
Winding Factor	(mm)	Winding Factor	(mm)	40% Winding Factor	OD	44.3	Coating Temp: (Continuous, up to; °C)	200 °C		
					HT	22.4				
0%	48.2	40%	60.2	Completely Full Window	Max OD	56.4	Notes:			
20%	54.3	45%	62.1		Max HT	35.2				
25%	55.8	50%	63.7	Surface Area (mm ²)						
30%	57.0	60%	67.3	Unwound Core:	4800					
35%	58.8	70%	71.5	40% Wound:	7300					

