

PART NUMBER	TITLE	CABLE DESCRIPTION	L	CABLE COLOR
21534-31201	MINI-FIT JR. M-S 75MM 20 AWG BK Au	1X20AWG DISC PVC BK UL1015 HOOKUP	75±3	BLACK
21534-31202	MINI-FIT JR. M-S 150MM 20 AWG BK Au	1X20AWG DISC PVC BK UL1015 HOOKUP	150±5	BLACK
21534-31203	MINI-FIT JR. M-S 225MM 20 AWG BK Au	1X20AWG DISC PVC BK UL1015 HOOKUP	225±5	BLACK
21534-31204	MINI-FIT JR. M-S 300MM 20 AWG BK Au	1X20AWG DISC PVC BK UL1015 HOOKUP	300±5	BLACK
21534-31205	MINI-FIT JR. M-S 450MM 20 AWG BK Au	1X20AWG DISC PVC BK UL1015 HOOKUP	450±5	BLACK
21534-32201	MINI-FIT JR. M-S 75MM 20 AWG RD Au	1X20AWG DISC PVC RD UL1015 HOOKUP	75±3	RED
21534-32202	MINI-FIT JR. M-S 150MM 20 AWG RD Au	1X20AWG DISC PVC RD UL1015 HOOKUP	150±5	RED
21534-32203	MINI-FIT JR. M-S 225MM 20 AWG RD Au	1X20AWG DISC PVC RD UL1015 HOOKUP	225±5	RED
21534-32204	MINI-FIT JR. M-S 300MM 20 AWG RD Au	1X20AWG DISC PVC RD UL1015 HOOKUP	300±5	RED
21534-32205	MINI-FIT JR. M-S 450MM 20 AWG RD Au	1X20AWG DISC PVC RD UL1015 HOOKUP	450±5	RED

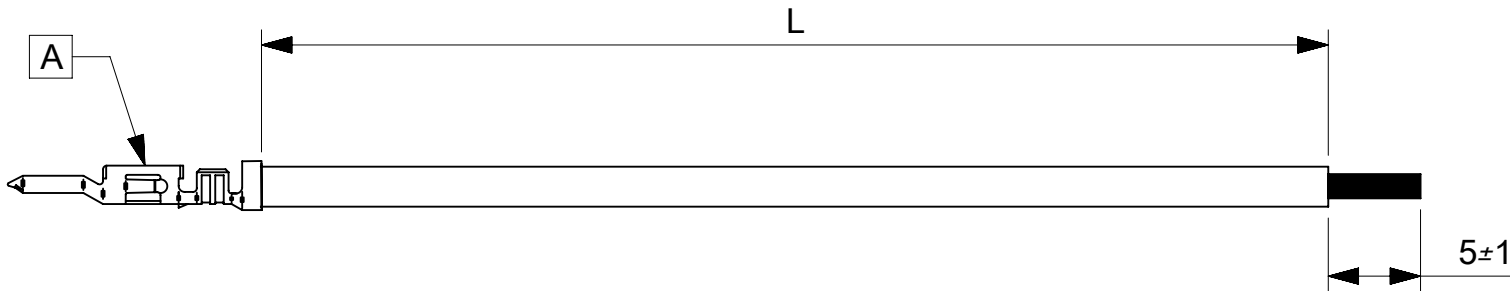

ITEM	PART#	DESCRIPTION	QTY	UOM
A	39000430	New Mini Fit Crimp Pin W/Plt	1	PC

NOTES:

1. Crimping to be done as per Molex standards.
2. The product specification relies on the terminals & wire spec.
3. Free ends must be stripped, twisted & tinned. The length of tinning is 5±1mm. Tinning dia must be 1.25mm Max.

REVISION			
DATE	REV	DESCRIPTION	CHANGER
2020/01/30	A	INITIAL RELEASE	ARAJU
DOCUMENT STATUS	P1	RELEASE DATE	2020/02/28 07:50:35

THIS DRAWING CONTAINS INFORMATION THAT IS PROPRIETARY TO MOLEX ELECTRONIC TECHNOLOGIES, LLC AND SHOULD NOT BE USED WITHOUT WRITTEN PERMISSION									
SYMBOLS		DIMENSION UNITS		SCALE		CURRENT REV DESC:			
▽ = 0	mm	NTS		<p>molex</p> <p>SEE TABLE</p> <p>PRODUCT CUSTOMER DRAWING</p> <p>DOCUMENT NUMBER: 2153431201 DOC TYPE: PSD DOC PART: 000 REVISION: A</p> <p>INITIAL REVISION:</p> <p>DRWN: AS20 2020/01/30</p> <p>CHK'D: RDESAI01 2020/02/28</p> <p>APPR: RDESAI01 2020/02/28</p> <p>DRWN: AS20 2020/01/30</p> <p>APPR: RDESAI01 2020/02/28</p> <p>MATERIAL NUMBER: SEE TABLE CUSTOMER: GENERAL MARKET SHEET NUMBER: 1 OF 1</p>					
▽ = 0	GENERAL TOLERANCES (UNLESS SPECIFIED)								
▽ = 0	ANGULAR TOL ± °								
▽ = 0	4 PLACES	±							
▽ = 0	3 PLACES	±							
▽ = 0	2 PLACES	±							
▽ = 0	1 PLACE	±							
▽ = 0	0 PLACES	±							
□ = 0	DRAFT WHERE APPLICABLE MUST REMAIN WITHIN DIMENSIONS								
▽ = 0	THIRD ANGLE PROJECTION		DRAWING						
		A4-SIZE		215343					