

CIRCUIT CONNECTION TABLE:

CONNECTION:1 (END-A)		CABLE DATA		CONNECTION:2 (END-B)	
CONNECTOR CIRCUIT NO	CONNECTOR PART NO	CABLE PART NO	CORE CONDUCTOR COLOUR	CONNECTOR CIRCUIT NO	CONNECTOR PART NO
1	MOLEX# 453391600	LEONI# L45581- B22-K8-EN	RED	---	---
2			---	---	
3			---	---	
4			---	---	
5			---	---	
6			PINK	---	
7			GREY	---	
8			GREEN	---	
9			YELLOW	---	
10			WHITE	---	
11			BROWN	---	
12			---	---	
13			---	---	
14			---	---	
15			---	---	
16			BLUE	---	
LATCH-1	DRAIN WIRE-1	---	---	---	
LATCH-2	DRAIN WIRE-2	---	---	---	

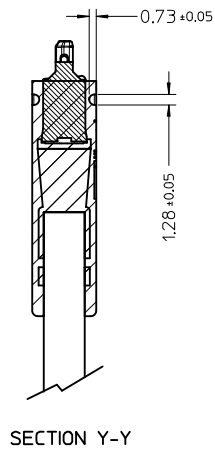
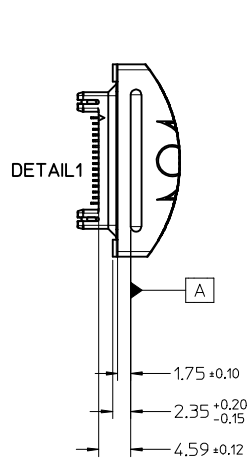

NOTES:

1. RAW MATERIAL OF HANDYLINK OVERMOLD & STRAIN RELIEF: PVC 17% MF grey (PANTONE 538U)
2. CABLE SPECIFICATIONS AS SPECIFIED IN LEONI# L45581-B22-K8-EN (UPDATED 11/04/2007)
3. AESTHETICS QUALITY CRITERIA OF 366970077 WILL BE INLINE WITH 366970073
4. MOLEX DOES NOT COMMIT ON ANY ADHESION PARAMETERS BETWEEN CABLE AND STRAIN RELIEF WHAT EVER IS ACHIEVED WITH OUR PROCESS WILL BE FREEZED AT LATER DATE.

ENTER DESCRIPTION EC NO: 12008-0106 DRWN:RRANGAPPA01 2007/08/28 CHKD:KPRASAD 2007/08/29 APPR:KPRASAD 2007/08/29	QUALITY SYMBOLS ▽=0 ▽=0	GENERAL TOLERANCES (UNLESS SPECIFIED)		DIMENSION STYLE MM ONLY	SCALE 1:1	DESIGN UNITS METRIC	THIRD ANGLE PROJECTION
		4 PLACES ±---	mm	INCH	DRAWN BY RAGHU	DATE 2007/07/20	TITLE CABLE ASSY I/O WTB 1WIRE L=3010MM TELEVIC#04.90.3733 REV.3
2	REV	3 PLACES ±---	DRAFT WHERE APPLICABLE MUST REMAIN WITHIN DIMENSIONS		CHECKED BY DKUMAR	DATE 2007/07/20	MATERIAL NO. 366970077
		2 PLACES ±0.1	APPROVED BY DKUMAR		DATE 2007/07/20	DOCUMENT NO. SD-36697-017	
		1 PLACE ±0.1	SIZE A2		MATERIAL NO. 366970077		
		ANGULAR ±---	THIS DRAWING CONTAINS INFORMATION THAT IS PROPRIETARY TO MOLEX INCORPORATED AND SHOULD NOT BE USED WITHOUT WRITTEN PERMISSION		SHEET NO. 1 OF 1		