

## SUMMARY



Image is for illustrative purpose only

### # Wires

Low voltage 1

Series 0S  
Termination type Male solder  
IP rating 50  
AWG wire size 26.00 - 18.00  
Cable Ø 4.30 - 5.20 mm  
Status active  
Matching parts [ERA.0S.116.CTL](#)

### Download

[Request a quote](#)  
[Catalog](#)

## TECHNICAL DETAILS

### Mechanics

Shell Style/Model FLA\*: Elbow plug, cable collet  
Keying Circular, male  
Housing Material Brass (chrome plated [SAE AMS 2460]) shell and collet nut, nickel plated [SAE AMS QQ N 290] brass latch sleeve and mid pieces  
Weight 17.73 g

### Performance

Configuration 0S.116 : 1 Low Voltage  
Insulator T: PTFE  
Rated Current 12 Amps

### Specifications

Contact Type: Solder  
V<sub>test</sub> (contact-shell): 1500 V (AC), 2100 V (DC)  
V<sub>test</sub> (contact-contact): 1500 V (AC), 2100 V (DC)

### Others

Endurance (Shell): 5000 mating cycles  
Temp (min / max): -55°C / +250°C

LEMO products and services are provided "as is". LEMO makes no warranties or representations with regard to LEMO product & services or use of them, express, implied or statutory, including for accuracy, completeness, or security. The user is fully responsible for his products and applications using LEMO components.

Humidity (max): <=95% [at 60 deg C /140 F]  
 Vibration: 15 g [10 Hz - 2000 Hz]  
 Shock Resistance: 100 g [ 6 ms]  
 Climatical Category: 50/175/21  
 Shielding (min): 75 dB (10 MHz)  
 Shielding (min): 40 dB (1 GHz)  
 Salt Spray Corrosion: >144 hr

## DRAWINGS

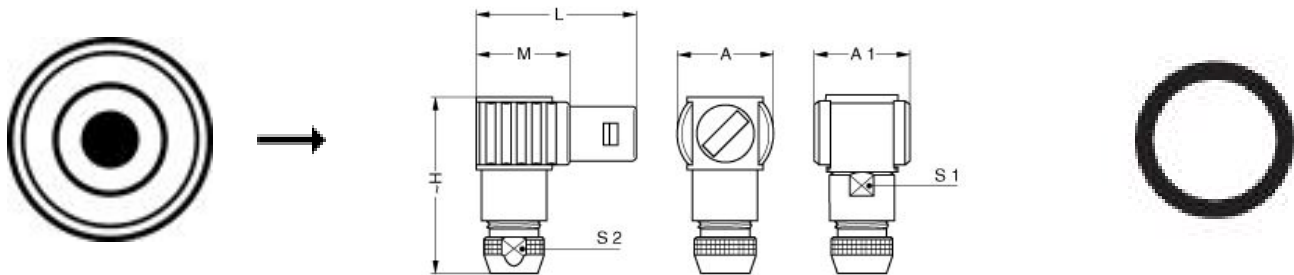

### Dimensions

	A	A1	H	L	M	S1	S2
mm.	13	13	24.5	23	13	8	6.5
in.	0,51	0,51	0,96	0,91	0,51	0,31	0,26

## RECOMMENDED BY LEMO

### Tools

### Cables

*LEMO products and services are provided "as is". LEMO makes no warranties or representations with regard to LEMO product & services or use of them, express, implied or statutory, including for accuracy, completeness, or security. The user is fully responsible for his products and applications using LEMO components.*