

REV	DATE	DESCRIPTION	BY	CHK	APP
CM 00					
AA	REVISED PER 0038-0367-02				07-NOV-03 SH DB

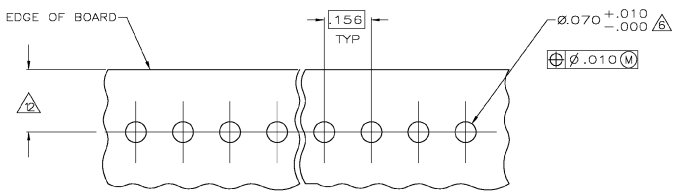
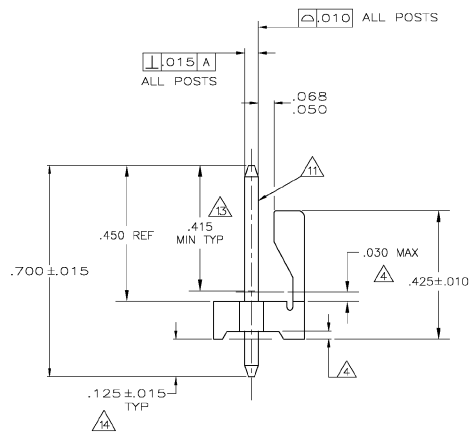
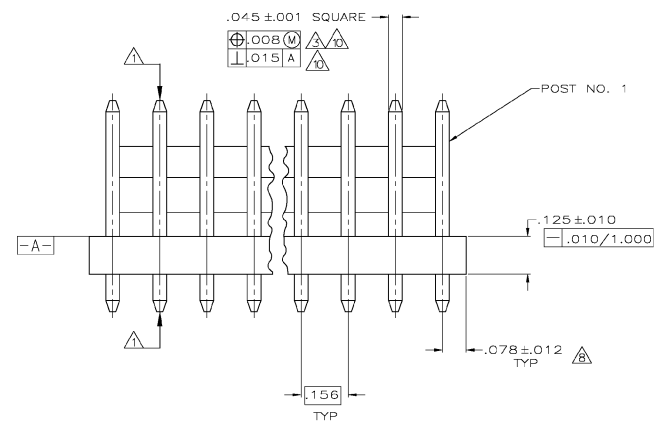
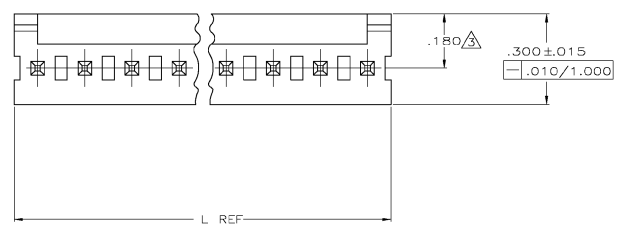

RECOMMENDED MOUNTING HOLE PATTERN FOR .063 THICK P.C. BOARD

- △ POST TO WITHSTAND 13 NEWTONS (3LBS) MIN. AXIAL FORCE IN BOTH DIRECTIONS SHOWN WITHOUT DISLODGING.
- △ TOLERANCES APPLY TO SOLDER SIDE OF BOARD.
- △ MEASURED AT SURFACE [-A-]
- △ PLASTIC FLASH PERMITTED IN THIS AREA.
- 5. PARTS COMPLY WITH AMP SOLDERABILITY SPEC. NO. 108-11-2.
- △ ONE HOLE MAY BE UNDERSIZED (.065/.060 DIA.) FOR ASSEMBLY RETENTION DURING WAVE SOLDERING.
- △ MATERIAL: HEADER-THERMOPLASTIC POLYESTER NON-FILLED 94V-0(NATURAL) POST-COPPER ALLOY (SEE NOTES 13 & 14 FOR PLATING)
- △ COORDINATE DIMENSION APPLIES FROM CENTER OF ACTUAL FEATURE.
- 9. PLASTIC BURRS CAUSED BY CUT-OFF TOOLING ARE PERMITTED WITHIN THE MAXIMUM TOLERANCE ENVELOPE.
- △ POST TO BE MEASURED WHEN STRIP IS HELD FLAT.
- △ POST MUST WITHSTAND TWO 90° BENDS AGAINST EXTRUSION WITHOUT BREAKING.
- △ DIMENSION SHOULD BE .175 MIN WHEN MATING WITH A MTA 156 CONNECTOR ASSEMBLY OR A SL-156 CONNECTOR ASSEMBLY.
- △ COLD PLATE AREA .000015 MIN., ALL SIDES, OVER NICKEL UNDERPLATE, .000050 MIN., ALL SIDES AND ENTIRE LENGTH OF POST.
- △ BRIGHT TIN/LEAD (93/7) PLATE AREA .000150-.000350 THICK, ALL FOUR SIDES, .125 MIN.

95.10	3.744	24	2-641119-4
91.14	3.588	23	2-641119-3
87.17	3.432	22	2-641119-2
83.21	3.276	21	2-641119-1
79.25	3.120	20	2-641119-0
75.29	2.964	19	1-641119-9
71.32	2.808	18	1-641119-8
67.36	2.652	17	1-641119-7
63.40	2.496	16	1-641119-6
59.44	2.340	15	1-641119-5
55.47	2.184	14	1-641119-4
51.51	2.028	13	1-641119-3
47.55	1.872	12	1-641119-2
43.59	1.716	11	1-641119-1
39.62	1.560	10	1-641119-0
35.66	1.404	9	641119-9
31.70	1.248	8	641119-8
27.74	1.092	7	641119-7
23.77	.936	6	641119-6
19.81	.780	5	641119-5
15.85	.624	4	641119-4
11.89	.468	3	641119-3
7.92	.312	2	641119-2
MM	[IN]	NUMBER OF POSITIONS	PART NUMBER

METRIC

.063	1.60	1.000	25.40
.060	1.52	.700	17.78
.045	1.14	.450	11.43
.030	0.76	.425	10.80
.015	0.38	.415	10.54
.012	0.30	.300	7.62
.010	0.25	.180	4.57
.008	0.20	.175	4.45
.005	0.13	.156	3.96
.001	0.03	.125	3.18
.000350	0.00889	.078	1.98
.000150	0.00381	.070	1.78
.000050	0.00127	.068	1.73
.000015	0.00038	.065	1.65
[IN]	MM	[IN]	MM

CONVERSION TABLE

THIS DRAWING IS A CONTROLLED DOCUMENT.

DATE: 07-NOV-2002
 BY: HOLLOWAY
 CHECKED: BROWN
 DATE: 07-NOV-2002
 BY: BROWN
 DATE: 07-NOV-2002
 BY: BROWN

DESIGNER: HOLLOWAY
 CHECKER: BROWN
 DATE: 07-NOV-2002

NAME: MTA-156 HEADER ASSEMBLY, FRICTION LOCK, STRAIGHT .045 SQUARE POST, .000015 GOLD

APPLICATION SPEC: MTA-156

SIZE: A1
 CASE CODE: 00779
 DRAWING NO: 641119

MATERIAL: MTA-156
 FINISH: GOLD

REVISIONS: 1
 SCALE: 1:1
 SHEET: 1 OF 1
 REV: AA