

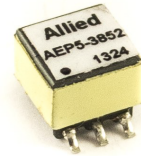

- EP5 Package in SMD
- Operating temperature range: -40°C to +125°C
- Reflow Condition:  
Maximum reflow temperature is 250°C/-5°C  
time is 20~40 sec. (Refer to IPC/JEDECJ-STD-020 standard)



**Electrical Specifications @25°C**

Inductance Lp @100KHz,0.1V (4 - 6)	Leakage Inductance Ls @100KHz, 0.1V (tie 1+3) (4 - 6)	Turns Ratio (4 - 6) : (1 - 3)	Capacitance PRI to SEC
296µH min	1.5µH Max	1 : 1 (±3%)	14pF Max

**Electrical Specifications @25°C**

DCR (4 - 6)	DCR (1 - 3)	SRF	Isolation Voltage 1mA, 60 sec PRI to SEC
795mΩ Max	655mΩ Max	1.75MHz Min	1500 Vdc

All specifications subject to change without notice.

**MECHANICAL**

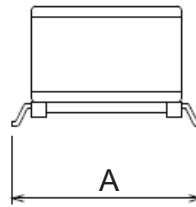
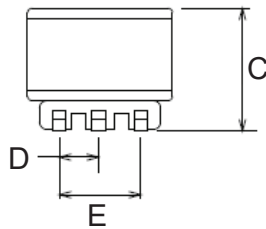

A	.323 (8.20) Max
B	.260 (6.60) Max
C	.213 (5.40) Max
D	.073±.002 (1.85±.05)
E	.146±.004 (3.7±0.1)
F	.024±.002 (0.6±.05)
Unit : inch (mm)	

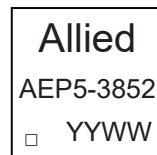
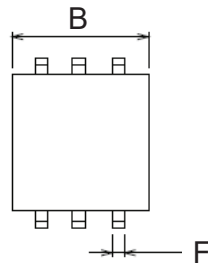

**SCHEMATIC**

