

CKT SIZE	MATERIAL NUMBER	DIM. A REF	DIM B	DIM P
4	45984-4911	24.60	12.00	4.50
6	45984-6911	36.60	24.00	
8	45984-8911	48.60	36.00	
10	45984-1911	60.60	48.00	3.60
4	45984-4921	24.60	12.00	
6	45984-6921	36.60	24.00	
8	45984-8921	48.60	36.00	2.90
10	45984-1921	60.60	48.00	
4	45984-4931	24.60	12.00	
6	45984-6931	36.60	24.00	2.90
8	45984-8931	48.60	36.00	
10	45984-1931	60.60	48.00	

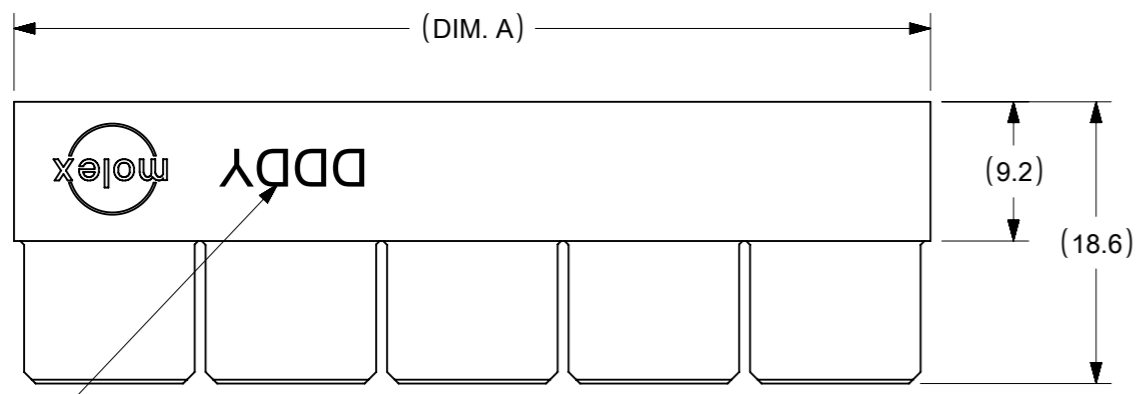

SEE NOTE 10

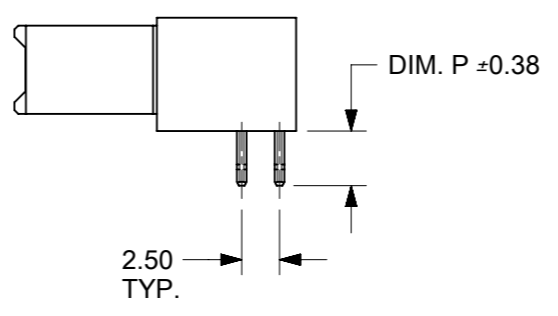
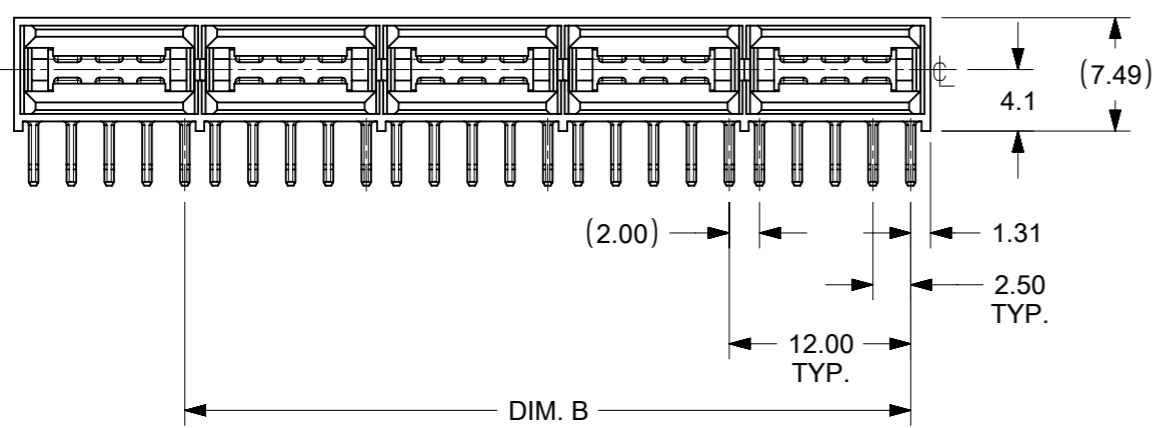

Ø 1.02 ±0.08 TYP.
 ⊕ Ø0.05(M) A B C

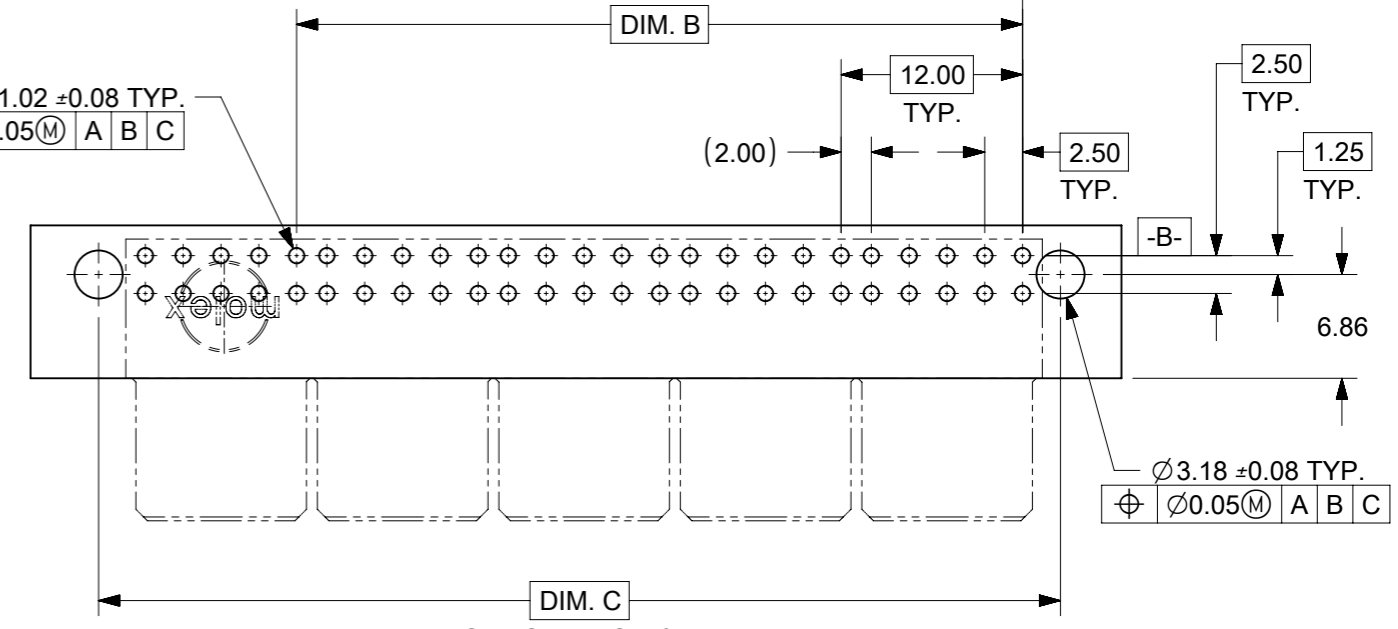

SEE SHEETS 3 & 4

PCB LAYOUT: COMPONENT SIDE
 (PEG HOLES OPTIONAL)

NOTES:

1. MATERIAL - HOUSING: GLASS FILLED LCP (LIQUID CRYSTAL POLYMER) , UL94V-0, BLACK
 MATERIAL - POWER CONTACT: COPPER ALLOY
2. FINISH: SELECT GOLD (WITH EB-1): 0.76 MICROMETER / 30 MICROINCH MINIMUM, IN CONTACT AREA,
 SELECT TIN: 3.81 MICROMETER /150 MICROINCH MINIMUM, IN PC TAIL AREA
 BOTH OVER NICKEL: 1.27 MICROMETER / 50 MICROINCH MINIMUM. PER ES-88-229.
 TERMINALS ARE LUBRICATED WITH EB-1 LUBRICANT.
3. PRODUCT SPECIFICATION: PS-45984-001
4. PACKAGING SPECIFICATION: TRAY PER PK-45984-001
5. SEE SHEET 5 FOR CKT IDENTIFICATION
6. PARTS ARE RoHS COMPLIANT.
7. PEG HOLES ARE OPTIONAL. SEE SHEET 3 & 4.
8. MATES TO .157/.062 CARD EDGE OR MOLEX SERIES 45985.
9. PARTS CONFORM TO CLASS B REQUIREMENTS OF COSMETIC SPECIFICATION PS-45499-002.
10. DATE CODE (3-DIGIT DAY, 1-DIGIT YEAR) TO BE PRINTED AND LOCATED AS SHOWN.

THIS DRAWING CONTAINS INFORMATION THAT IS PROPRIETARY TO MOLEX ELECTRONIC TECHNOLOGIES, LLC AND SHOULD NOT BE USED WITHOUT WRITTEN PERMISSION											
DIMENSION UNITS		SCALE		CURRENT REV DESC: RE-MASTERED IN ECTR				molex		LPH RECEPTACLE ASSEMBLY RIGHT ANGLE POWER CONNECTOR	
mm		2:1									
GENERAL TOLERANCES (UNLESS SPECIFIED)											
		MM		INCH		EC NO: 601373		DOCUMENT NUMBER		DOC TYPE DOC PART REVISION	
4 PLACES ±		±		±		DRWN: RMV02 2017/08/17		SD-45984-102		PSD 001 E	
3 PLACES ±		±		±		CHK'D: RMV02 2019/04/26		PRODUCT CUSTOMER DRAWING			
2 PLACES ±		0.25		±		APPR: NCSR 2019/05/28		INITIAL REVISION:			
1 PLACE ±		0.38		±		DRWN: BANDURA 5/16/2006		APPR: PATEL			
0 PLACES ±		±		±		ANGULAR TOL ± 0.5°		DRAFT WHERE APPLICABLE MUST REMAIN WITHIN DIMENSIONS		THIRD ANGLE PROJECTION	
						DRAWING		SERIES		MATERIAL NUMBER	
						A3-SIZE		45984		SEE CHART	
								CUSTOMER		GENERAL MARKET	
										SHEET NUMBER	
										1 OF 5	

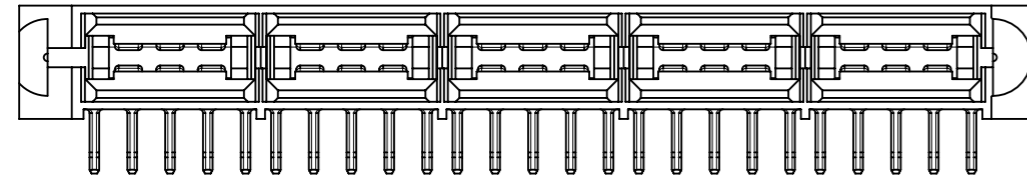
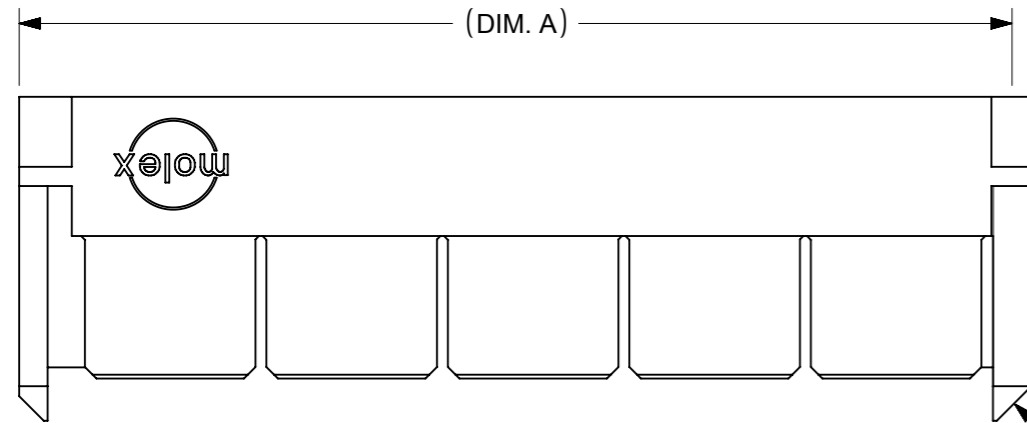

OPTIONAL GUIDES

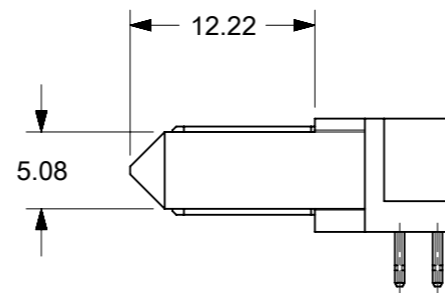

CKT SIZE	MATERIAL NUMBER	DIM. A REF	DIM B	DIM P
4	45984-4912	31.01	12.00	4.50
6	45984-6912	43.01	24.00	
8	45984-8912	55.01	36.00	
10	45984-1912	67.01	48.00	3.60
4	45984-4922	31.01	12.00	
6	45984-6922	43.01	24.00	
8	45984-8922	55.01	36.00	2.90
10	45984-1922	67.01	48.00	
4	45984-4932	31.01	12.00	
6	45984-6932	43.01	24.00	2.90
8	45984-8932	55.01	36.00	
10	45984-1932	67.01	48.00	

THIS DRAWING CONTAINS INFORMATION THAT IS PROPRIETARY TO MOLEX ELECTRONIC TECHNOLOGIES, LLC AND SHOULD NOT BE USED WITHOUT WRITTEN PERMISSION										
DIMENSION UNITS mm		SCALE 2:1		CURRENT REV DESC: RE-MASTERED IN ECTR			molex			
GENERAL TOLERANCES (UNLESS SPECIFIED)				EC NO: 601373						LPH RECEPTACLE ASSEMBLY RIGHT ANGLE POWER CONNECTOR
		MM	INCH	DRWN: RMV02 2017/08/17			PRODUCT CUSTOMER DRAWING			
4 PLACES		±	±	CHK'D: RMV02 2019/04/26			DOCUMENT NUMBER			
3 PLACES		±	±	APPR: NCSR 2019/05/28			SD-45984-102			
2 PLACES		± 0.25	±	INITIAL REVISION:			DOC TYPE			
1 PLACE		± 0.38	±	DRWN: BANDURA 5/16/2006			DOC PART			
0 PLACES		±	±	APPR: PATEL			REVISION			
ANGULAR TOL		± 0.5°		THIRD ANGLE PROJECTION			SHEET NUMBER			
DRAFT WHERE APPLICABLE MUST REMAIN WITHIN DIMENSIONS				DRAWING A3-SIZE		SERIES 45984		MATERIAL NUMBER SEE CHART		CUSTOMER GENERAL MARKET

DOCUMENT STATUS	P1	RELEASE DATE	2019/05/28	12:22:55
-----------------	----	--------------	------------	----------

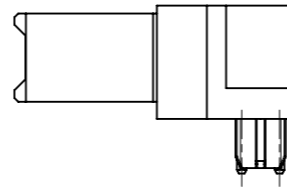
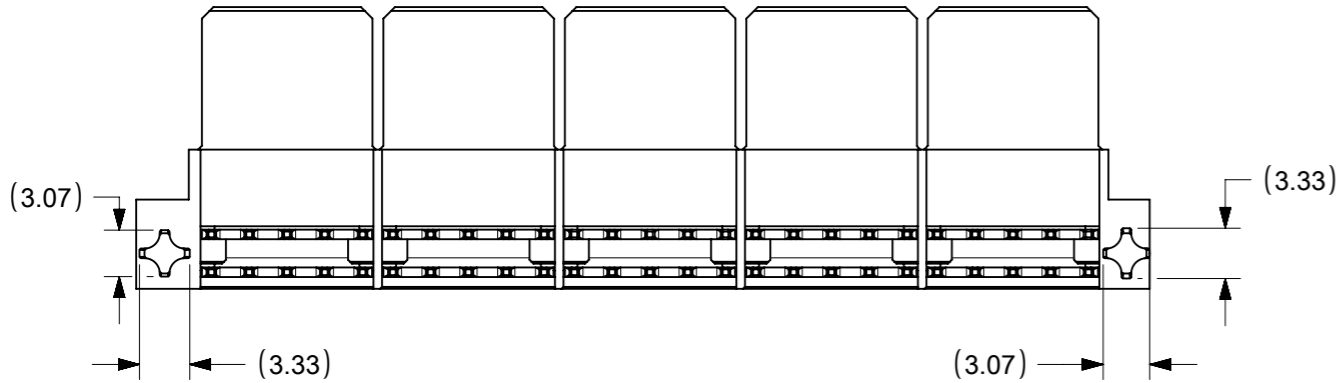
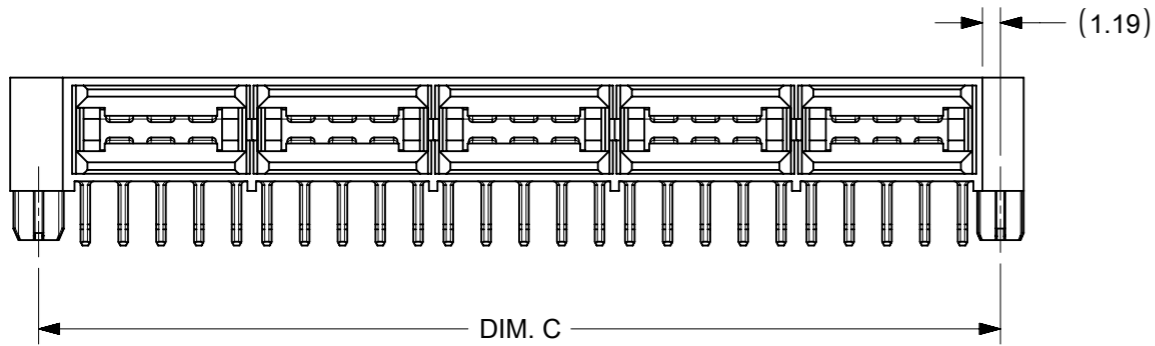
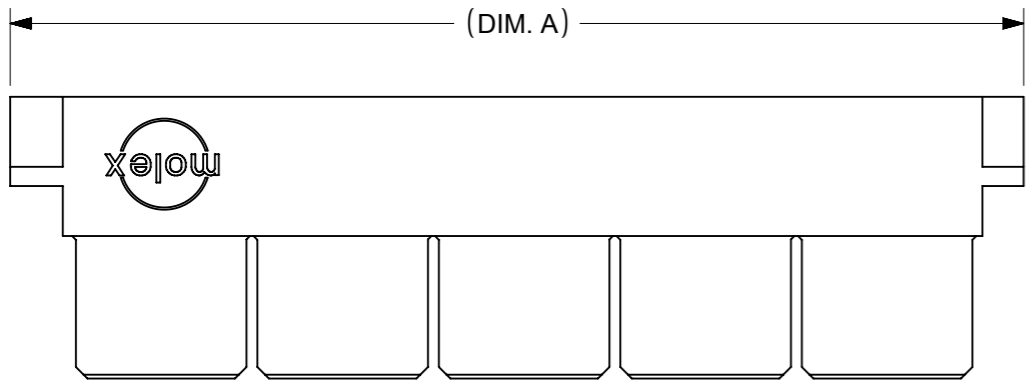

CKT SIZE	MATERIAL NUMBER	DIM. A REF	DIM B	DIM C	DIM P
4	45984-4913	31.01	12.00	27.60	4.50
6	45984-6913	43.01	24.00	39.60	
8	45984-8913	55.01	36.00	51.60	
10	45984-1913	67.01	48.00	63.60	3.60
4	45984-4923	31.01	12.00	27.60	
6	45984-6923	43.01	24.00	39.60	
8	45984-8923	55.01	36.00	51.60	2.90
10	45984-1923	67.01	48.00	63.60	
4	45984-4933	31.01	12.00	27.60	
6	45984-6933	43.01	24.00	39.60	2.90
8	45984-8933	55.01	36.00	51.60	
10	45984-1933	67.01	48.00	63.60	

THIS DRAWING CONTAINS INFORMATION THAT IS PROPRIETARY TO MOLEX ELECTRONIC TECHNOLOGIES, LLC AND SHOULD NOT BE USED WITHOUT WRITTEN PERMISSION

DIMENSION UNITS mm		SCALE 2:1		CURRENT REV DESC: RE-MASTERED IN ECTR		molex		
GENERAL TOLERANCES (UNLESS SPECIFIED)				EC NO: 601373				
		MM	INCH	DRWN: RMV02 2017/08/17		PRODUCT CUSTOMER DRAWING		
4 PLACES		±	±	CHK'D: RMV02 2019/04/26		DOCUMENT NUMBER		
3 PLACES		±	±	APPR: NCSR 2019/05/28		SD-45984-102		
2 PLACES		± 0.25	±	INITIAL REVISION:		DOC TYPE	DOC PART	REVISION
1 PLACE		± 0.38	±	DRWN: BANDURA 5/16/2006		PSD	001	E
0 PLACES		±	±	APPR: PATEL		SHEET NUMBER		
ANGULAR TOL		± 0.5°		DRAFT WHERE APPLICABLE MUST REMAIN WITHIN DIMENSIONS		THIRD ANGLE PROJECTION	DRAWING	SERIES
							A3-SIZE	45984
						MATERIAL NUMBER	CUSTOMER	
						SEE CHART	GENERAL MARKET	3 OF 5

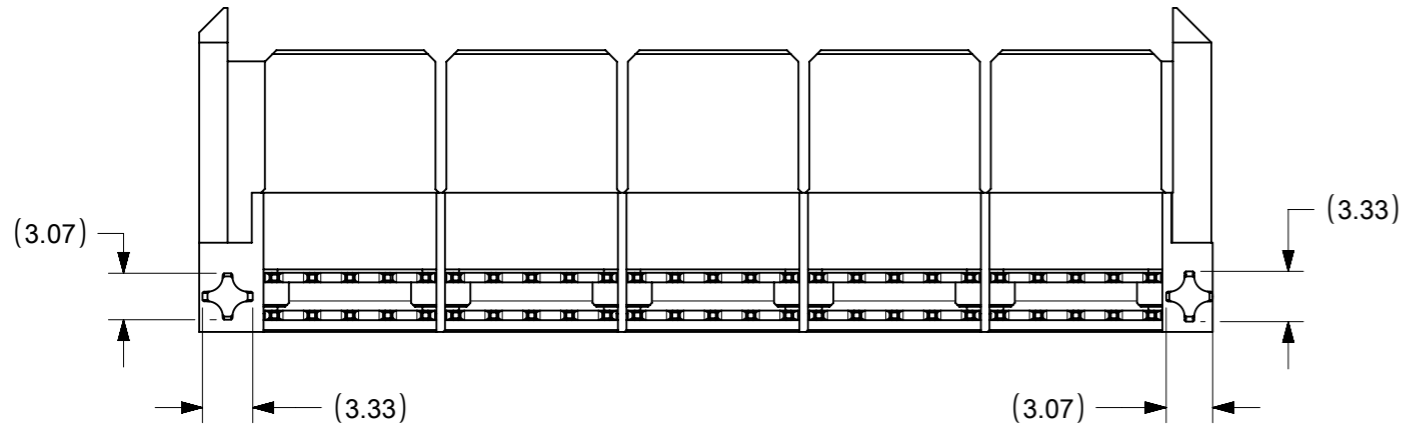
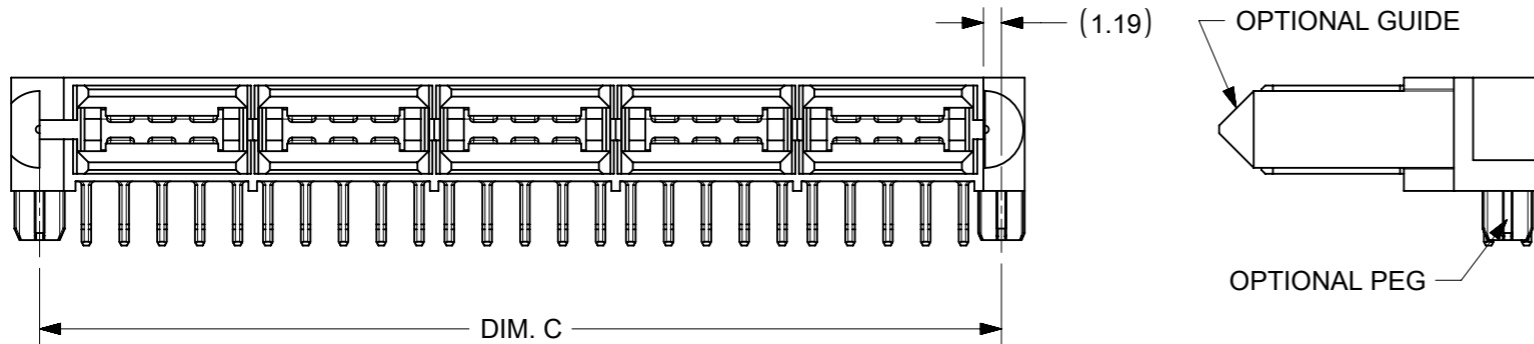
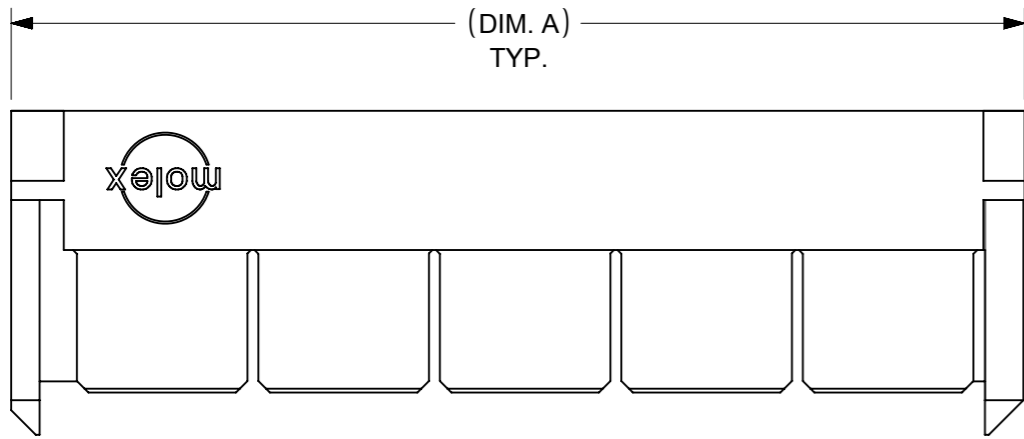

CKT SIZE	MATERIAL NUMBER	DIM. A REF	DIM B	DIM C	DIM P
4	45984-4914	31.01	12.00	27.60	4.50
6	45984-6914	43.01	24.00	39.60	
8	45984-8914	55.01	36.00	51.60	
10	45984-1914	67.01	48.00	63.60	
4	45984-4924	31.01	12.00	27.60	3.60
6	45984-6924	43.01	24.00	39.60	
8	45984-8924	55.01	36.00	51.60	
10	45984-1924	67.01	48.00	63.60	
4	45984-4934	31.01	12.00	27.60	2.90
6	45984-6934	43.01	24.00	39.60	
8	45984-8934	55.01	36.00	51.60	
10	45984-1934	67.01	48.00	63.60	

THIS DRAWING CONTAINS INFORMATION THAT IS PROPRIETARY TO MOLEX ELECTRONIC TECHNOLOGIES, LLC AND SHOULD NOT BE USED WITHOUT WRITTEN PERMISSION

DIMENSION UNITS mm	SCALE 2:1	CURRENT REV DESC: RE-MASTERED IN ECTR	molex		
GENERAL TOLERANCES (UNLESS SPECIFIED)		EC NO: 601373			
4 PLACES ±	MM INCH	DRWN: RMV02 2017/08/17	PRODUCT CUSTOMER DRAWING		
3 PLACES ±		CHK'D: RMV02 2019/04/26	DOCUMENT NUMBER		
2 PLACES ± 0.25		APPR: NCSR 2019/05/28	SD-45984-102		
1 PLACE ± 0.38		INITIAL REVISION:	DOC TYPE	DOC PART	REVISION
0 PLACES ±		DRWN: BANDURA 5/16/2006	PSD	001	E
ANGULAR TOL ± 0.5°		APPR: PATEL	SHEET NUMBER		
DRAFT WHERE APPLICABLE MUST REMAIN WITHIN DIMENSIONS	THIRD ANGLE PROJECTION	DRAWING	SERIES	MATERIAL NUMBER	CUSTOMER
		A3-SIZE	45984	SEE CHART	GENERAL MARKET

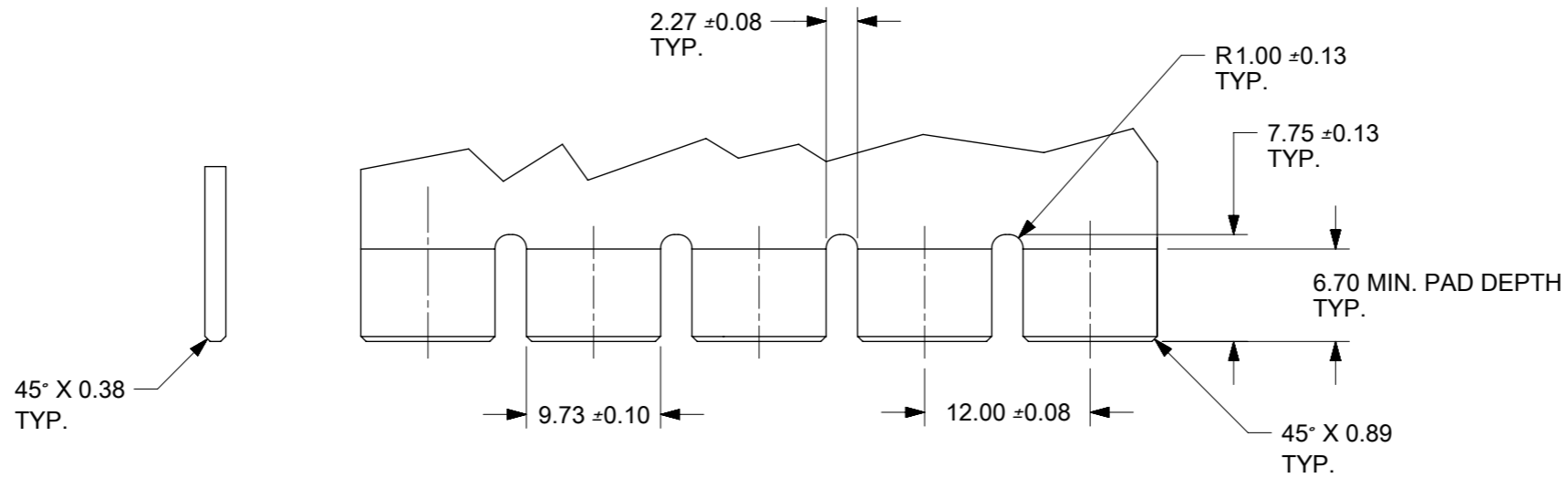
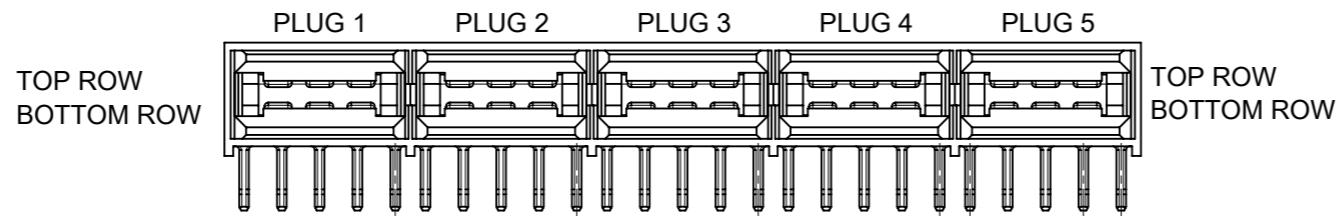

RECOMMENDED
EDGE CARD LAYOUT
THICKNESS: 1.57/0.062±0.15/0.006

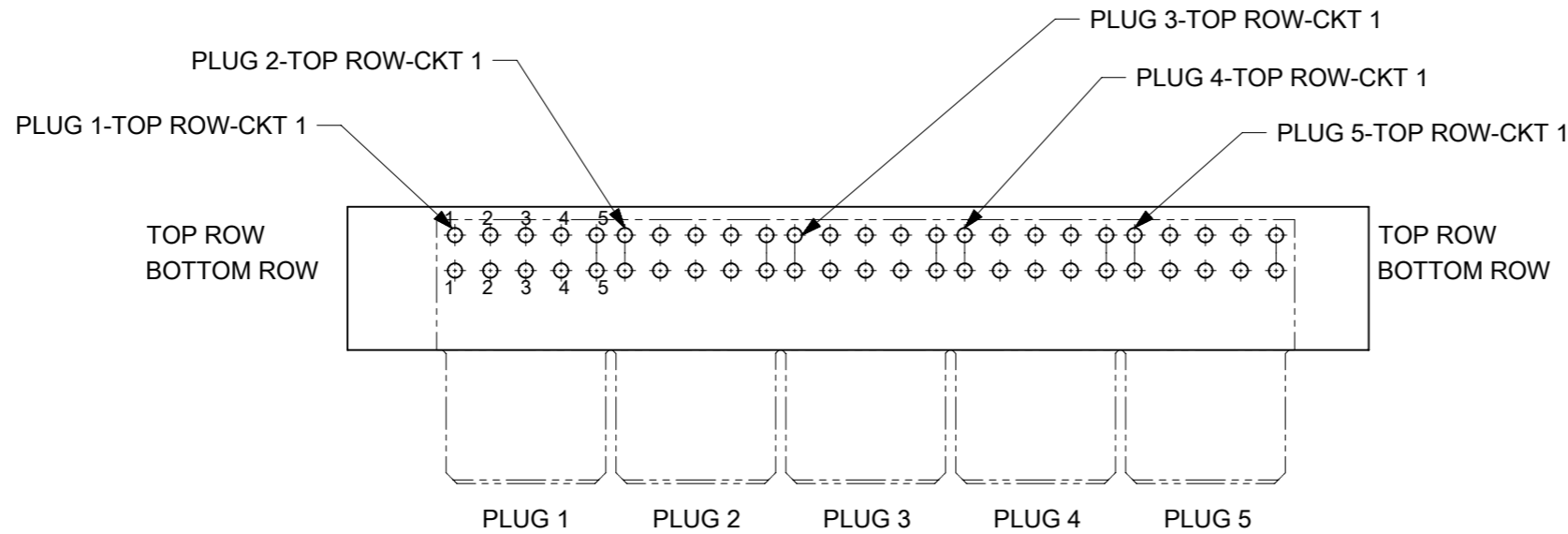

PCB LAYOUT: COMPONENT SIDE
SEE SHEET 1 FOR DIMENSIONS

THIS DRAWING CONTAINS INFORMATION THAT IS PROPRIETARY TO MOLEX ELECTRONIC TECHNOLOGIES, LLC AND SHOULD NOT BE USED WITHOUT WRITTEN PERMISSION									
DIMENSION UNITS		SCALE		CURRENT REV DESC: RE-MASTERED IN ECTR				molex	
mm		2:1							
GENERAL TOLERANCES (UNLESS SPECIFIED)				EC NO: 601373				LPH RECEPTACLE ASSEMBLY RIGHT ANGLE POWER CONNECTOR	
				DRWN: RMV02 2017/08/17					
4 PLACES ±				CHK'D: RMV02 2019/04/26				PRODUCT CUSTOMER DRAWING	
3 PLACES ±				APPR: NCSR 2019/05/28					
2 PLACES ± 0.25 ±				INITIAL REVISION:				DOCUMENT NUMBER	
1 PLACE ± 0.38 ±				DRWN: BANDURA 5/16/2006				SD-45984-102	
0 PLACES ±				APPR: PATEL				DOC TYPE DOC PART REVISION	
ANGULAR TOL ± 0.5°				THIRD ANGLE PROJECTION		DRAWING		SHEET NUMBER	
DRAFT WHERE APPLICABLE MUST REMAIN WITHIN DIMENSIONS				A3-SIZE		SERIES 45984		MATERIAL NUMBER CUSTOMER	
				SEE CHART		GENERAL MARKET		5 OF 5	