

Winding Type Chip Inductor

APO322530NV-SERIES

1. Features

1. Ferrite core wire wound construction.
2. High Reliability due to wire wound type construction.
3. Small footprint as well as low profile.
4. 100% Lead(Pb) & Halogen-Free and RoHS compliant.
5. High reliability -Reliability tests comply with AEC-Q200
6. Operating temperature-55~+150°C(Including self - temperature rise)
7. Inductor for use in-vehicle PoC (Power Over Coax)



2. Dimension

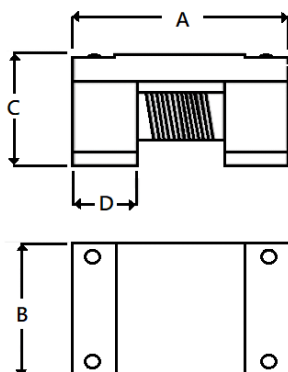

Size	A	B	C	D
APO322530	3.20±0.20	2.50±0.20	3.00±0.20	0.58±0.10

Unit:mm

3. Part Numbering

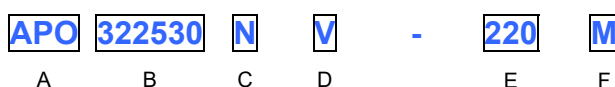

A: Series
 B: Dimension L x W x H
 C: Application
 D: Category Code V=Vehicle
 E: Inductance 220=22.0uH
 F: Inductance Tolerance M=±20%

4. Specification

Part number	Ls (μH) @100K/0.1V	DCR (Ohms)		SRF typ (MHz)	Isat(mA) Typ					Irms(mA) Typ		
		typ	max		25°C	85°C	105°C	125°C	140°C	25°C	85°C	125°C
APO322530NV-2R2M	2.2±20%	0.10	0.13	300	2200	1900	1700	1500	1300	1900	1730	1000
APO322530NV-6R8M	6.8±20%	0.20	0.24	120	1400	1000	930	800	700	1360	1230	800
APO322530NV-100M	10.0±20%	0.29	0.34	95	1100	850	760	660	560	1130	1020	570
APO322530NV-220M	22.0±20%	0.76	0.88	70	720	580	520	450	390	700	630	400

Note:

Maximum part temperature +140°C (ambient temperature plus self-generation of heat).

Isat : DC current that causes 30% inductance drop from its initial value at 200 mA at specified temperature.

Irms: Current that causes a 40°C rise at 25°C.

Current that causes a 40°C rise at 85°C.

Current that causes a 15°C rise at 125°C.