

**PERFORMANCE REQUIREMENTS:**

1. FIR TREE PUSH IN FORCE: 15LBS MAX IN A 6.6MM HOLE AND A SHEET METAL THICKNESS OF 1.8MM
2. FIR TREE PULL OUT FORCE: 50LBS MIN IN A 6.6MM HOLE AND A SHEET METAL THICKNESS OF 1.8MM
3. HOLE DIAMETER RANGE: 6.5MM- 7.2MM
- 04 4. PANEL THICKNESS RANGE: .6MM - 8.5MM
5. CABLE TIE TENSILE STRENGTH: 50LBS MIN
6. MINIMUM BUNDLE DIAMETER: 1.6MM
7. MAXIMUM BUNDLE DIAMETER: 35MM

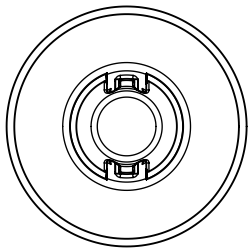
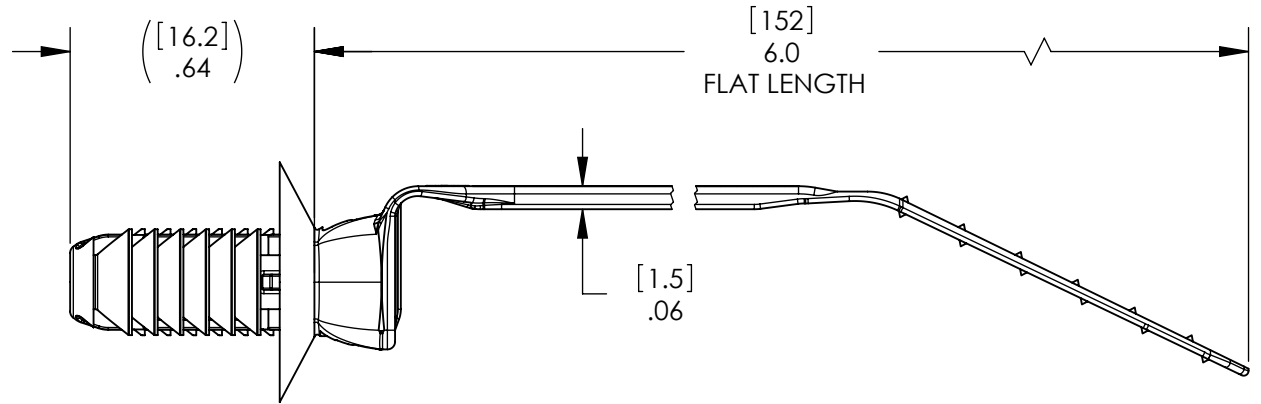
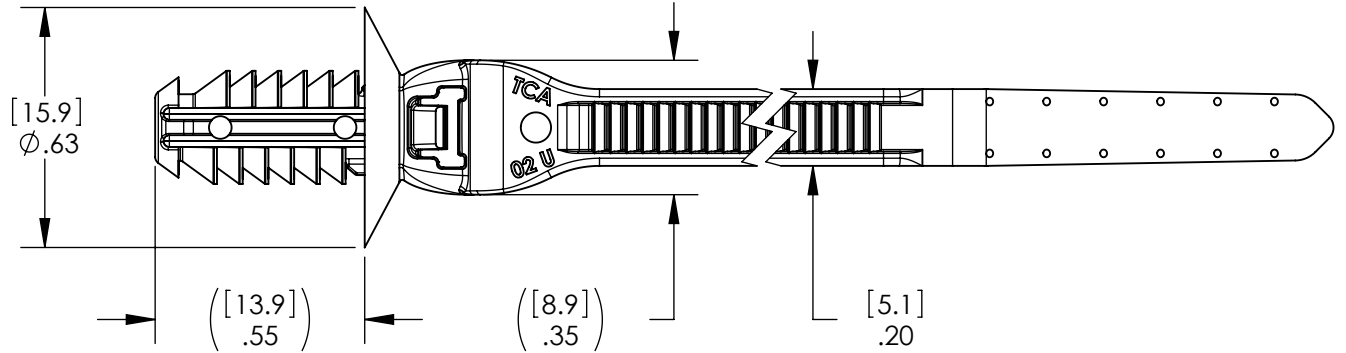

INVENTORS

**HellermannTyton**

ALL PROPRIETARY RIGHTS IN THE SUBJECT MATTER SHOWN ON THIS DRAWING ARE EXCLUSIVE PROPERTY OF HELLERMANNTYTON

name	date	city, state

REVISION

D level	04
AW by	JJP
IN date	02/04/2009
G ECN #	011234
part level	B/C

DIMENSIONS

FOOTPRINTS	.XXXX = [ $\pm 0.127$ ]/ $\pm 0.005$
	.XXX = [ $\pm 0.25$ ]/ $\pm 0.01$
	.XX = [ $\pm 0.5$ ]/ $\pm 0.02$
	.X = [ $\pm 6.4$ ]/ $\pm 0.25$
	$\angle = \pm 0.5^\circ$
	unless otherwise specified
units	[millimeters]/inches

PART

number	T50SOSFT6LGU	phase	04	Production
name	CIRCULAR FIR TREE CABLE TIE			
material	NYLON 6/6 HS BLACK			

DRAWING

format	AH	SW	2007	scale	2:1
version N	CAD				
computer file name	ct06-027-008CST_04	previous drawing number			
drawn	JJP	checked		approved	
	03/07/2007				
type	Customer	sheet	1 of 1		
number	CT06-027-008CST				