

Fork-type cable lug - C-FC 2,5/M8 - 3240147

Please be informed that the data shown in this PDF Document is generated from our Online Catalog. Please find the complete data in the user's documentation. Our General Terms of Use for Downloads are valid (<http://phoenixcontact.com/download>)



Fork-type cable lug, non-insulated, 1.1 - 2.5 mm², M8

Your advantages

- ✓ The fork-type cable lugs without plastic sleeve feature a hard-soldered neck. In conjunction with the CRIMPFOX-RC ... and CRIMPFOX-RCI ... pliers they can be used to achieve maximum conductor pull-out forces
- ✓ The insulated versions are halogen-free and feature "EASY ENTRY" technology

Key Commercial Data

Packing unit	100 pc
Minimum order quantity	100 pc
GTIN	
GTIN	4046356453646

Technical data

Dimensions

Length (b)	22.1 mm
Width (a)	13.5 mm
Maximum stripping length	8 mm
Length of insulation sleeve (c)	4.8 mm
Inner dimension of the insulating collar (d)	2.5 mm
Distance between the center and the insulation sleeve (e)	7.6 mm
Inner diameter (f)	8.4 mm
Material thickness (g)	0.8 mm

Ambient conditions

Ambient temperature (operation)	110 °C
---------------------------------	--------

General

Color	silver
-------	--------

Fork-type cable lug - C-FC 2,5/M8 - 3240147

Technical data

General

Stripping length	8 mm
Components	halogen-free
Material	Copper
Coating	tin-plated

Standards and Regulations

Design according to standard	DIN 46234
------------------------------	-----------

Environmental Product Compliance

China RoHS	Environmentally friendly use period: unlimited = EFUP-e
	No hazardous substances above threshold values

Drawings

Dimensional drawing

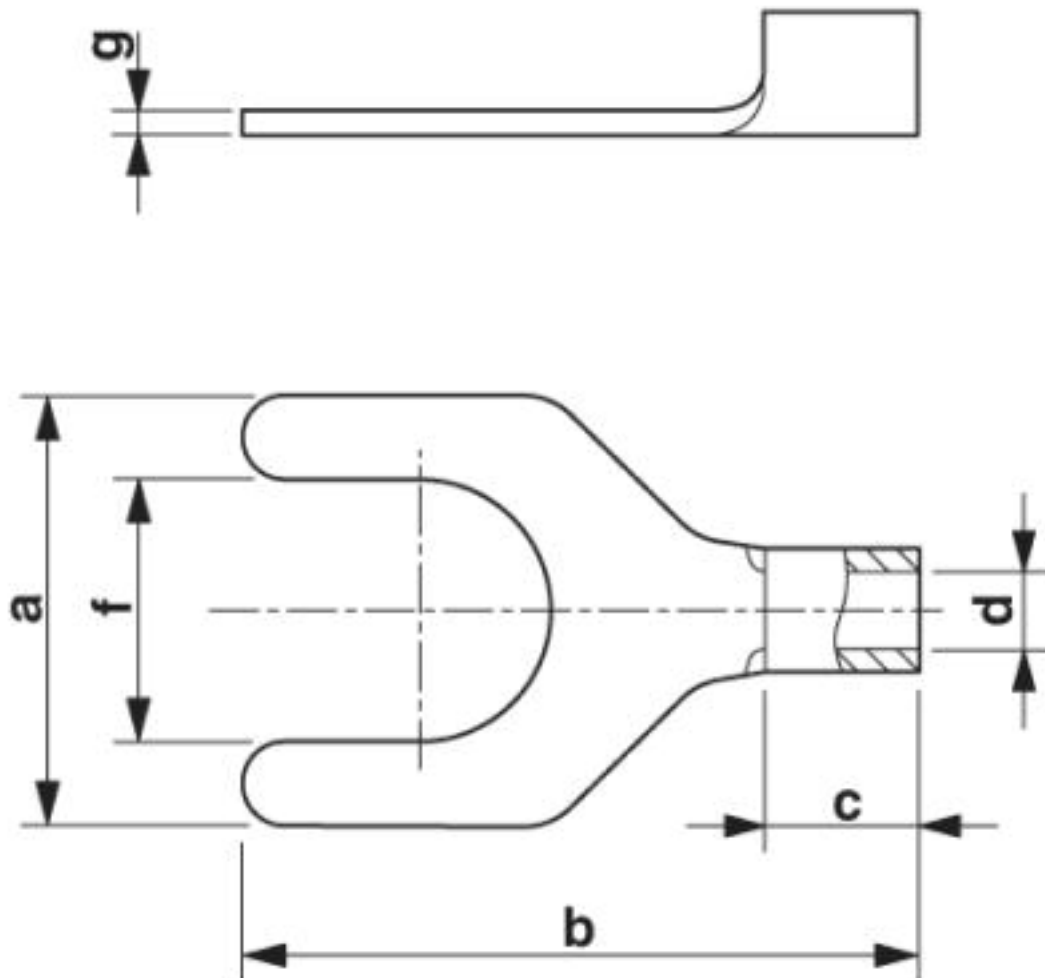

Fork-type cable lug - C-FC 2,5/M8 - 3240147

Approvals

Approvals

Approvals

EAC / EAC

Ex Approvals

Approval details

EAC		7500651.22.01.00246
-----	---	---------------------

EAC		EAC-Zulassung
-----	--	---------------

Phoenix Contact 2019 © - all rights reserved
<http://www.phoenixcontact.com>

PHOENIX CONTACT GmbH & Co. KG
Flachsmarktstr. 8
32825 Blomberg
Germany
Tel. +49 5235 300
Fax +49 5235 3 41200
<http://www.phoenixcontact.com>