

Fit label as shown 25mm from 'D' Sub

Note : Unit is supplied Un-Terminated  
ie: - Switch in OFF position

( $\phi 0.59''/14.5$ )

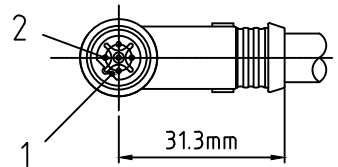

POL	MATERIAL NUMBER	ENGINEERING NUMBER	FINISHED LENGTH
5	1200985007	BM5S33PP4M010	3.28' +2.19" -0 [1.0M +55.6 -0]

Face View (Typ.)

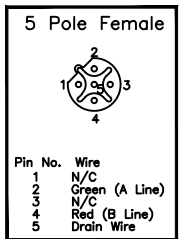

Face View

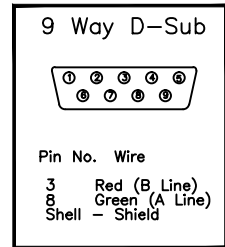

CONNECTOR SPECIFICATION:

VOLTAGE RATING	30V AC/DC
AMPERAGE RATING	4 AMPS
PROTECTION CLASS	IP67
OPERATING TEMPERATURE	STATIC: -40°C TO +80°C FLEXING: -20°C TO +80°C
UL CERTIFICATIONS	NOT APPLICABLE
CSA CERTIFICATIONS	NOT APPLICABLE

ITEM	COMPONENT	MATERIAL	FINISH
1	INSERT	POLYURETHANE (PUR)	BLACK
2	CONTACT MATERIAL	COPPER ALLOY	GOLD OVER NICKEL
3	COUPLING NUT	BRASS	NICKEL PLATED
4	OVERMOLD	TPU	YELLOW
5	CABLE 2x0.2 <sup>2</sup> /24 AWG	JACKET: PUR	JACKET: VIOLET

DESCRIPTION EC NO: IPG2012-0445 DRWN: BBRAUCH 28.02.12 CHKD: REISSNER APPR: REISSNER 2010/01/28	QUALITY SYMBOLS ▽ = 0 ▽ = 0	GENERAL TOLERANCES (UNLESS SPECIFIED) mm INCH 4 PLACES ± --- ± --- 3 PLACES ± --- ± --- 2 PLACES ± --- ± 0.1 1 PLACE ± 0.3 ± --- ANGULAR ± --- °	DIMENSION STYLE IN/MM DRAWN BY DATE BBRAUCH 2010/01/25 CHECKED BY DATE NS 2010/01/28 APPROVED BY DATE REISSNER 2010/01/28 MATERIAL NO.	SCALE 2:1 DESIGN UNITS METRIC THIRD ANGLE PROJECTION	CSE M12 5P BC FEFE RA DSUB PUR XM SHLD YL BRA M12 PROFIBUS CABLE
	DRAFT WHERE APPLICABLE MUST REMAIN WITHIN DIMENSIONS		SEE TABLE	MOLEX INCORPORATED DOCUMENT NO. SD-120098-037	SHEET NO. 1 OF 1
	THIS DRAWING CONTAINS INFORMATION THAT IS PROPRIETARY TO MOLEX INCORPORATED AND SHOULD NOT BE USED WITHOUT WRITTEN PERMISSION				
	2	REV			