

PANDUIT PART NUMBER	WEIGHT
FTRBE58	0.54 LB/EACH (243g/EACH)

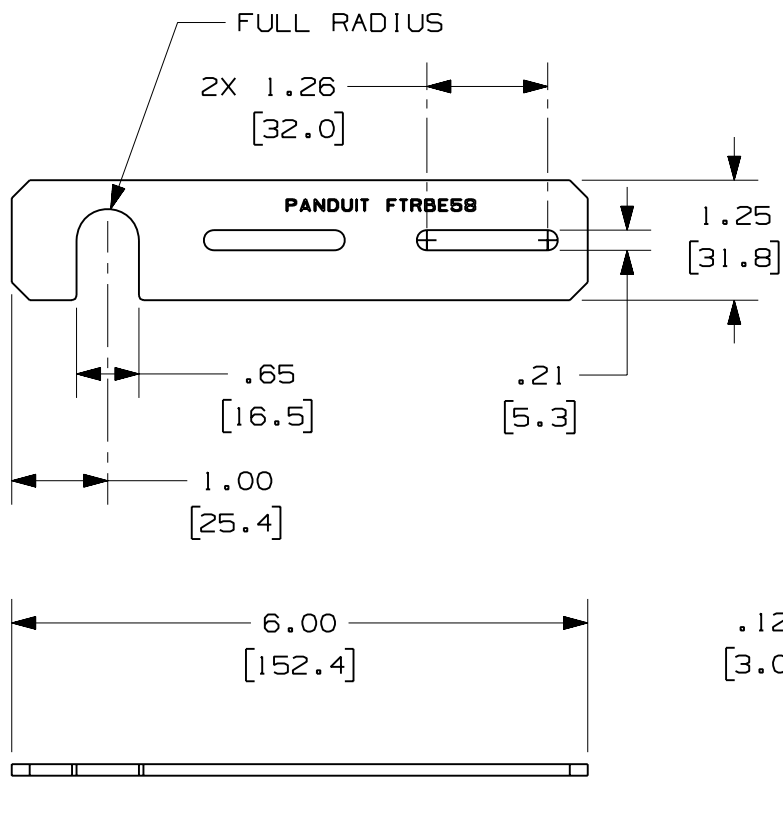

NOTES:

1. SEE CURRENT CATALOG FOR ADDITIONAL PART SUFFIXES TO INDICATE PACKAGE QUANTITY.
2. THE FIBER-DUCT 2x2, 4x4 AND FIBERRUNNER 2x2 EXISTING THREADED ROD BRACKET IS USED TO SUPPORT THE FIBER-DUCT 2x2, 4x4 AND FIBERRUNNER 2x2 CABLE ROUTING SYSTEMS FROM A SECTION OF EXISTING 5/8" THREADED ROD.
3. THE FIBER-DUCT 2x2, 4x4 AND FIBERRUNNER 2x2 EXISTING THREADED ROD BRACKET INCLUDES:
ONE (1) BRACKET,
TWO (2) 5/8-11 SPLIT LOCK NUTS,
TWO (2) #10-32x1/2 PAN HEAD SLOTTED MACHINE SCREWS,
TWO (2) #10-32 HEX MACHINE SCREW NUTS,
TWO (2) #10 HELICAL SPRING LOCKWASHERS.
4. FINISH COLOR: YELLOW ZINC DICHROMATE (EXCEPT HARDWARE)
5. DIMENSIONS IN PARENTHESES ARE IN METRIC.

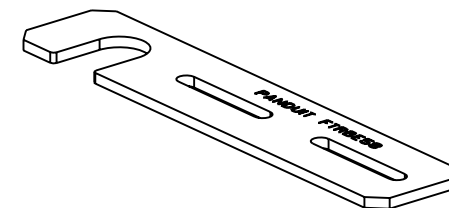

ENG. REF.: D35245CJ_DC_FTRBE58_00.prt

CAD FILENAME/LAYERS		FTRBE58.pdf	
PANDUIT CORP		TINLEY PARK, ILLINOIS	
FIBER-DUCT 2x2, 4x4 AND FIBERRUNNER 2x2 EXISTING THREADED ROD BRACKET - 5/8" THREADED ROD (FTRBE58) CUSTOMER DRAWING			
UNLESS OTHERWISE SPECIFIED, DIMENSIONAL TOLERANCES ARE: (.X) ± (.XXX) ± (.XX) ± .03 (.8) ANGLES ±		UNLESS OTHERWISE SPECIFIED, ALL DIMENSIONS ARE GIVEN IN INCHES, THIRD ANGLE PROJECTION.	
DRAWN BY	MAT'L:	SCALE	NONE
MSO	STEEL	DRAWING NO.	35245-36
DATE		DWG	
12-27-06			A
CHK'D			SIZE
	RN		

REV	DATE	BY	CHK	DESCRIPTION	ECN	R	CUST	SUP	GMBH
R	12-27-06	MSO	RN	RELEASED TO PRODUCTION	35245-36	RN	RN		