

SIDE VIEW

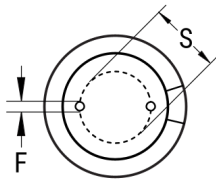

TERMINAL END VIEW



Click [here](#) for the 3D model.

### Dimensions

D	8mm +/-0.5mm
L	11mm +1.5mm
S	3.5mm +/-0.5mm
LL Negative	15mm MIN
LL Positive	20mm MIN
F	0.6mm NOM

### Packaging Specifications

Packaging	Bulk, Bag
Packaging Quantity	6000

### General Information

Series	ESX
Dielectric	Aluminum Electrolytic
Description	Single Ended Aluminum Electrolytic
RoHS	Yes
Lead	Wire Leads
AEC-Q200	No

### Specifications

Capacitance	220 uF
Capacitance Tolerance	20%
Voltage DC	16 VDC, 20 VDC (Surge)
Temperature Range	-40/+105°C
Rated Temperature	105°C
Life	2000 Hrs
Dissipation Factor	16%
Resistance	0.33 Ohms (ESR, 100kHz 25C), 0.33 Ohms (Z, 100kHz 20C)
Ripple Current	410 mAmps (100kHz 105C)
Leakage Current	44 uA (2min 20°C)
Impedance Ratio at -25C	3
Impedance Ratio at -40C	5