

THIS DRAWING IS UNPUBLISHED. RELEASED FOR PUBLICATION
 © COPYRIGHT - By - ALL RIGHTS RESERVED.

LOC		DIST		REVISIONS					
AF		50		P	LTR	DESCRIPTION	DATE	DWN	APVD
				B3		ECR-15-005665	10AUG2015	BDA	PKS

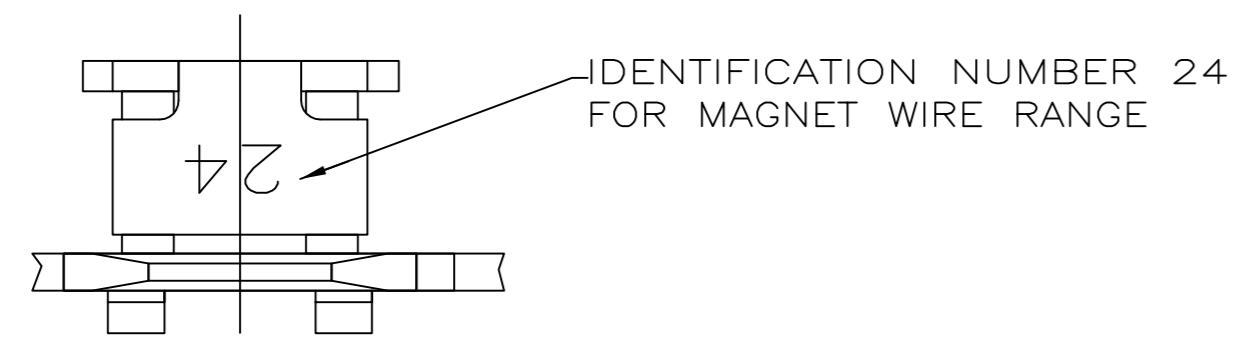

- CONTINUOUS STRIP ON REELS WITH TERMINALS LOCATED ON 5.59 ± 0.08 [$.220 \pm .003$] CENTERS. SLOT TERMINATES A SINGLE MAGNET WIRE ONLY. COPPER RANGE: 0.91-1.15mm [#19-#17] AWG. ALUMINUM RANGE: 0.95-1.15mm [#18.5-#17] AWG. ALUMINUM WIRE RANGE APPLIES FOR POST-TIN PLATED VERSIONS ONLY. ALTERNATE RANGE: 0.95-1.15mm [#18.5-#17] AWG.
- AFTER INSERTION INTO PLASTIC HOLDER TAB PORTION MUST BE BENT OVER 45° TO 90° OR
- POTTED-IN TO PREVENT PULL-OUT WHEN MATING RECEPTACLE IS DISCONNECTED.

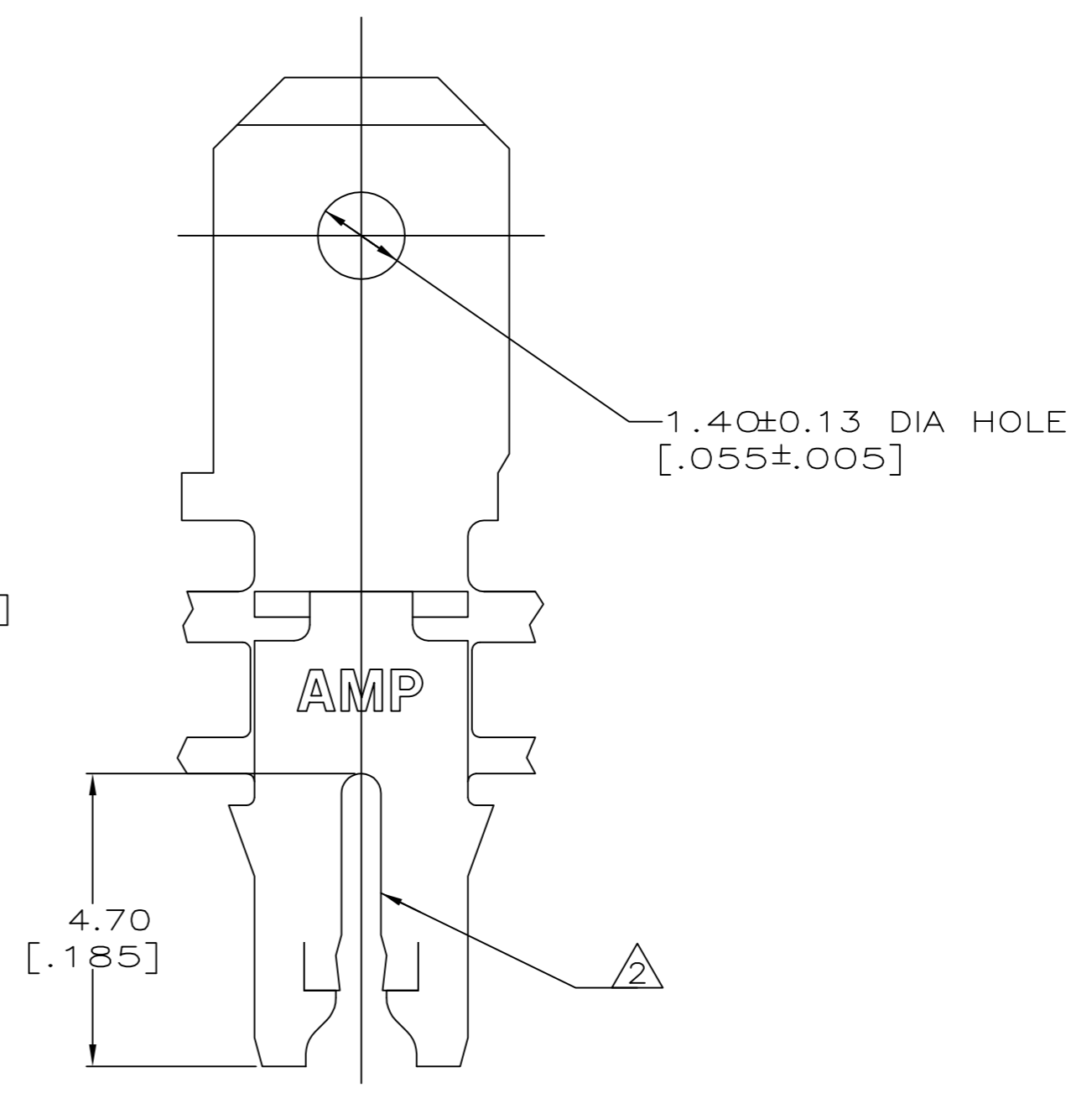
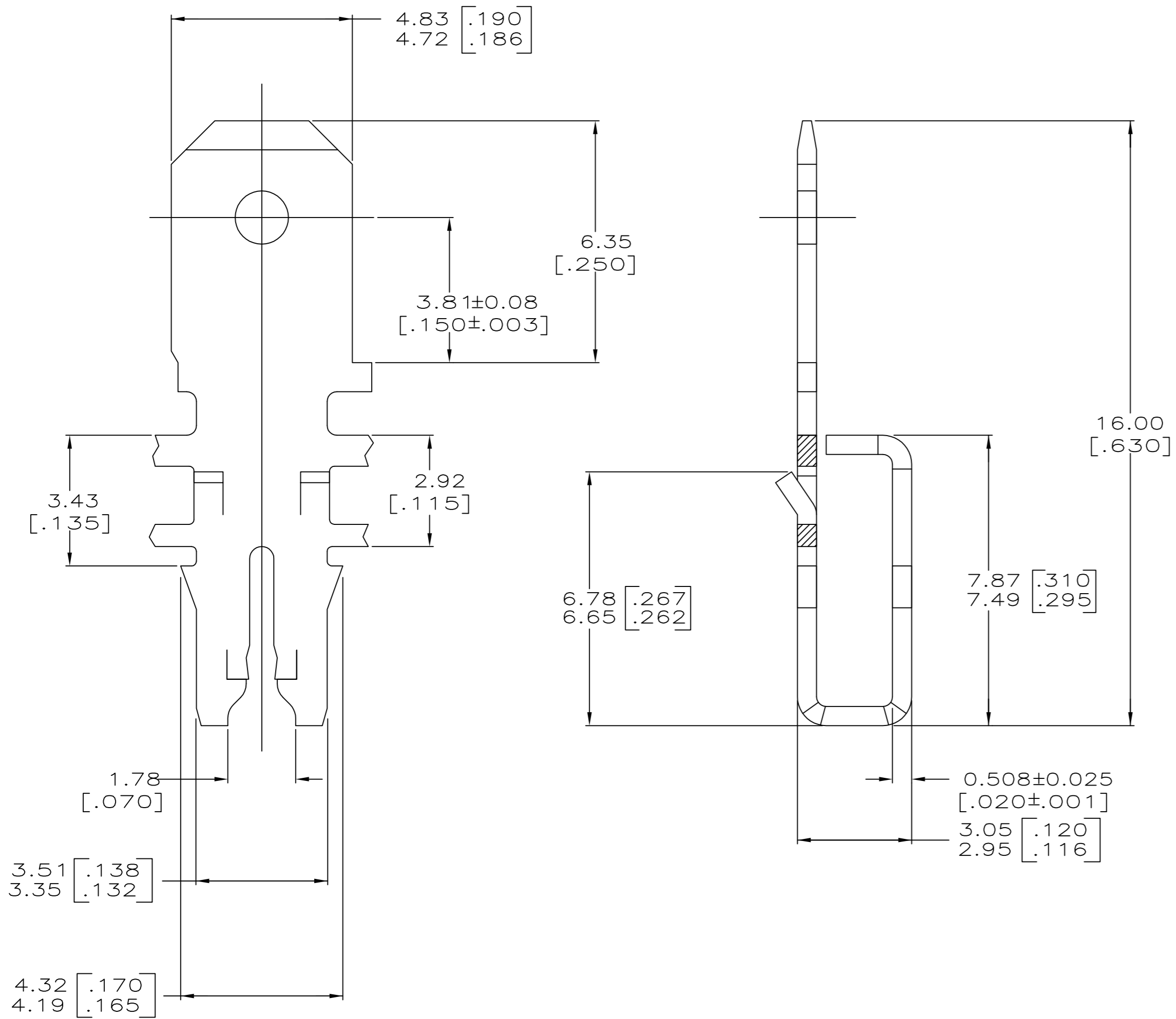

63782-1

THIS DRAWING IS A CONTROLLED DOCUMENT.		DWN	22/MAR/94	TE Connectivity	
		CHK	25/MAR/94	MICHAEL S. FEHER	
		APVD	28/MAR/94	PHILLIP M. FORTNEY	
		NAME	NELSON E NEFF		
DIMENSIONS:		TOLERANCES UNLESS OTHERWISE SPECIFIED:		PRODUCT SPEC	
INCHES				108-2012	
				APPLICATION SPEC	
				114-2067	
MATERIAL		WEIGHT		RESTRICTED TO	
BRASS		-		-	
		FINISH		SCALE	
		TIN PLATED		10:1	
		CUSTOMER DRAWING		SHEET	
				1 of 1	
				REV	
				B3	