

SCNRJ - 8 8 SG N N N N - 47 4F SO RTH

SUNTSU
RJ45
CONNECTOR

CONTACTS
8 : 8

MAGNETIC
N : None

EMI Finger
N : None

OPERATING TEMP
47 : -40~70°C

CONTACT TERMINATION
SO : SOLDER

POSITIONS
8 : 8

CONTACT PLATING
SG : Selective Gold
Plating

SHIELD
N : None

LED COLOR
N : None

HEIGHT
4F : 14.5mm

MOUNTING STYLE
RTH : Right Angle
Through Hole

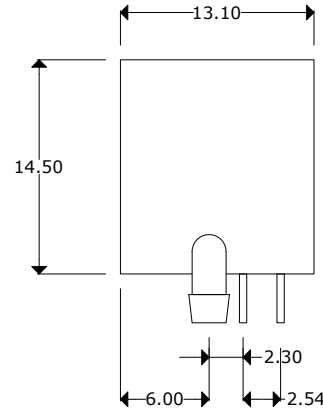
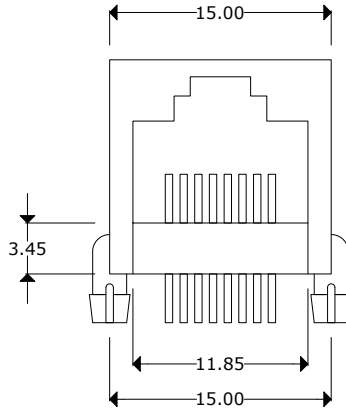
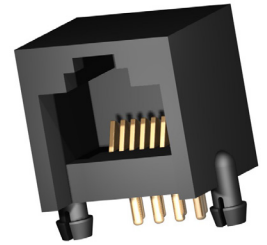

PC Board Layout

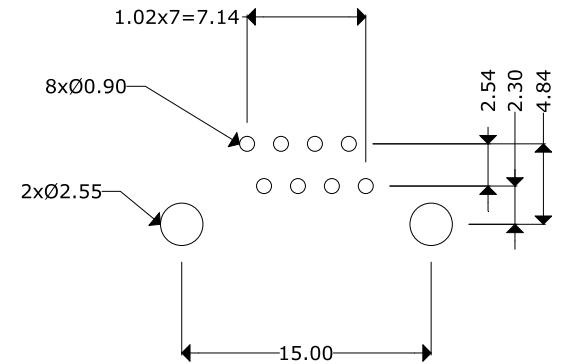

Electrical Parameters

Voltage Rating: 125V
 Current Rating: 1.5A
 Contact Resistance: 30mΩ Max
 Insulation Resistance: 500MΩ/min.
 Dielectric Withstanding Voltage: 1000V

Materials

Housing: PBT, UL94V-0
 Insert: PBT, UL94V-0
 Conductor: Stamping Pin, Phosphor Bronze
 Plating: 6" Gold plated over nickel

Remarks:
 Operating Life: 750 Cycles MIN.



RJ45 JACK SIDE ENTRY

Document History			
Edits Made	Date	Edited By	Approved By
Initial Release	10/22/2021	B. Gibbons	KH Mun

Part No.	SCNRJ-88GGNNNN-474FSORTH	Drawn	B. Gibbons 10/22/2021
Scale	Not drawn to scale	Tolerance	.x±0.25 Unless otherwise stated, tolerances are .xx±0.20
Unit	mm	Pages	1/1