

7 6 5 4 3 2 1

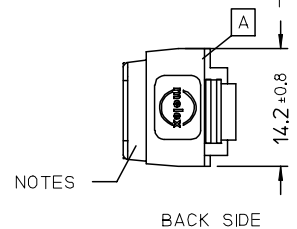
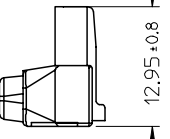
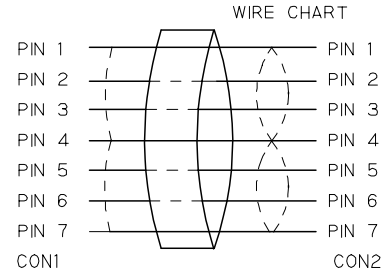
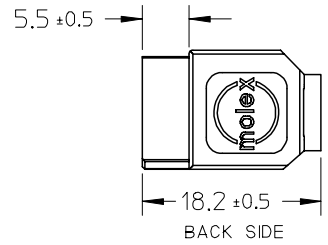
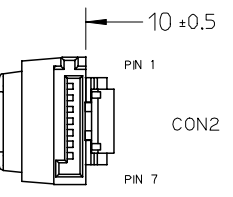
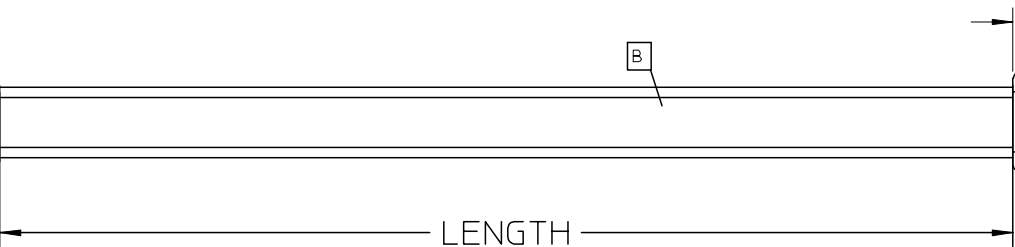
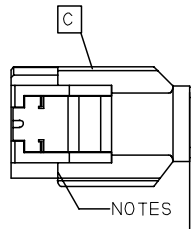
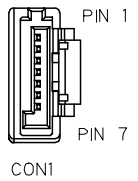

NOTE:
 PHYSICAL
 1. OUTER MOLD WITH BLACK PVC RESIN 887800042.
 INNER MOLD WITH PE RESIN 887800008.
 ELECTRICAL PERFORMANCE:
 2. DIELECTRIC STRENGTH:500V DC/0.01S.
 3. INSULATION RESISTANCE:100M OHMS MIN.
 4. CONDUCTIVE RESISTOR: 2 OHMS MAX.

MOLEX P/N	LENGTH (mm)	LENGTH (inch)	DESCRIPTION
68561-0017	1000+/-20	40.0+/-0.8	S-ATA LATCHING STRAIGHT TO R/A CABLE. RED
68561-0016	500+/-10	20.0+/-0.4	S-ATA LATCHING STRAIGHT TO R/A CABLE. RED

ITEM	DESCRIPTION	QTY.
C	S-ATA STRAIGHT CONN. 674899002	1
B	2PX26AWG S-ATA CABLE RED 887808052	1
A	S-ATA R/A CONN. 674890002	1

ENTER DESCRIPTION EC NO: DG2005-0125 DRWN: JLIU13 CHKD: TEDDY APPR: TKAN	2005/04/04 2005/04/04 2005/04/04	DESCRIPTION REV	QUALITY SYMBOLS	GENERAL TOLERANCES (UNLESS SPECIFIED)	DIMENSION STYLE	SCALE	DESIGN UNITS	THIRD ANGLE PROJECTION
			▼=0 □=0	mm INCH	MM ONLY	---	METRIC	
			4 PLACES ± --- ± --- 3 PLACES ± --- ± --- 2 PLACES ± --- ± --- 1 PLACE ± --- ± ---	DRAWN BY: JLIU13 DATE: 2005/04/04 CHECKED BY: TEDDY DATE: 2005/04/04 APPROVED BY: BORON DATE: 2005/04/04	TITLE			
			ANGULAR ± ---° DRAFT WHERE APPLICABLE MUST REMAIN WITHIN DIMENSIONS	MATERIAL NO. 685610017 DOCUMENT NO. SD-68561-0017 SHEET NO. 1 OF 1	S-ATA STRAIGHT LATCHING TO R/A LATCHING SIGNAL CBL RED,0.5M,1.0M MOLEX INCORPORATED			

6 5 4 3 2 1

THIS DRAWING CONTAINS INFORMATION THAT IS PROPRIETARY TO MOLEX INCORPORATED AND SHOULD NOT BE USED WITHOUT WRITTEN PERMISSION

7 6 5 4 3 2 1

REVISION				
EC NO.	DATE	REV.	DESCRIPTION	CHANGER
CY11-6493	2011/04/13	G	CHANGE CABLE	ZLLI
CY15-5216	2014/08/26	H	CHANGE CABLE	LUCY

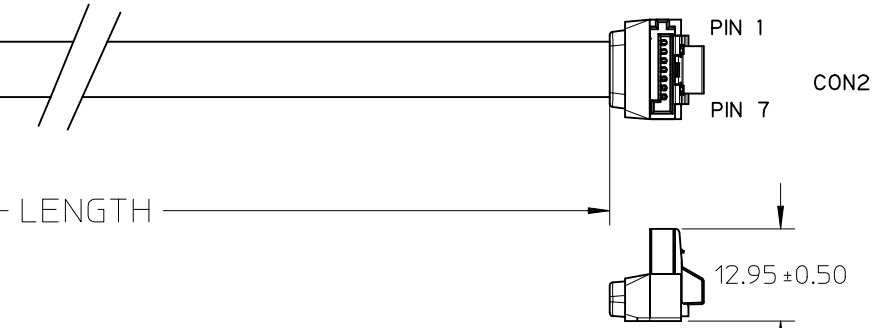
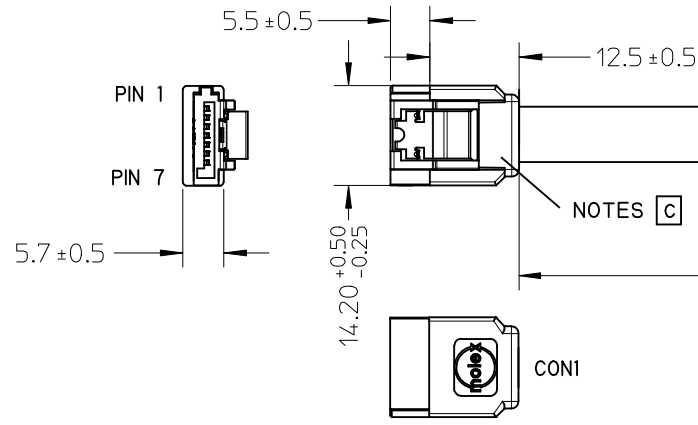

NOTE:

1. OUTER MOLD WITH BLACK PVC RESIN
INNER MOLD WITH PE RESIN
ELECTRICAL PERFORMANCE:
2. DIELECTRONIC STRENGTH:500V DC/0.01S
3. INSULATION RESISTANCE:100M OHMS MIN.
4. CONDUCTIVE RESISTOR: 2 OHMS MAX.
5. THIS PRODUCT MECHANICAL AND ELECTRICAL PERFORMANCE REFER TO SATA INDUSTRIAL STANDARD.

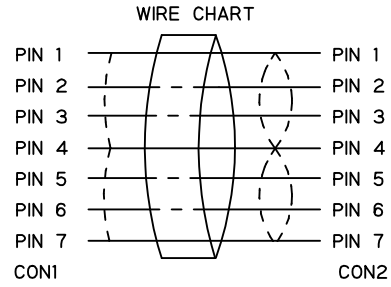

MOLEX P/N	LENGTH (mm)	LENGTH (inch)	DESCRIPTION
685610017	1000+/-20	40.0+/-0.8	S-ATA LATCHING STRAIGHT TO R/A CABLE, RED
685610016	500+/-10	20.0+/-0.4	S-ATA LATCHING STRAIGHT TO R/A CABLE, RED

C	S-ATA STRAIGHT CONN.	1	
B	2PX26AWG;SHLD;PVC;RD;2.2X7.6MM;SATA 1.0	SEE TABLE	1
A	S-ATA R/A CONN.	1	
ITEM	DESCRIPTION	L	QTY.

ENTER DESCRIPTION EC NO: CPG2015-1374 DRWN: JXIA004 CHKD: LUCY APPR: FNIE	QUALITY SYMBOLS ▽=0 ◻=0	GENERAL TOLERANCES (UNLESS SPECIFIED)		DIMENSION STYLE MM ONLY		SCALE ---	DESIGN UNITS METRIC	THIRD ANGLE PROJECTION	
		4 PLACES ±--- ±--- 3 PLACES ±--- ±--- 2 PLACES ±--- ±--- 1 PLACE ±--- ±---		DRAWN BY GX YANG	DATE 04/08/10	TITLE S-ATA STRAIGHT LATCHING TO R/A LATCHING SIGNAL CBL RED.0.5M,1.0M			
		ANGULAR ±---°		CHECKED BY TEDDY	DATE 04/08/10	MOLEX INCORPORATED			
		DRAFT WHERE APPLICABLE MUST REMAIN WITHIN DIMENSIONS		APPROVED BY BORON	DATE 04/08/10	MATERIAL NO. 685610016/7	DOCUMENT NO. SD-68561-002	SHEET NO. 1 OF 1	

6 5 4 3 2 1