

# CODINGS

<b>P/N°:</b> 0987861011	<b>P/N°:</b> 0987861019	<b>P/N°:</b> 0987861018	<b>P/N°:</b> 0987861016
<b>COLOR:</b> BLACK	<b>COLOR:</b> BROWN	<b>COLOR:</b> GREY	<b>COLOR:</b> BLUE

## MINIMUM FREE SPACE FOR ASSEMBLY

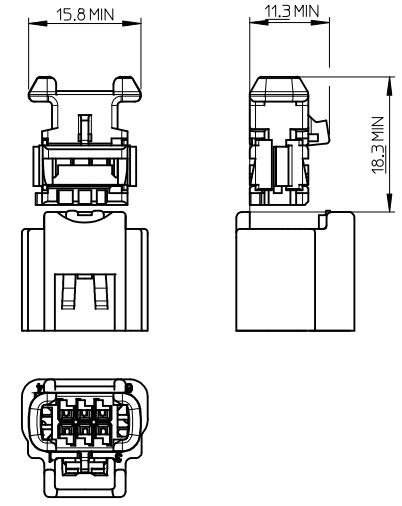

NECESSARY VOLUME FOR THE HOUSING ASSEMBLY.  
ALLOW AN ADDITIONAL VOLUME FOR THE UNMATING

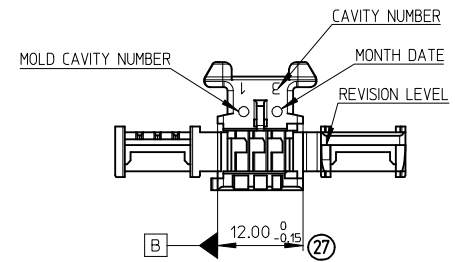
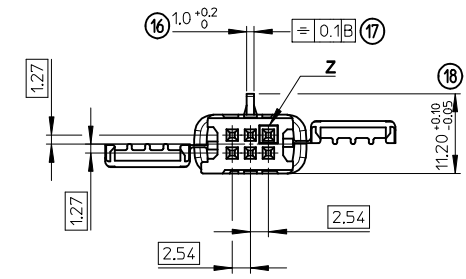
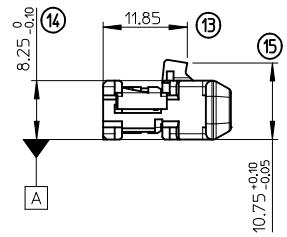
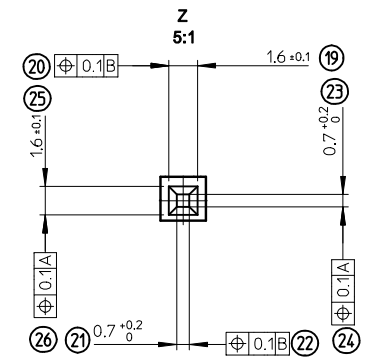
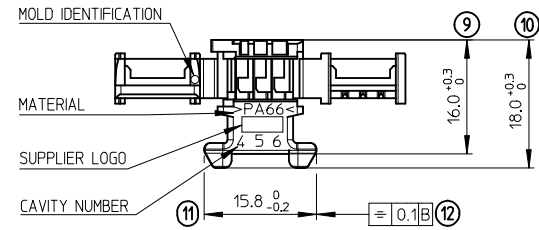

### NOTES:

- 1- MATERIAL : POLYAMIDE (PA66) UNFILLED UL94V-2
- 2- USE WITH : 98658 (MOX 0.63 TERMINAL)
- 3- APPLICATION SPECIFICATION : AS-98787-001
- 4- MATE WITH : SERIES 98780 (HEADER)
- 5- WEIGHT : 1,060 g

### ISO VIEW

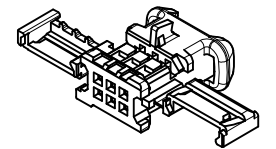

REVISÉ EC NO: G2013-0071 DRWN:DDSSANTOS 2011/02/22 CHKD:HERBELIN 2012/09/17 APPR:PLESSIS 2012/11/23	DESCRIPTION [REDACTED]	GENERAL TOLERANCES (UNLESS SPECIFIED)		DIMENSION STYLE <b>MM ONLY</b>		SCALE 2:1	DESIGN UNITS METRIC	FIRST ANGLE PROJECTION		
		4 PLACES ± --- ± ---	3 PLACES ± --- ± ---	2 PLACES ± 0.05 ± ---	1 PLACE ± 0.1 ± ---	0 PLACE ± --- ± ---	DRAWN BY VGUERIN	DATE 2008/03/07	TITLE MOX RCPT HSG 0.635 CEM 6CKT	
		ANGULAR ± 2 °					CHECKED BY JLDUCLOS	DATE 2008/03/07	APPROVED BY LSTICKEIR	
		DRAFT WHERE APPLICABLE MUST REMAIN WITHIN DIMENSIONS					MATERIAL NO. SEE CHART	DOCUMENT NO. SD-98786-001	SHEET NO. 1 OF 1	

# CODINGS

<b>P/N°:</b> 0987861011	<b>P/N°:</b> 0987861019	<b>P/N°:</b> 0987861018	<b>P/N°:</b> 0987861016
<b>COLOR:</b> BLACK	<b>COLOR:</b> BROWN	<b>COLOR:</b> GREY	<b>COLOR:</b> BLUE

## MINIMUM FREE SPACE FOR ASSEMBLY

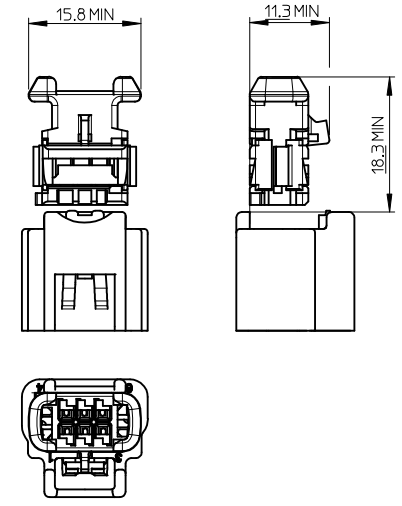

NECESSARY VOLUME FOR THE HOUSING ASSEMBLY.  
ALLOW AN ADDITIONAL VOLUME FOR THE UNMATING

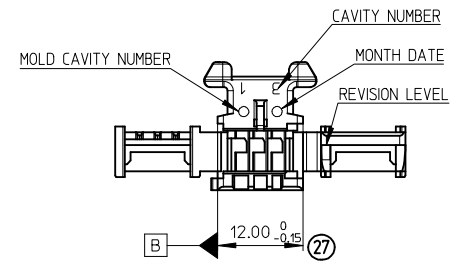
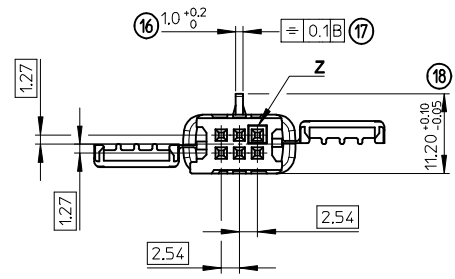
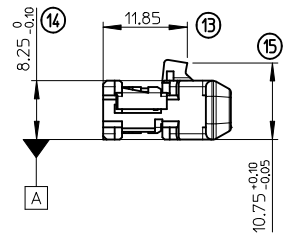
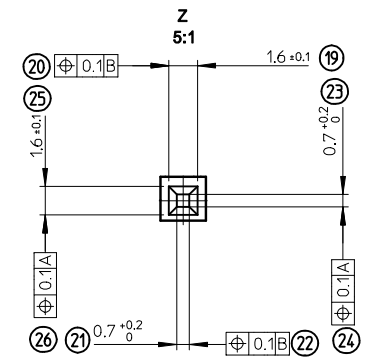
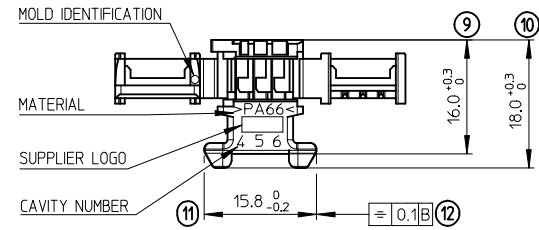

### NOTES:

- 1- MATERIAL : POLYAMIDE (PA66) UNFILLED UL94V-2
- 2- USE WITH : 98658 (MOX 0.63 TERMINAL)
- 3- APPLICATION SPECIFICATION : AS-98787-001
- 4- MATE WITH : SERIES 98780 (HEADER)
- 5- WEIGHT : 1,060 g

### ISO VIEW

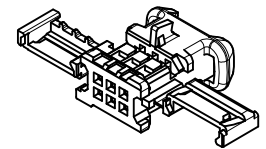

<b>REVISED</b> EC NO: G2013-0071 DRWN:DDSSANTOS 2011/02/22 CHKD:HERBELIN 2012/09/17 APPR:PLESSIS 2012/11/23	DESCRIPTION [REDACTED]	GENERAL TOLERANCES (UNLESS SPECIFIED)		DIMENSION STYLE <b>MM ONLY</b>		SCALE 2:1	DESIGN UNITS METRIC	FIRST ANGLE PROJECTION		
		4 PLACES ± --- ± ---	3 PLACES ± --- ± ---	2 PLACES ± 0.05 ± ---	1 PLACE ± 0.1 ± ---	0 PLACE ± --- ± ---	DRAWN BY VGUERIN	DATE 2008/03/07	TITLE MOX RCPT HSG 0.635 CEM 6CKT	
		ANGULAR ± 2 °					CHECKED BY JLDUCLOS	DATE 2008/03/07	<b>molex</b>	
		DRAFT WHERE APPLICABLE MUST REMAIN WITHIN DIMENSIONS					APPROVED BY LSTICKEIR	DATE 2008/03/07	MATERIAL NO. SD-98786-001	SHEET NO. 1 OF 1

### SEE CHART

THIS DRAWING CONTAINS INFORMATION THAT IS PROPRIETARY TO MOLEX INCORPORATED AND SHOULD NOT BE USED WITHOUT WRITTEN PERMISSION