

REV.	EN. NO.	DESCRIPTION	SIGN	DATE
C1	N/A	INITIAL DRAWING	Liu	2019/08/13

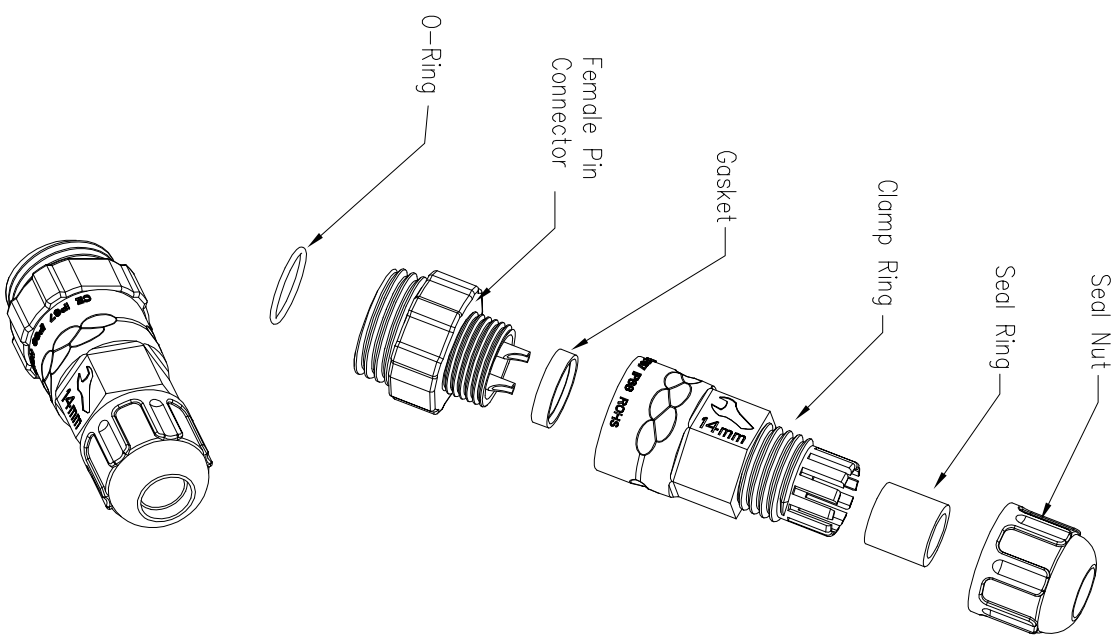
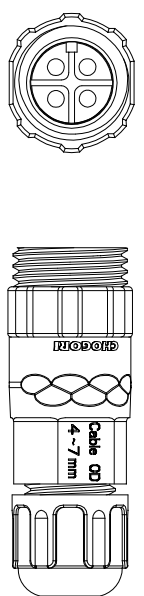
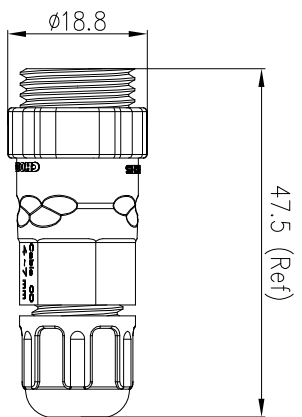

- Specification:
- 1.Operation Temperature: -45°C~105°C.
  - 2.Insulation Resistance: 100MΩ at DC500V.
  - 3.Contact Resistance: <10mΩ
  - 4.Withstand Voltage: 1500V AC
  - 5.Operating Current:10A
  - 6.Operating Voltage: AC 125V
  7. Waterproof Rate: IP67 (Mated)
  8. Seal Nut: Nylon, Black
  9. Seal Ring: Silicon, Black
  10. Clamp Ring: Nylon, Black
  11. Gasket: Silicon, Red
  12. Female Pin: Copper Alloy, Gold Plated
  13. Connector: Nylon+GF, Black
  14. O-Ring: Silicon, Red
  15. RoHS Compliant.
  16. UL Compliant.
  17. Cable Range OD: φ3.5mm~φ6.8mm
  18. Mating Cap: 806-00060-01

22XXX411-01

Pin Number

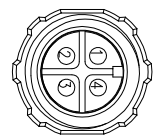

4 Pin

P/N: 22004411-01

Pin Assignments  
Front View



UNIT: mm	±0.25
TOLERANCE	±0.15
.X	±0.05
.XX	
.XXX	
ANGLES	±1°

DESCRIPTION	Standard Series Screw			
SCALE	1:1	SHEET	1 OF 1	
REV	C1	SIZE	A4	* : Inspection Item

**CHOGORI**

PART NO	22XXX411-01	DRAWN BY	Liu	DATE	2019/08/13
---------	-------------	----------	-----	------	------------

DWG NO		CHECKED BY	Mo	DATE	2019/08/13
--------	--	------------	----	------	------------

CUSTOMER		APPROVED BY	Panison	DATE	2019/08/13
----------	--	-------------	---------	------	------------