

P	LTR	DESCRIPTION	DATE	DWN	APVD
	A	REVISED (ECR-22-161842)	10JAN2023	LP	DSC

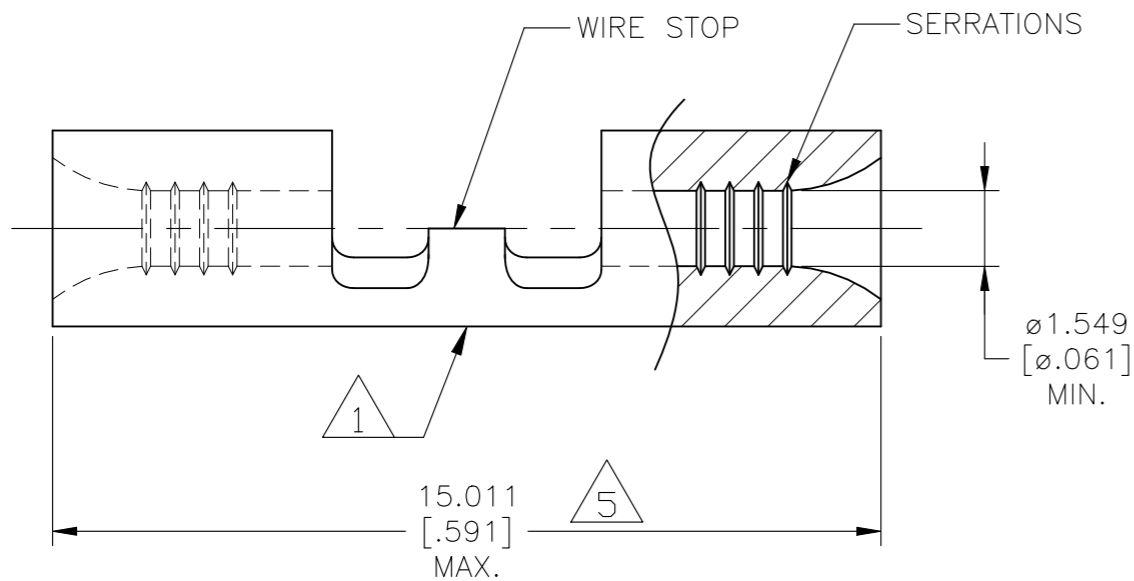
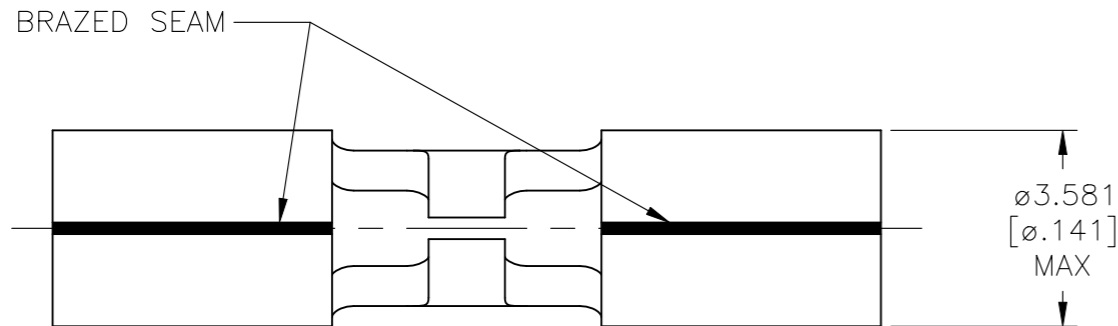

- 1 STAMP AMP 18-16 APPROX AS SHOWN
- 2. BODY MATERIAL THK: 0.787±0.051[.031±.002]
- 3 MATERIAL:
COPPER PER ASTM B152, ANNEALED
- 4 FINISH:
GOLD PLATE 0.00127[.00005] MIN EXT THK PER ASTM B488, TYPE 1, CODE C
OVER NICKEL PLATE 0.00076[.00003] MIN EXT THK PER SAE AMS-QQ-N-290
OVER CU FLASH PER SAE AMS2418
- 5 MAXIMUM LENGTH DOES NOT INCLUDE MANUFACTURING TABS

1000	LOOSE PIECE	328592
QTY	PACKAGE TYPE	PART NO.

AMP INCORPORATED
CUSTOMER SERVICE SYSTEMS

MAX RECOMMENDED OPERATING TEMPERATURE:
260°C [500°F] MAX

VOLTAGE RATING:
NOT APPLICABLE

WIRE CROSS SECTIONAL AREA RANGE:
0.65-1.65mm² [1289-3260]
SOLID OR STRANDED

THIS DRAWING IS A CONTROLLED DOCUMENT FOR AMP INCORPORATED. IT IS SUBJECT TO CHANGE AND THE CONTROLLING ENGINEERING ORGANIZATION SHOULD BE CONTACTED FOR THE LATEST REVISION.

THIS DRAWING IS A CONTROLLED DOCUMENT.

DIMENSIONS: mm [INCHES]	TOLERANCES UNLESS OTHERWISE SPECIFIED:
	0 PLC ± -
	1 PLC ± -
	2 PLC ± -
	3 PLC ± 0.127[.005]
	4 PLC ± -
	ANGLES ± -
MATERIAL	FINISH
3	4

DWN	09JAN2023
LINGANATHAN P.	
CHK	09JAN2023
SUVARNA, CHETHAN D	
APVD	09JAN2023
SUVARNA, CHETHAN D	
PRODUCT SPEC	
APPLICATION SPEC	
WEIGHT	-



NAME				SPLICE, BUTT, SOLISTRAND, WIRE SIZE: 18-16 AWG	
SIZE	CAGE CODE	DRAWING NO	RESTRICTED TO		
A3	00779	C-328592	-		
CUSTOMER DRAWING		SCALE	SHEET	REV	
		5:1	1 OF 1	A	