

THIS DRAWING IS UNPUBLISHED. RELEASED FOR PUBLICATION
 © COPYRIGHT - By - ALL RIGHTS RESERVED.

LOC	DIST	REVISIONS					
AF	50	P	LTR	DESCRIPTION	DATE	DWN	APVD
		E2		ECR-13-017177	05NOV13	PKS	RRP

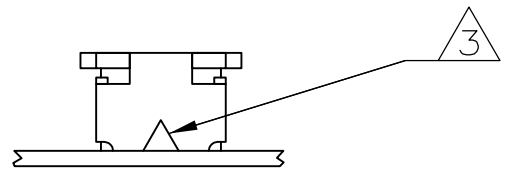

- 1 CONTINUOUS STRIP ON REELS WITH TERMINALS LOCATED ON 5.59 [.220] CENTERS.
- 2 SLOT ACCEPTS 0.81mm [#20] AWG COPPER MAGNET WIRE.
- 3 POKE-IN ACCEPTS A 0.81-1.02mm² [#20-#18] AWG SOLID OR FUSED STRANDED LEAD WIRE.

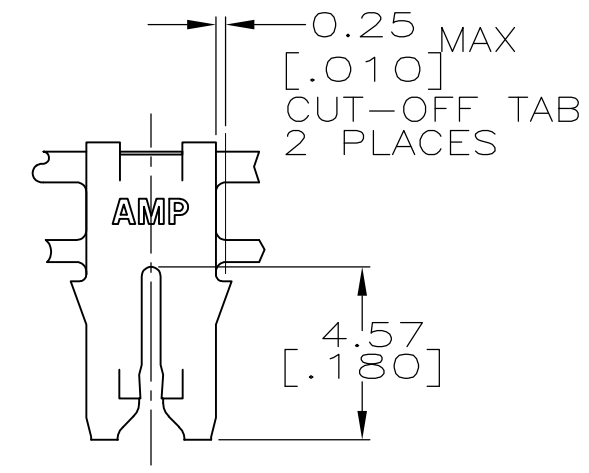
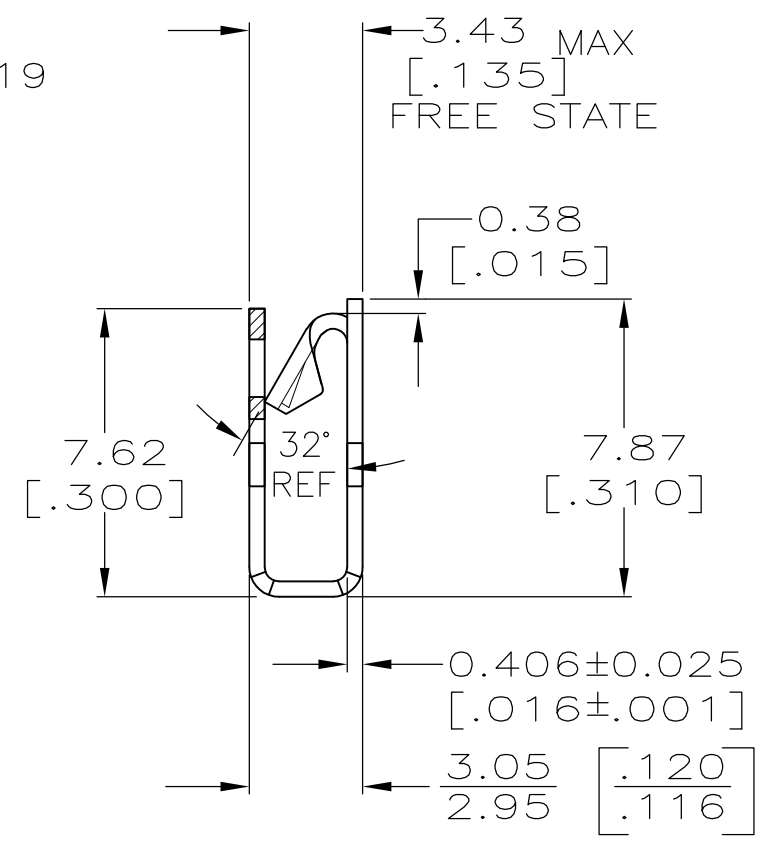
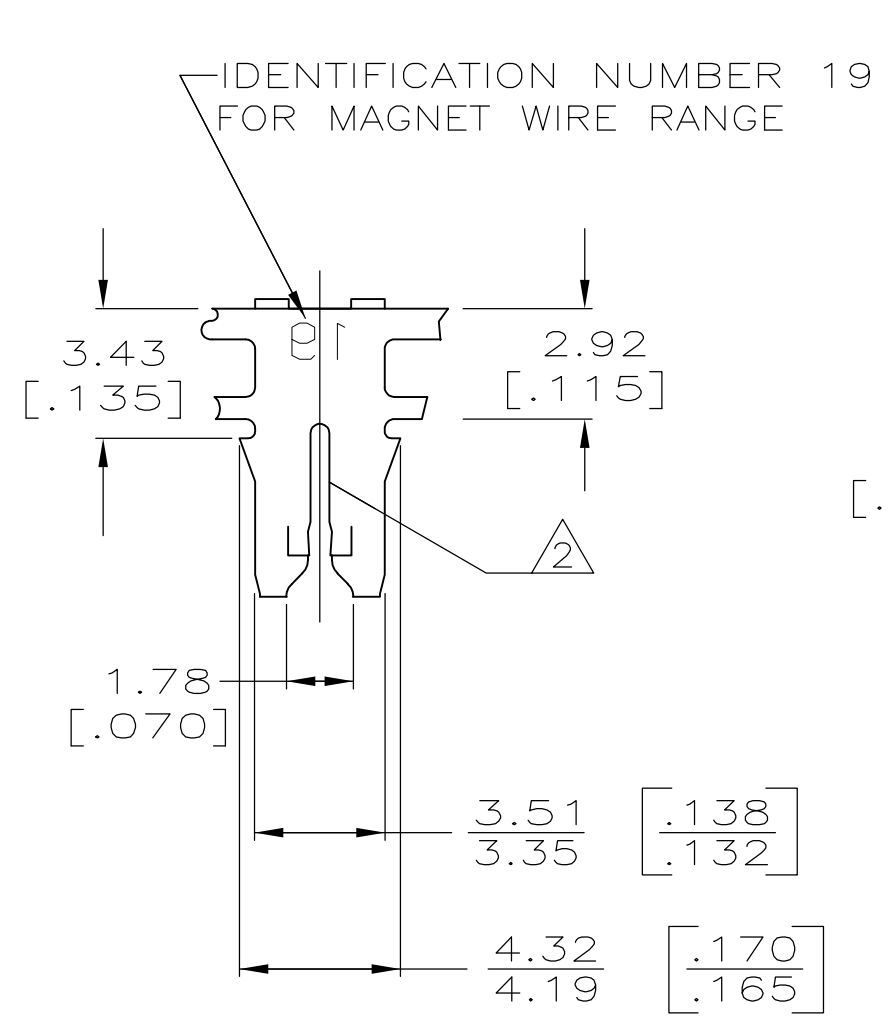

63591-1
 PART NUMBER

THIS DRAWING IS A CONTROLLED DOCUMENT.		DWN 8/14/90 MICHAEL S. FEHER	STE TE Connectivity	
DIMENSIONS: mm [INCHES]		CHK 8/20/90 PHILLIP M. FORTNEY		
TOLERANCES UNLESS OTHERWISE SPECIFIED:		APVD 8/20/90 NELSON E. NEFF	NAME TERMINAL, POKE-IN, 300 SERIES MAG-MATE™	
0 PLC ± -		PRODUCT SPEC	-	
1 PLC ± -		APPLICATION SPEC	-	
2 PLC ± 0.25 [.010]		114-2046	SIZE	CAGE CODE
3 PLC ± -		WEIGHT	A3	00779
4 PLC ± -		CUSTOMER DRAWING	DRAWING NO	C-63591
ANGLES ± -		SCALE	5:1	SHEET
MATERIAL	FINISH	RESTRICTED TO	1 OF 1	REV
BRASS	TIN PLATED	-		E2