

0.50MM CENTER FLAT FLEX CABLE (FFC) (EXTRA FLEXIBLE, 105°C, Sn PLATED)

"L" DIM. →	30 ± 2 MM		51 ± 2 MM		76 ± 3 MM		102 ± 3 MM		127 ± 4 MM		152 ± 4 MM		178 ± 4 MM		203 ± 4 MM		229 ± 5 MM		254 ± 5 MM		305 ± 5 MM			
REF DIM →	(1.18 INCH)		(2 INCHES)		(3 INCHES)		(4 INCHES)		(5 INCHES)		(6 INCHES)		(7 INCHES)		(8 INCHES)		(9 INCHES)		(10 INCHES)		(12 INCHES)			
CABLE TYPE →	A		D		A		D		A		D		A		D		A		D		A		D	
CIRCUITS ↓	A	D	A	D	A	D	A	D	A	D	A	D	A	D	A	D	A	D	A	D	A	D		
6	151660051	151660052	151660053	151660054	151660055	151660056	151660057	151660058	151660059	151660060	151660061	151660062	151660063	151660064	151660065	151660066	151660067	151660068	151660069	151660070	151660071	151660072		
8	151660073	151660074	151660075	151660076	151660077	151660078	151660079	151660080	151660081	151660082	151660083	151660084	151660085	151660086	151660087	151660088	151660089	151660090	151660091	151660092	151660093	151660094		
10	151660095	151660096	151660097	151660098	151660099	151660100	151660101	151660102	151660103	151660104	151660105	151660106	151660107	151660108	151660109	151660110	151660111	151660112	151660113	151660114	151660115	151660116		
12	151660117	151660118	151660119	151660120	151660121	151660122	151660123	151660124	151660125	151660126	151660127	151660128	151660129	151660130	151660131	151660132	151660133	151660134	151660135	151660136	151660137	151660138		
14	151660139	151660140	151660141	151660142	151660143	151660144	151660145	151660146	151660147	151660148	151660149	151660150	151660151	151660152	151660153	151660154	151660155	151660156	151660157	151660158	151660159	151660160		
16	151660161	151660162	151660163	151660164	151660165	151660166	151660167	151660168	151660169	151660170	151660171	151660172	151660173	151660174	151660175	151660176	151660177	151660178	151660179	151660180	151660181	151660182		
18	151660183	151660184	151660185	151660186	151660187	151660188	151660189	151660190	151660191	151660192	151660193	151660194	151660195	151660196	151660197	151660198	151660199	151660200	151660201	151660202	151660203	151660204		
20	151660205	151660206	151660207	151660208	151660209	151660210	151660211	151660212	151660213	151660214	151660215	151660216	151660217	151660218	151660219	151660220	151660221	151660222	151660223	151660224	151660225	151660226		
22	151660227	151660228	151660229	151660230	151660231	151660232	151660233	151660234	151660235	151660236	151660237	151660238	151660239	151660240	151660241	151660242	151660243	151660244	151660245	151660246	151660247	151660248		
24	151660249	151660250	151660251	151660252	151660253	151660254	151660255	151660256	151660257	151660258	151660259	151660260	151660261	151660262	151660263	151660264	151660265	151660266	151660267	151660268	151660269	151660270		
26	151660271	151660272	151660273	151660274	151660275	151660276	151660277	151660278	151660279	151660280	151660281	151660282	151660283	151660284	151660285	151660286	151660287	151660288	151660289	151660290	151660291	151660292		
28	151660293	151660294	151660295	151660296	151660297	151660298	151660299	151660300	151660301	151660302	151660303	151660304	151660305	151660306	151660307	151660308	151660309	151660310	151660311	151660312	151660313	151660314		
30	151660315	151660316	151660317	151660318	151660319	151660320	151660321	151660322	151660323	151660324	151660325	151660326	151660327	151660328	151660329	151660330	151660331	151660332	151660333	151660334	151660335	151660336		
32	151660337	151660338	151660339	151660340	151660341	151660342	151660343	151660344	151660345	151660346	151660347	151660348	151660349	151660350	151660351	151660352	151660353	151660354	151660355	151660356	151660357	151660358		
34	151660359	151660360	151660361	151660362	151660363	151660364	151660365	151660366	151660367	151660368	151660369	151660370	151660371	151660372	151660373	151660374	151660375	151660376	151660377	151660378	151660379	151660380		
36	151660381	151660382	151660383	151660384	151660385	151660386	151660387	151660388	151660389	151660390	151660391	151660392	151660393	151660394	151660395	151660396	151660397	151660398	151660399	151660400	151660401	151660402		
38	151660403	151660404	151660405	151660406	151660407	151660408	151660409	151660410	151660411	151660412	151660413	151660414	151660415	151660416	151660417	151660418	151660419	151660420	151660421	151660422	151660423	151660424		
40	151660425	151660426	151660427	151660428	151660429	151660430	151660431	151660432	151660433	151660434	151660435	151660436	151660437	151660438	151660439	151660440	151660441	151660442	151660443	151660444	151660445	151660446		
42	151660447	151660448	151660449	151660450	151660451	151660452	151660453	151660454	151660455	151660456	151660457	151660458	151660459	151660460	151660461	151660462	151660463	151660464	151660465	151660466	151660467	151660468		
44	151660469	151660470	151660471	151660472	151660473	151660474	151660475	151660476	151660477	151660478	151660479	151660480	151660481	151660482	151660483	151660484	151660485	151660486	151660487	151660488	151660489	151660490		
46	151660491	151660492	151660493	151660494	151660495	151660496	151660497	151660498	151660499	151660500	151660501	151660502	151660503	151660504	151660505	151660506	151660507	151660508	151660509	151660510	151660511	151660512		
48	151660513	151660514	151660515	151660516	151660517	151660518	151660519	151660520	151660521	151660522	151660523	151660524	151660525	151660526	151660527	151660528	151660529	151660530	151660531	151660532	151660533	151660534		
50	151660535	151660536	151660537	151660538	151660539	151660540	151660541	151660542	151660543	151660544	151660545	151660546	151660547	151660548	151660549	151660550	151660551	151660552	151660553	151660554	151660555	151660556		



NOTES:
 1. NO PRINTING ON JUMPER CABLE UNLESS OTHERWISE SPECIFIED. IF PRINTING IS REQUIRED, THEN IT WOULD BE CONSIDERED A SPECIAL JUMPER CABLE.
 2. FOR ODD CIRCUIT COUNT, CROSS-SECTION AND END-TAIL DETAIL REFER TO SHEET # 2

THIS DRAWING CONTAINS INFORMATION THAT IS PROPRIETARY TO MOLEX ELECTRONIC TECHNOLOGIES, LLC AND SHOULD NOT BE USED WITHOUT WRITTEN PERMISSION

DIMENSION UNITS	SCALE	CURRENT REV DESC: DRAWING CORRECTION		
MM	2:1	molex 0.50MM CENTER FLAT FLEX CABLE (FFC) (EXTRA FLEXIBLE, 105°C, SN PLATED) SALES DRAWING		
GENERAL TOLERANCES (UNLESS SPECIFIED)				
	mm	INCH	EC NO: 728054	
4 PLACES	±----	±----	DRWN: DIEGOG7	2022/11/10
3 PLACES	±----	±----	CHK'D: JSMITH11	2022/11/14
2 PLACES	±----	±----	APPR: JSMITH11	2022/11/14
1 PLACE	±----	±----	INITIAL REVISION:	
0 PLACES	±----	±----	DRWN: JLWOLFSB	2011/10/27
ANGULAR TOL ± 0.5 °		APPR: SFULTON		2011/11/03
DRAFT WHERE APPLICABLE MUST REMAIN WITHIN DIMENSIONS		THIRD ANGLE PROJECTION	DRAWING	SERIES
			C-SIZE	15166
DOCUMENT STATUS		P1	RELEASE DATE	2022/11/14 14:34:44
DOCUMENT NUMBER		CUSTOMER		SHEET NUMBER
SD-15166-001		GENERAL MARKET		1 OF 2
DOC TYPE		DOC PART	REVISION	
PSD		001	B	

0.50MM CENTER FLAT FLEX CABLE (FFC) (EXTRA FLEXIBLE, 105°C, Sn PLATED)

"L" DIM. →	30 ± 2 MM		51 ± 2 MM		76 ± 3 MM		102 ± 3 MM		127 ± 4 MM		152 ± 4 MM		178 ± 4 MM		203 ± 4 MM		229 ± 5 MM		254 ± 5 MM		305 ± 5 MM			
REF DIM →	(1.18 INCH)		(2 INCHES)		(3 INCHES)		(4 INCHES)		(5 INCHES)		(6 INCHES)		(7 INCHES)		(8 INCHES)		(9 INCHES)		(10 INCHES)		(12 INCHES)			
CABLE TYPE →	A		D		A		D		A		D		A		D		A		D		A		D	
CIRCUITS ↓	A	D	A	D	A	D	A	D	A	D	A	D	A	D	A	D	A	D	A	D	A	D		
7	151660745	151660744	151660747	151660746	151660749	151660748	151660751	151660750	151660753	151660752	151660755	151660754	151660757	151660756	151660759	151660758	151660761	151660760	151660763	151660762	151660765	151660764		
9	151660767	151660766	151660769	151660768	151660771	151660770	151660773	151660772	151660775	151660774	151660777	151660776	151660779	151660778	151660781	151660780	151660783	151660782	151660785	151660784	151660787	151660786		
11	151660789	151660788	151660791	151660790	151660793	151660792	151660795	151660794	151660797	151660796	151660799	151660798	151660801	151660800	151660803	151660802	151660805	151660804	151660807	151660806	151660809	151660808		
13	151660811	151660810	151660813	151660812	151660815	151660814	151660817	151660816	151660819	151660818	151660821	151660820	151660823	151660822	151660825	151660824	151660827	151660826	151660829	151660828	151660831	151660830		
15	151660833	151660832	151660835	151660834	151660837	151660836	151660839	151660838	151660841	151660840	151660843	151660842	151660845	151660844	151660847	151660846	151660849	151660848	151660851	151660850	151660853	151660852		
17	151660855	151660854	151660857	151660856	151660859	151660858	151660861	151660860	151660863	151660862	151660865	151660864	151660867	151660866	151660869	151660868	151660871	151660870	151660873	151660872	151660875	151660874		
19	151660877	151660876	151660879	151660878	151660881	151660880	151660883	151660882	151660885	151660884	151660887	151660886	151660889	151660888	151660891	151660890	151660893	151660892	151660895	151660894	151660897	151660896		
21	151660899	151660898	151660901	151660900	151660903	151660902	151660905	151660904	151660907	151660906	151660909	151660908	151660911	151660910	151660913	151660912	151660915	151660914	151660917	151660916	151660919	151660918		
23	151660921	151660920	151660923	151660922	151660925	151660924	151660927	151660926	151660929	151660928	151660931	151660930	151660933	151660932	151660935	151660934	151660937	151660936	151660939	151660938	151660941	151660940		
25	151660943	151660942	151660945	151660944	151660947	151660946	151660949	151660948	151660951	151660950	151660953	151660952	151660955	151660954	151660957	151660956	151660959	151660958	151660961	151660960	151660963	151660962		
27	151660965	151660964	151660967	151660966	151660969	151660968	151660971	151660970	151660973	151660972	151660975	151660974	151660977	151660976	151660979	151660978	151660981	151660980	151660983	151660982	151660985	151660984		
29	151660987	151660986	151660989	151660988	151660991	151660990	151660993	151660992	151660995	151660994	151660997	151660996	151660999	151660998	151661001	151661000	151661003	151661002	151661005	151661004	151661007	151661006		
31	151661009	151661008	151661011	151661010	151661013	151661012	151661015	151661014	151661017	151661016	151661019	151661018	151661021	151661020	151661023	151661022	151661025	151661024	151661027	151661026	151661029	151661028		
33	151661031	151661030	151661033	151661032	151661035	151661034	151661037	151661036	151661039	151661038	151661041	151661040	151661043	151661042	151661045	151661044	151661047	151661046	151661049	151661048	151661051	151661050		
35	151661053	151661052	151661055	151661054	151661057	151661056	151661059	151661058	151661061	151661060	151661063	151661062	151661065	151661064	151661067	151661066	151661069	151661068	151661071	151661070	151661073	151661072		
37	151661075	151661074	151661077	151661076	151661079	151661078	151661081	151661080	982331083	151661082	151661085	151661084	151661087	151661086	151661089	151661088	151661091	151661090	151661093	151661092	151661095	151661094		
39	151661097	151661096	151661099	151661098	151661101	151661100	151661103	151661102	151661105	151661104	151661107	151661106	151661109	151661108	151661111	151661110	151661113	151661112	151661115	151661114	151661117	151661116		
41	151661119	151661118	151661121	151661120	151661123	151661122	151661125	151661124	151661127	151661126	151661129	151661128	151661131	151661130	151661133	151661132	151661135	151661134	151661137	151661136	151661139	151661138		
43	151661141	151661140	151661143	151661142	151661145	151661144	151661147	151661146	151661149	151661148	151661151	151661150	151661153	151661152	151661155	151661154	151661157	151661156	151661159	151661158	151661161	151661160		
45	151661163	151661162	151661165	151661164	151661167	151661166	151661169	151661168	151661171	151661170	151661173	151661172	151661175	151661174	151661177	151661176	151661179	151661178	151661181	151661180	151661183	151661182		
47	151661185	151661184	151661187	151661186	151661189	151661188	151661191	151661190	151661193	151661192	151661195	151661194	151661197	151661196	151661199	151661198	15166201	15166200	15166203	15166202	15166205	15166204		
49	151661207	151661206	151661209	151661208	151661211	151661210	151661213	151661212	151661215	151661214	151661217	151661216	151661219	151661218	151661221	151661220	151661223	151661222	151661225	151661224	151661227	151661226		

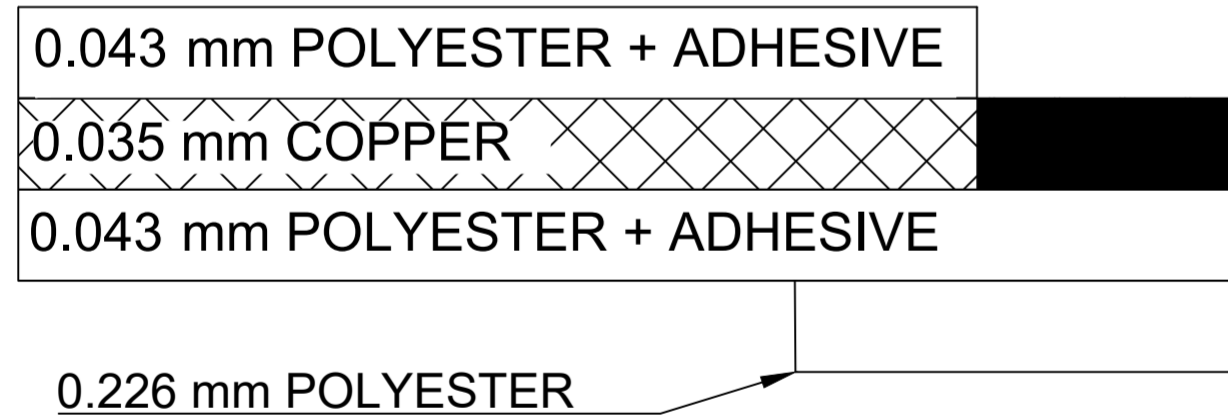

CROSS-SECTION

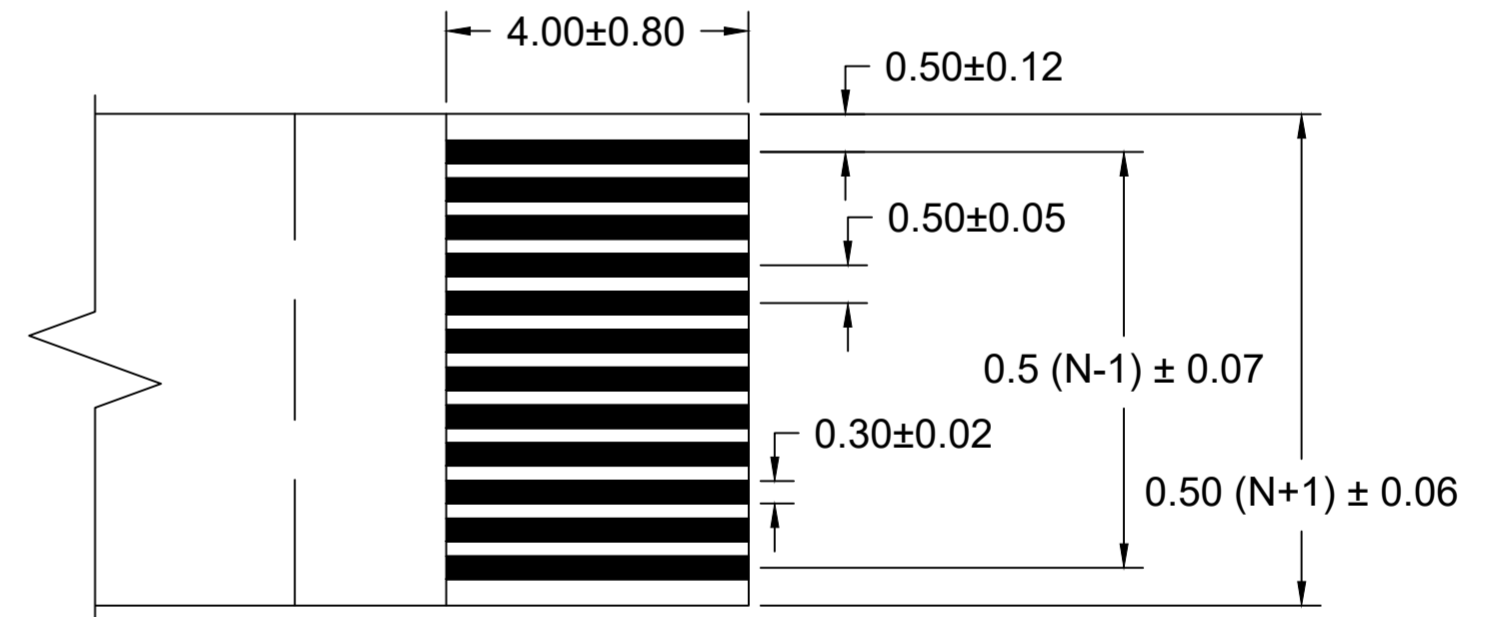

END TAIL DETAIL
SCALE 10:1

NOTES:

- NO PRINTING ON JUMPER CABLE UNLESS OTHERWISE SPECIFIED. IF PRINTING IS REQUIRED, THEN IT WOULD BE CONSIDERED A SPECIAL JUMPER CABLE.

THIS DRAWING CONTAINS INFORMATION THAT IS PROPRIETARY TO MOLEX ELECTRONIC TECHNOLOGIES, LLC AND SHOULD NOT BE USED WITHOUT WRITTEN PERMISSION

DIMENSION UNITS		SCALE		CURRENT REV DESC: DRAWING CORRECTION											
MM		NA													
GENERAL TOLERANCES (UNLESS SPECIFIED)						EC NO: 728054		0.50MM CENTER FLAT FLEX CABLE (FFC) (EXTRA FLEXIBLE, 105°C, SN PLATED) SALES DRAWING							
		mm	INCH												
4 PLACES	±----	±----	±----	DRWN: DIEGOG7		2022/11/10		PRODUCT CUSTOMER DRAWING							
3 PLACES	±----	±----	±----	CHK'D: JSMITH11		2022/11/14									
2 PLACES	±----	±----	±----	APPR: JSMITH11		2022/11/14		DOCUMENT NUMBER SD-15166-001							
1 PLACE	±----	±----	±----	INITIAL REVISION:											
0 PLACES	±----	±----	±----	DRWN: JLWOLFSB		2011/10/27		DOC TYPE		DOC PART		REVISION			
ANGULAR TOL ± 0.5 °			APPR: SFULTON		2011/11/03		PSD		001		B				
DRAFT WHERE APPLICABLE MUST REMAIN WITHIN DIMENSIONS				THIRD ANGLE PROJECTION		DRAWING		SERIES		MATERIAL NUMBER		CUSTOMER		SHEET NUMBER	
						C-SIZE		15166		SEE CHART		GENERAL MARKET		2 OF 2	