

DRAWING REVISIONS (RELEASE DATE ON FILE)			
REV	DOCUMENT	APP	APPROVAL DATE
D	PER CO # 851	V.R.	02/09/10

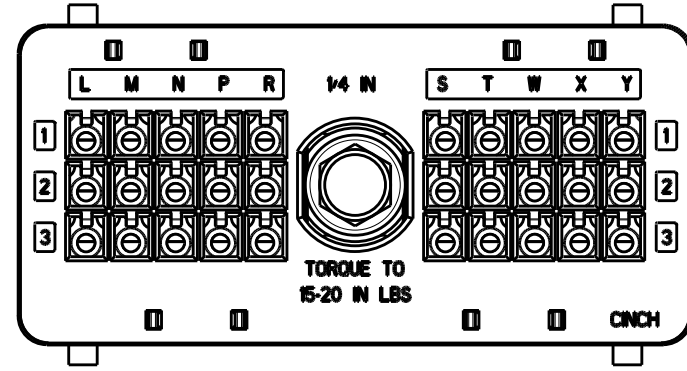
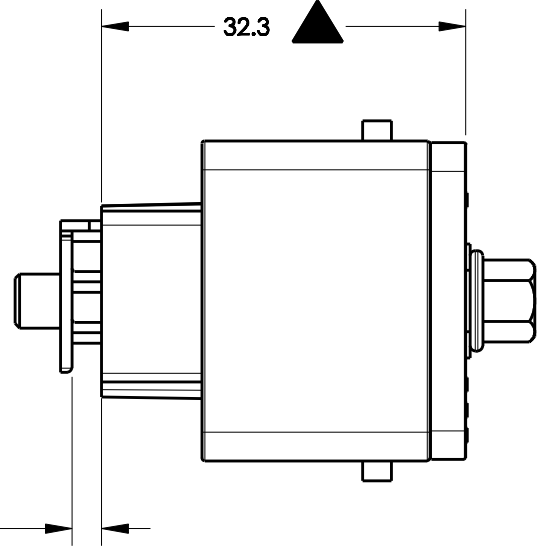
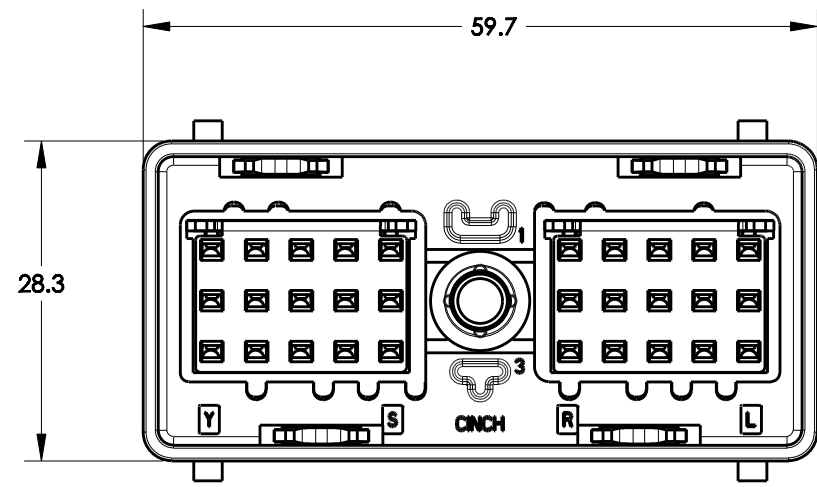

REAR VIEW

2.6REF  
SECONDARY LOCK SHIPPED  
IN PRE-STAGED POSITION

INSULATOR COLOR: WHITE  
(POLYIMIDE BASED  
ALLOY GLASS-FILLED)

DATE CODE

BACK PLATE  
COLOR: NATURAL (WHITE)  
(GLASS-FILLED POLYESTER)

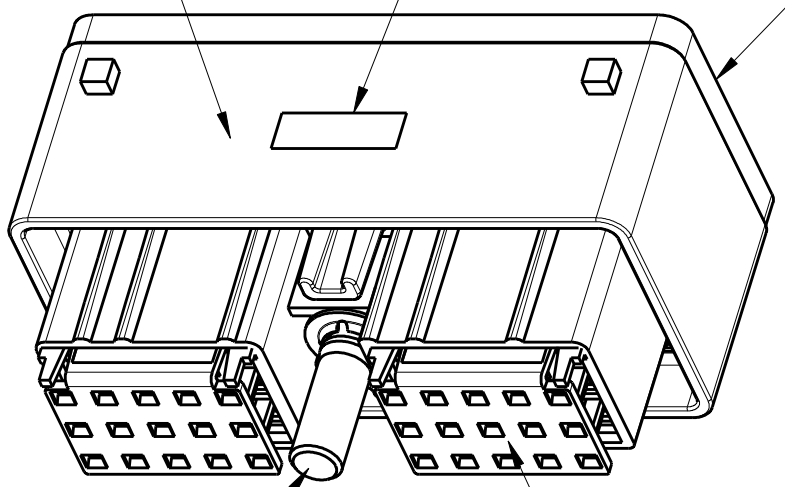

SECONDARY LOCK  
COLOR: WHITE  
(GLASS-FILLED POLYESTER)

JACKSCREW, STEEL  
10-24 UNC THREAD  
(YELLOW TRIVALENT CHROMATE)

NOTES:

1. ALL DIMENSIONS ARE IN MILLIMETERS. DIMENSIONS IN [ ] ARE IN INCHES.
2. FOR WIRE SIZE APPLICATION, CONSULT FACTORY.
3. FEMALE TERMINAL ORDERED SEPARATELY: 425 00 00 873/872.
4. MATES WITH CINCH HEADER CONNECTOR (CONSULT FACTORY).
5. SEAL PLUG ORDERED SEPARATELY: 581 00 00 011.
6. TOLERANCES UNLESS OTHERWISE SPECIFIED:  
.X ±0.5  
.XX ±0.25
7. SEALING RANGE FOR WIRE INSULATION DIA.:  
MAX 2.64MM (.104"), MIN 1.96MM (.077")
8. A TRIANGLE "▲" INDICATES CRITICAL FUNCTION DIMENSION.}
9. IF TIE-WRAP DRESSING CONDUCTORS, CINCH RECOMMENDS A SPACING OF NO LESS THAN 2 INCHES BEHIND THE BACK PLATE.

UNITS <b>METRIC</b>		DESIGN ENGINEER J. DRYE	DATE 08/20/02	<b>CINCH</b> 1700 FINLEY RD. LOMBARD, IL 60148	
DO NOT SCALE DRAWING		APPROVALS ON FILE		TITLE <b>CONNECTOR ASSEMBLY          SOCKET 30 POSITION</b>	
UNLESS OTHERWISE SPECIFIED: ALL DIMENSIONS ARE IN mm FILLET/RADII 0.50 MAX. TOLERANCES X ± 0.3 XX ± 0.13 XXX ± 0.025 ANGULAR ± 0.5°		MATERIAL SEE VIEW MATERIAL SPEC NUMBER - FINISH - CONTROL SPEC NUMBER POLAR E PROJECT NUMBER A14454		CAD FILE NUMBER 5810130031S CAGE IDENT NO. 71785	
CONFIDENTIAL THIS DOCUMENT IS THE PROPERTY OF CINCH. NEITHER THIS DOCUMENT NOR ANY OF THE INFORMATION CONTAINED IN IT MAY BE DUPLICATED OR DISCLOSED WITHOUT PRIOR WRITTEN CONSENT OF CINCH. ©COPYRIGHT 2010 CINCH		DRAWING NUMBER <b>5810130031S</b>		SCALE 3:2 SHEET 1 OF 1	