

# EEV476M6R3A9BAA

EEV, Aluminum Electrolytic, 47 uF, 20%, 6.3 VDC, -55/+105°C

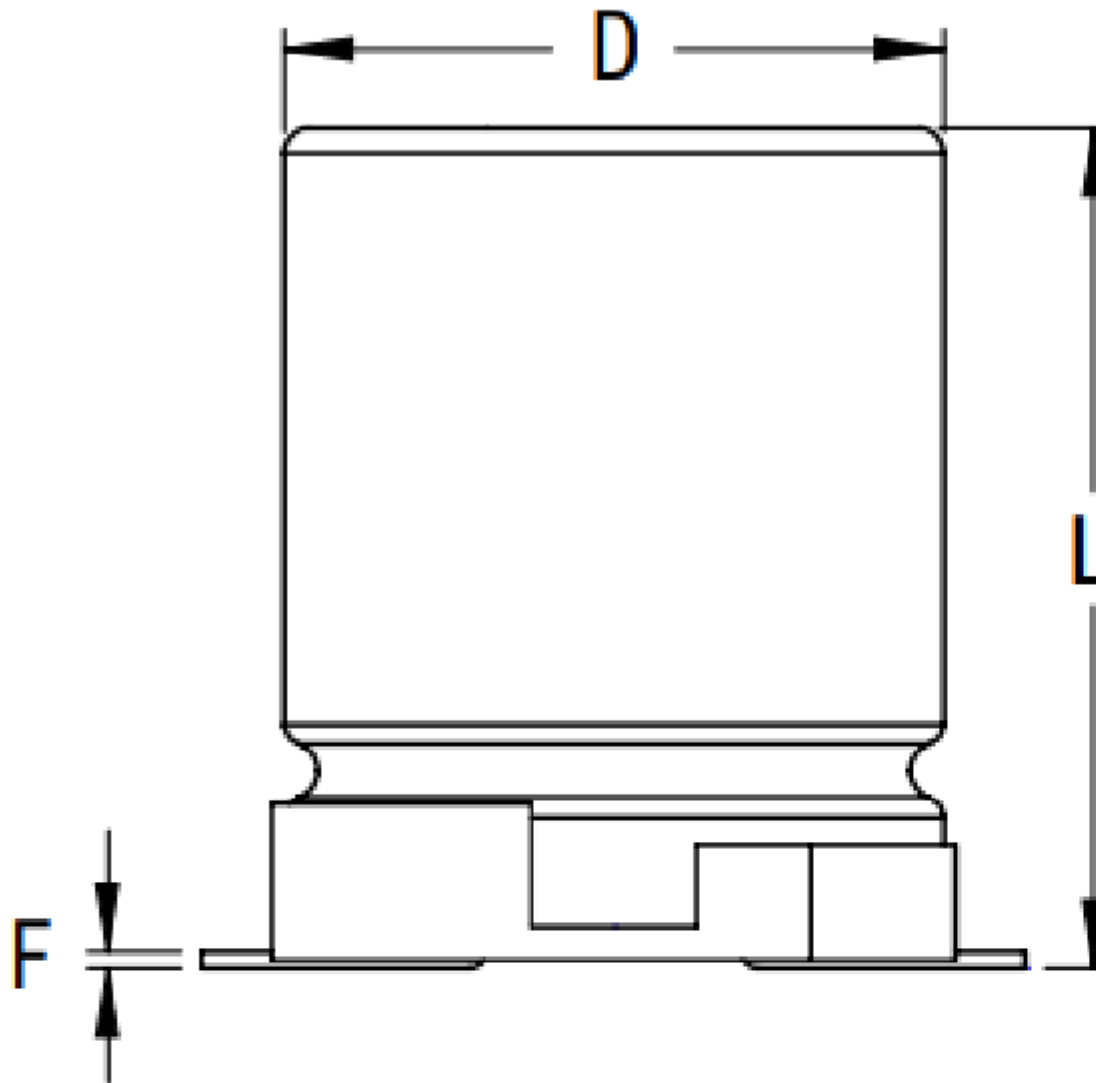

Click [here](#) for the 3D model.

### Dimensions

D 4mm +/-0.5mm  
L 5.4mm +0.25/-0.1mm  
W 0.65mm +/-0.1mm  
F 0.3mm MAX  
A 4.3mm +/-0.2mm  
B 4.3mm +/-0.2mm  
C 5.5mm MAX  
E 1.8mm +/-0.2mm  
G 0.35mm +0.15/-0.2mm  
P 1mm +/-0.2mm

### Packaging Specifications

Packaging T&R, 380mm  
Packaging Quantity 2000

### General Information

Series EEV  
Dielectric Aluminum Electrolytic  
Style SMD Can  
Description Surface Mount, Aluminum Electrolytic  
Features Ultra Low Impedance  
RoHS Yes  
Lead V-Chip  
AEC-Q200 No

### Specifications

Capacitance 47 uF  
Capacitance Tolerance 20%  
Voltage DC 6.3 VDC, 8 VDC (Surge)  
Temperature Range -55/+105°C  
Rated Temperature 105°C  
Life 2000 Hrs  
Dissipation Factor 26% 120Hz 20C  
Resistance 1.93 Ohms (100kHz 20C)  
Ripple Current 63 mAmps (120Hz 105C), 72 mAmps (1kHz), 90 mAmps (100kHz)  
Leakage Current 3 uA (2min 20°C)  
Impedance Ratio at -25C 2  
Impedance Ratio at -40C 3  
High Temperature Solder Yes

Statements of suitability for certain applications are based on our knowledge of typical operating conditions for such applications, but are not intended to constitute - and we specifically disclaim - any warranty concerning suitability for a specific customer application or use. This Information is intended for use only by customers who have the requisite experience and capability to determine the correct products for their application. Any technical advice inferred from this Information or otherwise provided by us with reference

to the use of our products is given gratis, and we assume no obligation or liability for the advice given or results obtained.

Generated 5/18/2023 - 2bff3b82-34de-4318-8669-03e0fe37b8d9

© 2006 - 2023 KEMET

Generated 5/18/2023 - 2bff3b82-34de-4318-8669-03e0fe37b8d9

© 2006 - 2023 KEMET