

MPLC1040L1R5

Aliases (UPID1040L1R500)

Not for New Design

KEMET, MPLC, Power, 1.5 uH, 20%, 4539

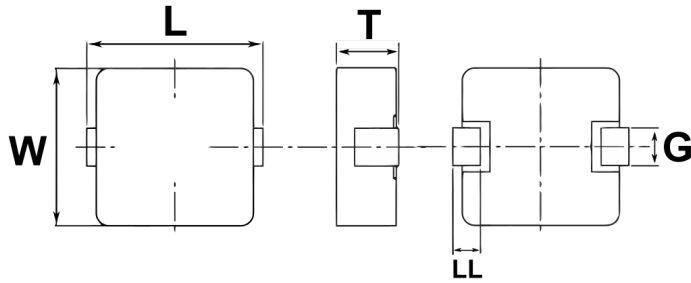

Click [here](#) for the 3D model.

Dimensions

L	11.5mm MAX
W	10mm +/-0.2mm
T	4mm MAX
LL	2.1mm NOM
G	4mm +/-0.1mm

Packaging Specifications

Packaging	T&R, 330mm
Packaging Quantity	500

General Information

Series	MPLC
Style	SMD
Chip Size	4539
Description	Shielded, Surface Mount Inductor
Features	Large Current Inductors
RoHS	Yes
Core	Composite

Specifications

Inductance	1.5 uH
Inductance Tolerance	20%
Temperature Range	-40/+125°C
Shielded	Yes
Current	12.7 Amps (Isat, 20% Drop In Inductance), 12.4 Amps (Irms, 40C Rise By Self Heating)
DC Resistance	7 mOhms